

Great Basin Water Co.
1240 E. State St., Ste. 115
Pahrump, NV 89048

ORIGINAL PUCN Sheet No. 135
Cancels
PUCN Sheet No. ____

Tariff No. 1-W (Water)

RULE NO. 17 (Continued)
LEGAL DESCRIPTION
CERTIFICATED AREA FOR COLD SPRINGS

PARCEL No. 14, COLD SPRINGS 2000

A parcel of land situate in the North Half of Section 15, Township 21 North, Range 18 East, M.D.M. and being a portion of Parcel 4 of Land Map 129 more particularly described as follows:

Beginning at the Easterly Comer of Parcel 5A of the Utilities, Inc. of Nevada Service Territory from which the Northwest Corner of said Section bears North 65° 47' 39" West a distance of 2512.36 feet;

Thence departing said Parcel 5A Boundary South 36° 55' 56" East a distance of 258.50 feet;

Thence South 63° 44' 41" East a distance of 279.84 feet;

Thence South 07° 04' 20" West a distance of 168.54 feet;

Thence South 47° 08' 08" West a distance of 40.47 feet;

Thence South 71° 36' 08" West a distance of 52.14 feet;

Thence South 02° 02' 47" West a distance of 74.26 feet;

Thence North 88° 09' 37" West a distance of 119.57 feet;

Thence South 47° 18' 36" West a distance of 158.51 feet;

Thence South 20° 00' 11" West a distance of 42.56 feet;

Thence South 42° 59' 35" West a distance of 27.40 feet;

Thence South 20° 38' 31" West a distance of 162.86 feet;

Thence North 59° 17' 14" West a distance of 88.19 feet;

Issued:
Effective:
Advice No.:

Issued by:
Wendy Barnett, President
Great Basin Water Co.

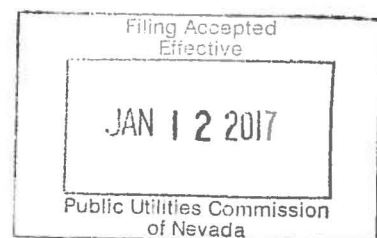

Great Basin Water Co.
1240 E. State St., Ste. 115
Pahrump, NV 89048

ORIGINAL PUCN Sheet No. 136
Cancels
PUCN Sheet No. ____

Tariff No. 1-W (Water)

RULE NO. 17 (Continued)
LEGAL DESCRIPTION
CERTIFICATED AREA FOR COLD SPRINGS

PARCEL No. 14, COLD SPRINGS 2000 (Continued)

Thence North 78° 22' 14" West a distance of 217.18 feet;

Thence South 78° 04' 36" West a distance of 236.52 feet;

Thence South 70° 59' 20" West a distance of 198.62 feet to the Easterly Boundary of said Parcel 5A;

Thence with said Boundary North 00° 00' 43" West a distance of 153.31 feet;

Thence North 44° 59' 17" East a distance of 1300.00 feet to the Point of Beginning.

Said parcel contains an area of approximately 15.466 acres.

Basis of Bearings: Land Map 129, File Number 1420642, Official Records of Washoe County, Nevada.

TRANSMISSION LINE EASEMENT

The following describes a parcel of land to be used as a water transmission line easement located within a portion of the NW 1/4 of Section 22, T21N, R18E, M.D.B.&M.; Washoe County, Nevada, being twenty feet (20') in width, ten feet (10') on either side of the following described centerline:

Commencing at the NW corner of said Section 22 and proceeding along the west line of said Section S 1° 05' 21" W 10.00 feet to the TRUE POINT OF BEGINNING

Thence S 28° 57' 37" E 1706.00 feet to the point of ending for this description.

Issued:
Effective:
Advice No.:

Issued by:
Wendy Barnett, President
Great Basin Water Co.

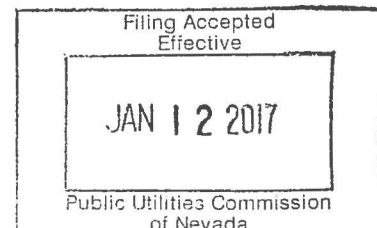

Great Basin Water Co.
1240 E. State St., Ste. 115
Pahrump, NV 89048

ORIGINAL PUCN Sheet No. 137
Cancels
PUCN Sheet No. ____

Tariff No. 1-W (Water)

RULE NO. 17 (Continued)
LEGAL DESCRIPTION
CERTIFICATED AREA FOR COLD SPRINGS

RESERVOIR SITE

The following describes a parcel of land located within the NW 1/4 of Section 22, T21N, R18E, M.D.B.&M., Washoe County, Nevada and being more particularly described as follows:

Commencing at the corner common to Sections 15, 16, 21 and 22

Thence S 1° 05' 21" W 10.00 feet to a point on the west line of Section 21

Thence S 28° 57' 37" E 1706.00 feet to the TRUE POINT OF BEGINNING

Thence N 61° 02' 23" E 75.00 feet

Thence S 23° 57' 37" E 200.00 feet

Thence S 61° 02' 23" W 150.00 feet

Thence N 28° 57' 37" W 200.00 feet

Thence N 61° 02' 23" W 75.00 feet to the TRUE POINT OF BEGINNING

TANK SITE

The following describes a parcel of land situated within a portion of the SW 1/4, SW 1/4 of Section 29, T21N, R18E, M.D.B.&M., Washoe County, Nevada and is more particularly described as follows:

Commencing at the corner common to Sections 29, 30, 31 and 32, T21N, R18E, M.D.B. &M.

Thence proceeding easterly along a fence line 85.27 feet to the TRUE POINT OF BEGINNING

Thence northerly at right angles to said line, 200 feet

Thence easterly at right angles to the preceding line, 200 feet

Issued:
Effective:
Advice No.:

Issued by:
Wendy Barnett, President
Great Basin Water Co.

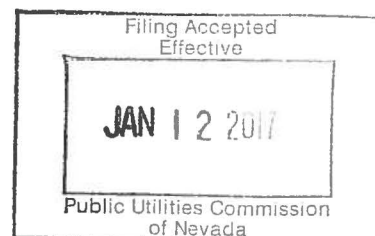

Great Basin Water Co.
1240 E. State St., Ste. 115
Pahrump, NV 89048

ORIGINAL PUCN Sheet No. 138
Cancels
PUCN Sheet No. ____

Tariff No. 1-W (Water)

RULE NO. 17 (Continued)
LEGAL DESCRIPTION
CERTIFICATED AREA FOR COLD SPRINGS

TANK SITE (Continued)

Thence southerly at right angles to the preceding line, 200 feet to a fence line

Thence westerly along said line 200 feet to the true point of beginning
Together with a right of access thereto, over and across the lands of the grantor.

BASIS OF BEARINGS: Amended Northridge Subdivision. Doc. No. 264116, filed
August 27, 1956

WATER LINE FOR TRANSMISSION

The following describes a waterline for transmission purposes only, situated within
portions of Sections 20, 21, 29 and 30, T21N, R18E, M.D.B.&M., Washoe County,
Nevada and is described as follows:

Commencing at the corner common to Sections 29, 30, 31 and 32 of said township and
range

Thence proceeding easterly along a fence line 85.27 feet

Thence northerly at right angles to said line 200 feet

Thence easterly at right angles to the preceding line, 74.5 feet, more or less to the TRUE
POINT OF BEGINNING

Thence northwesterly 773.5 feet, more or less to an angle point

Thence northeasterly 13.5 feet to a line running parallel to and lying 110 feet
southwesterly of the centerline of the existing track of Western Pacific Railroad

Thence northwesterly, northeasterly and northerly along a line running parallel to and
concentric with and lying 110 feet westerly of the centerline of the existing track of
Western Pacific Railroad, the following courses and distances:

Issued:
Effective:
Advice No.:

Issued by:
Wendy Barnett, President
Great Basin Water Co.

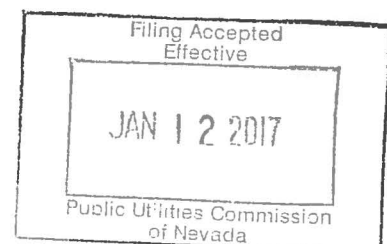

Great Basin Water Co.
1240 E. State St., Ste. 115
Pahrump, NV 89048

ORIGINAL PUCN Sheet No. 139
Cancels
PUCN Sheet No. ____

Tariff No. 1-W (Water)

RULE NO. 17 (Continued)
LEGAL DESCRIPTION
CERTIFICATED AREA FOR COLD SPRINGS

WATER LINE FOR TRANSMISSION (Continued)

Along a curve to the right concave northeasterly, 900 feet more or less

Northeasterly 550 feet

Northerly along a curve to the left concave

Westerly 330 feet

Northwesterly 600 feet

Thence proceeding easterly at right angles to the existing railroad track, 220 feet to the easterly right-of-way line of Western Pacific Railroad right-of-way

Thence S 89° 54' 56" E 238 feet, more or less to a line running parallel to and lying 24 feet westerly of the centerline of the proposed Reno Park Boulevard west of U.S. Highway 395

Thence along said line N 00° 10' 27" W 1534 feet to the beginning of a tangent curve to the right

Thence 85 feet, more or less. along said curve having a radius of 324 feet through a central angle of 07° 32' 15"

Thence proceeding northeasterly across the centerline of said boulevard 70 feet, more or less to the beginning of a curve to the left

Thence 200 feet, more or less along said curve having a radius of 324 feet through a central angle of 35° 22' 00".

Thence N 00° 21' 37" W 420 feet more or less to the beginning of a tangent curve to the right

Thence 88.49 feet along said curve through a central angle of 40° 14' 26" having a radius of 126 feet

Issued:
Effective:
Advice No.:

Issued by:
Wendy Barnett, President
Great Basin Water Co.

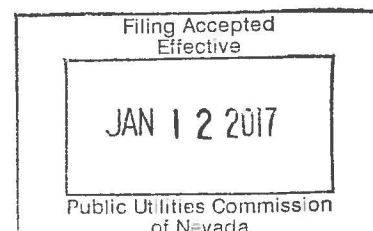

Great Basin Water Co.
1240 E. State St., Ste. 115
Pahrump, NV 89048

ORIGINAL PUCN Sheet No. 140
Cancels
PUCN Sheet No. ____

Tariff No. 1-W (Water)

RULE NO. 17 (Continued)
LEGAL DESCRIPTION
CERTIFICATED AREA FOR COLD SPRINGS

WATER LINE FOR TRANSMISSION (Continued)

Thence N 39° 52' 49" E 170 feet, more or less to a point inside a Frontage Road right-of-way, said point being 24 feet, more or less westerly of the non-access westerly right-of-way line of U.S. Highway 395

Thence southeasterly along said Frontage Road 1050 feet, more or less to a point 6 feet southwesterly of the non-access westerly right-of-way line of U.S. Highway 395

Thence S 31° 49' 07" E 795 feet, more or less to a point 285 feet southwesterly of centerline Station "AN" 480 + 25 ± of U.S. Highway 395

Thence northeasterly 485 feet, more or less to the easterly right-of-way line of said Highway

Thence continuing northeasterly 1350 feet, more or less to a point 10 feet east of the S 1/4 corner of Section 20, T21N, R18E, M.D. B. & M.

Thence northerly along a line 10 feet east of the north-south centerline thereof, 2500 feet, more or less to a point 5 feet southerly of the southeasterly right-of-way line of Reno Park Boulevard

Thence northeasterly and southeasterly along a line running parallel to and concentric with and lying 5 feet southerly of the southerly right-of-way line of said boulevard, the following courses and distances:

109 feet, more or less along a tangent curve to the left through a central angle of 12° 01' 23", having a radius of 545 feet

N 59° 34' 53" E 588.50 feet to the beginning of a tangent curve to the right

Thence 10.59 feet along said curve through a central angle of 01° 20' 00" having a radius of 45 feet

Issued:
Effective:
Advice No.:

Issued by:
Wendy Barnett, President
Great Basin Water Co.

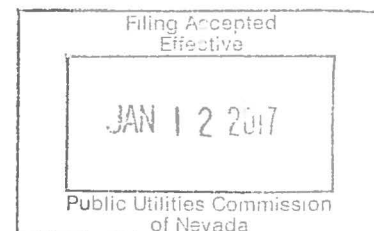

Great Basin Water Co.
1240 E. State St., Ste. 115
Pahrump, NV 89048

ORIGINAL PUCN Sheet No. 141
Cancels
PUCN Sheet No. ____

Tariff No. 1-W (Water)

RULE NO. 17 (Continued)
LEGAL DESCRIPTION
CERTIFICATED AREA FOR COLD SPRINGS

WATER LINE FOR TRANSMISSION (Continued)

N 60° 54' 53" E 897.63 feet to the beginning of a tangent curve to the right

Thence 6.60 feet along said curve through a central angle of 00° 42' 24", having a radius of 535 feet

N 60° 12' 29" E 697.05 feet to the beginning of a tangent curve to the right

Thence 117.76 a feet along said curve through a central angle of 14° 49' 45", having a radius of 455 feet

N 75° 92' 14" E 611.98 feet to the beginning of a tangent curve to the right

Thence 641.97 feet along said curve through a central angle of 31° 50' 46" having a radius of 1155 feet

S 73° 07' 00" E 1035.91 feet to the beginning of a tangent curve to the right

Thence 225.42 feet along said curve through a central angle of 08° 18' 21" having a radius of 1555 feet to the west line of the property of John and Virgil Arden, the true point of ending of this description.

BASIS OF BEARINGS: Amended Northridge Subdivision Doc. No. 264116,
Filed August 27, 1956.

Issued:
Effective:
Advice No.:

Issued by:
Wendy Barnett, President
Great Basin Water Co.

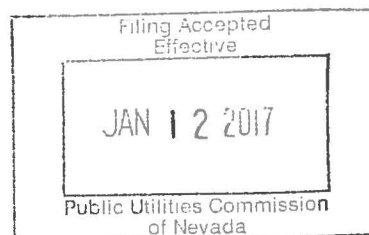

Great Basin Water Co.
1240 E. State St., Ste. 115
Pahrump, NV 89048

ORIGINAL PUCN Sheet No. 142
Cancels
PUCN Sheet No. ____

Tariff No. 1-W (Water)

RULE NO. 17 (Continued)
LEGAL DESCRIPTION
CERTIFICATED AREA FOR COLD SPRINGS

WELL SITE
No.1

The following describes a parcel of land situated within a portion of the NW 1/4, NW 1/4, of Section 21, T2IN, R18E, M.D.B.&M., Washoe County, Nevada, and is more particularly described as follows

Commencing at the northwest corner of said Section 21

Thence proceeding along the west line thereof, S 00° 18' 11" W 510.00 feet to the southwesterly corner of Block F, Reno Park Mobile Home Estates Subdivision, Unit No. 1

Thence along the southwesterly boundary of said Block F, the following courses and distances:

s 89° 41' 49" E 275.00 feet

s 78° 07' 59" E 218.51 feet

s 55° 00' 16" E 218.51 feet

s 38° 54' 57" E 116.44 feet

s 37° 30' 00" E 370.43 feet

s 60° 35' 00" E 207.50 feet to the TRUE POINT OF BEGINNING

Thence continuing along said boundary, S 60° 35' 00" E 25.00 feet

Thence S 29° 25' 00" W 25.00 feet

Thence N 60° 35' 00" W 25.00 feet

Thence N 29° 25' 00" E 25.00 feet to the true point of ending

Issued:
Effective:
Advice No.:

Issued by:
Wendy Barnett, President
Great Basin Water Co.

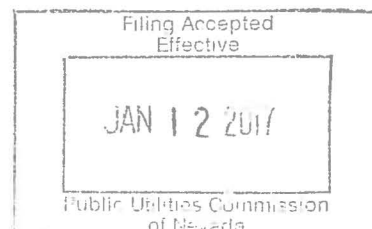

Great Basin Water Co.
1240 E. State St., Ste. 115
Pahrump, NV 89048

ORIGINAL PUCN Sheet No. 143
Cancels
PUCN Sheet No. ____

Tariff No. 1-W (Water)

RULE NO. 17 (Continued)
LEGAL DESCRIPTION
CERTIFICATED AREA FOR COLD SPRINGS

WELL SITE No.1 (Continued)

Together with a waterline easement 10 feet wide for transmission purposes only, the northerly line of which is described as follows:

Beginning at the northeasterly corner of the above describe parcel

Thence proceeding along the southerly line of Lot 16, in Block F, of Reno Park Mobile Home Estates Subdivision, Unit No. 1, S 60° 35' 00" E 115 feet, more or less to the west right-of-way line of Sandpiper Drive, the true point of ending

Also together with a right of access thereto, over and across the lands of the grantor.

WELL SITE No. 2

All that certain lot designated as "Well Site" as shown on the Official Amended Plat of Reno Park Mobile Home Estates, Unit No. 2A, Block K (Subdivision Tract Map No. 1520A) filed on May 21, 1975, in the Official Records of Washoe County, Nevada under File No. 364965.

WELL SITE No.3

All that certain lot designated as "Well Site" as shown on the Official Plat of Cold Springs Valley Homes Subdivision, Unit No.1, Block C (Subdivision Tract Map No. 1715-B) filed on February 2, 1978, in the Official Records of Washoe County, Nevada, under File No. 512218.

Issued:
Effective:
Advice No.:

Issued by:
Wendy Barnett, President
Great Basin Water Co.

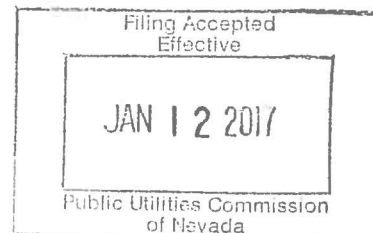

Great Basin Water Co.
1240 E. State St., Ste. 115
Pahrump, NV 89048

ORIGINAL PUCN Sheet No. 144
Cancels
PUCN Sheet No. ____

Tariff No. 1-W (Water)

RULE NO. 17 (Continued)
LEGAL DESCRIPTION
CERTIFICATED AREA FOR COLD SPRINGS

WELL SITE No.6 (Also Ref. as Well "B")

The following describes a parcel of land situated within Lot 11, Section 30 T21N, R18E M.D.B.&M., Washoe, County, Nevada and is more particularly described as follows:

Commencing at the northeast corner of said Section 30 and proceeding,
S 19° 05' 08" W 3015.93 feet to the TRUE POINT OF BEGINNING

Thence S 89°45'17" E 19.2 feet to a point 150 feet east of the California-Nevada state line

Thence southerly along a line running parallel to and 150 feet east of said state line, S 00°14' 43" W 50 feet

Thence N 89° 45' 17" W 50 feet

Thence northerly along said line N 00° 14' 43" E 50 feet

Thence S 89° 45' 17" E 30.8 feet to the true point of beginning

Together with an easement 10 feet wide for water transmission purposes only, situated within a portion of Lot 11, Section 30, T21N, R18E, M.D.B.&M., Washoe County, Nevada, being 5 feet on each side of the centerline of which is described as follows:

Commencing at the SW corner of the above described parcel thence N 89° 45' 17" W 5.00 feet to the true point of beginning

Thence N 00° 14' 43" E a distance of 235.69 feet

Thence proceeding S 89° 45' 19" E 586.15 feet to a point 110 feet westerly of the centerline of the existing track of Western Pacific Railroad, the true point of ending of this description

Also together with a right of access thereto, over and across the lands of the grantor.

BASIS OF BEARINGS: Amended Northridge subdivision Doc. No. 264116, Filed August 27, 1956

Issued:
Effective:
Advice No.:

Issued by:
Wendy Barnett, President
Great Basin Water Co.

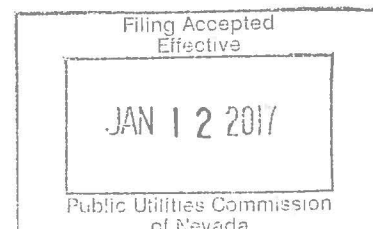

Great Basin Water Co.
1240 E. State St., Ste. 115
Pahrump, NV 89048

ORIGINAL PUCN Sheet No. 145
Cancels
PUCN Sheet No. ____

Tariff No. 1-W (Water)

RULE NO. 17 (Continued)
LEGAL DESCRIPTION
CERTIFICATED AREA FOR COLD SPRINGS

WELL SITE No.5

The following describes a parcel of land situated within. Portion of NW 1/4 SW 1/4 of Section 29, T21N, R18E M.D.B.&M., Washoe, County, Nevada and is described as follows:

Commencing at the northeast corner of said Section 290 and proceeding, S 01° 30' E 3255.00 feet to the TRUE POINT OF BEGINNING

Thence N 88°30' E 25 feet

Thence S 01°30' E 50 feet

Thence S 88°31' W 50 feet

Thence N 01°30' W 50 feet

Thence N 88° 30' E 25 feet to the true point of beginning

Together with an all-purpose easement thereto, over and across the lands of the grantor.

WELL SITE 8 (AKA SWEGER WELL SITE)

A parcel of land situated in Section 9, Township 21 North, Range 18 East, M.D.M. and being a portion of Parcel 2 of Land Map 129, File 1420642, Official Records, Washoe County, Nevada and being more particularly described as follows:

Beginning at a point from which the Southwest Corner of Section 9 bears South 64° 27' 02" West a distance of 2294.71 feet;

Thence North 22°40' 09" East a distance of 100.00 feet;

Thence South 67° 19' 51" East a distance of 100.00 feet;

Issued:
Effective:
Advice No.:

Issued by:
Wendy Barnett, President
Great Basin Water Co.

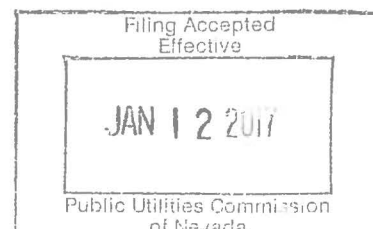

Great Basin Water Co.
1240 E. State St., Ste. 115
Pahrump, NV 89048

ORIGINAL PUCN Sheet No. 146
Cancels
PUCN Sheet No. ____

Tariff No. 1-W (Water)

RULE NO. 17 (Continued)
LEGAL DESCRIPTION
CERTIFICATED AREA FOR COLD SPRINGS

WELL SITE 8 (AKA SWEGER WELL SITE) (Continued)

Thence South 22° 40' 09" West a distance of 100.00 feet;

Thence North 67° 19' 51" West a distance of 100.00 feet to the Point of Beginning.

Said parcel contains an area of approximately 10000 square feet (0.23 acres)

BASIS OF BEARINGS: Land Map 129, File 1420642, Official Records, Washoe County, Nevada.

TANK SITE 3

All that certain real property situate in a portion of Section Fifteen (15), Township Twenty-One (21) North, Range Eighteen (18) East, Mount Diablo Meridian, Washoe County, Nevada, being described as follows:

Beginning at a point from which the Southwest corner of said Section 15 bears South 37° 11' 23" West a distance of 4258.39 feet;

Thence S 88° 57' 36" East a distance of 101.10 feet;

Thence S 01° 02' 24" West a distance of 208.71 feet;

Thence N 88° 57' 36" West a distance of 208.71 feet;

Thence N 01° 02' 24" East a distance of 208.71 feet;

Thence S 88° 57' 36" East a distance of 107.61 feet to the Point of Beginning.

Said parcel contains an area of approximately 1.000 acres.

Issued:
Effective:
Advice No.:

Issued by:
Wendy Barnett, President
Great Basin Water Co.

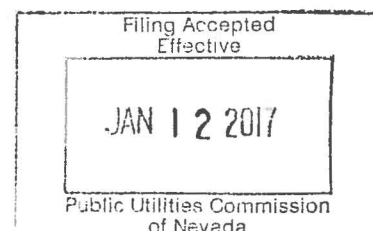

Great Basin Water Co.
1240 E. State St., Ste. 115
Pahrump, NV 89048

REVISED PUCN Sheet No. 147
Cancels
ORIGINAL PUCN Sheet No. 147

Tariff No. 1-W (Water)

RULE NO. 17
EXISTING CERTIFICATED SERVICE TERRITORY OF PAHRUMP

A. MAPS

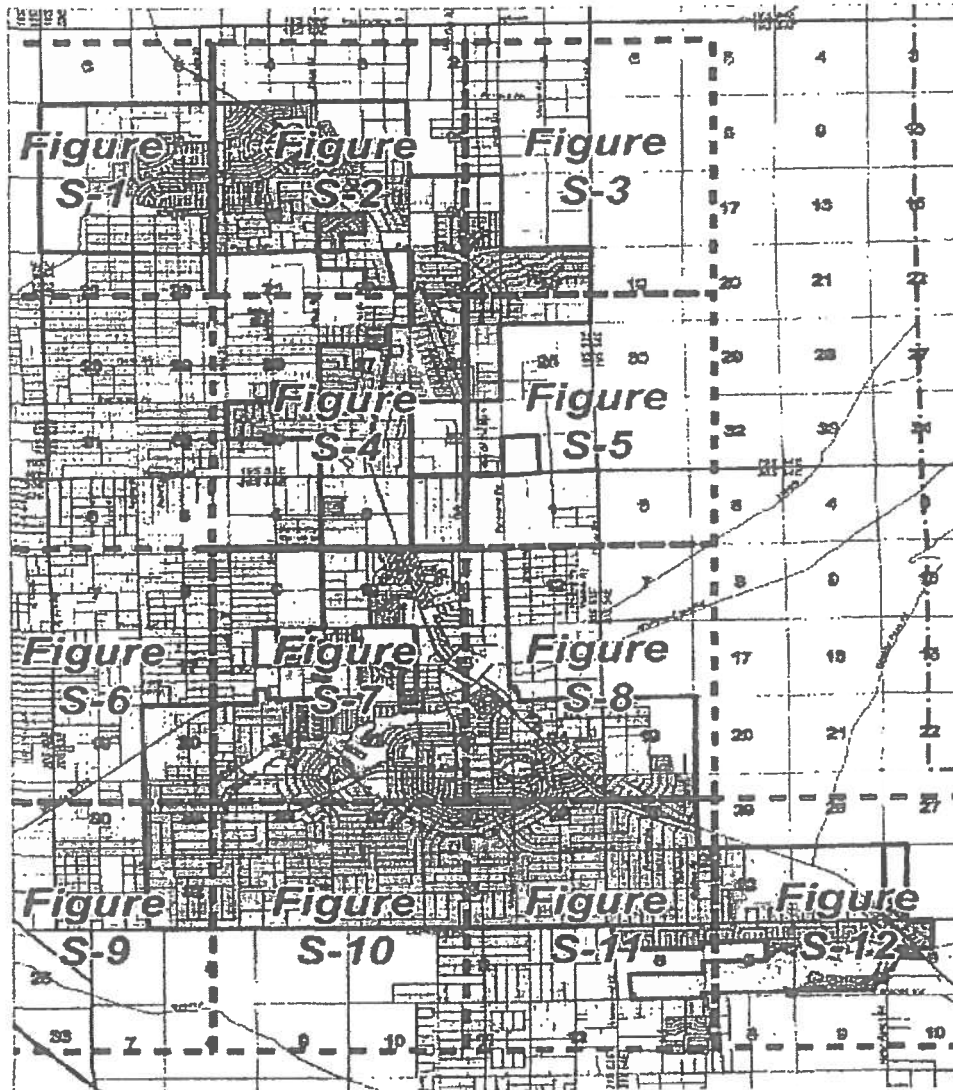

Issued:
Effective:
Advice No.:

Issued by:
Wendy Barnett, President
Great Basin Water Co.

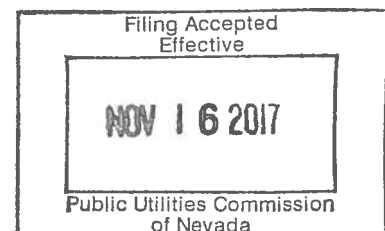

Great Basin Water Co.
1240 E. State St., Ste. 115
Pahrump, NV 89048

ORIGINAL PUCN Sheet No. 148
Cancels
PUCN Sheet No. ____

Tariff No. 1-W (Water)

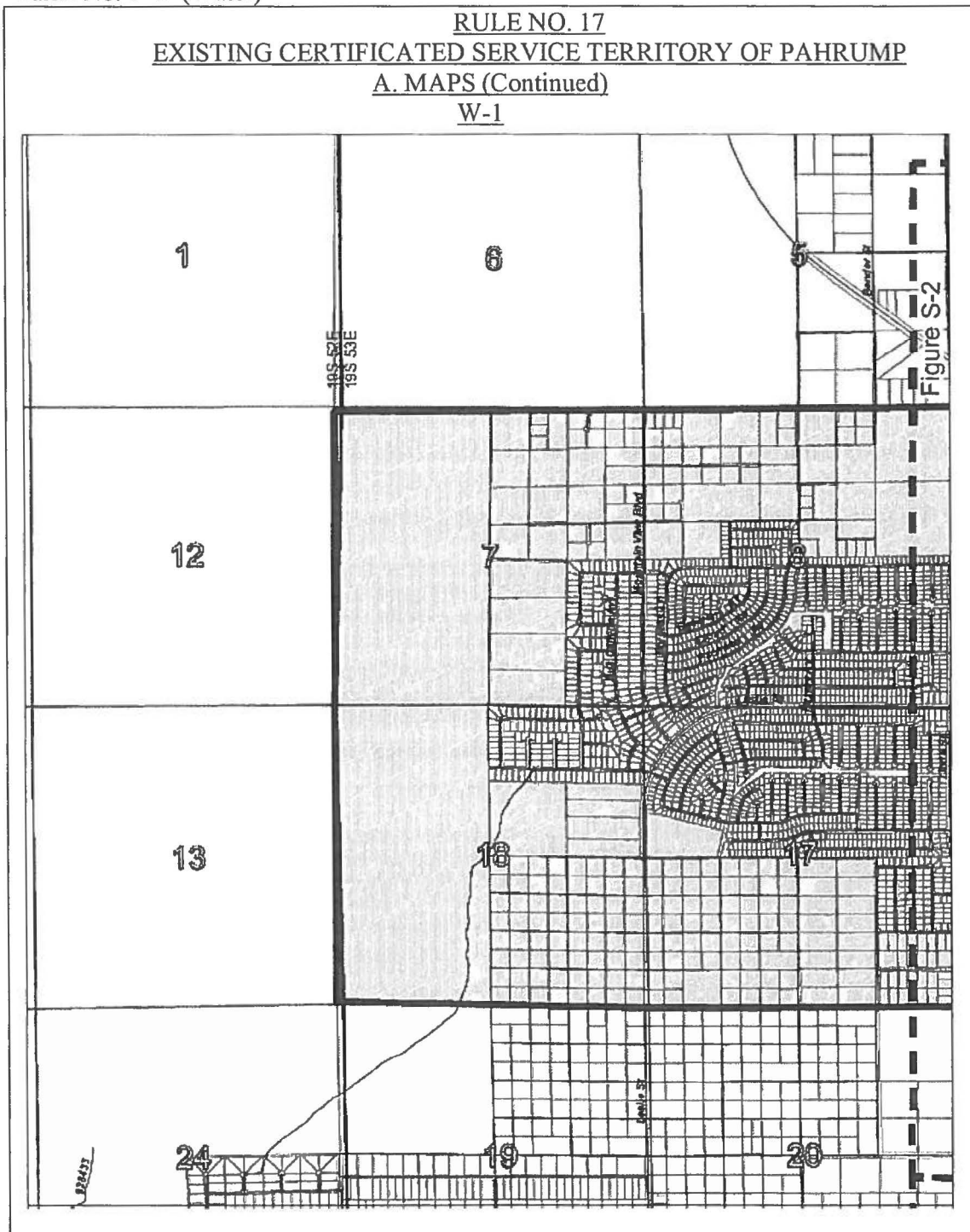

Issued:
Effective:
Advice No.:

Issued by:
Wendy Barnett, President
Great Basin Water Co.

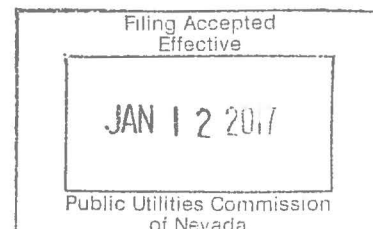

Great Basin Water Co.
1240 E. State St., Ste. 115
Pahrump, NV 89048

ORIGINAL PUCN Sheet No. 149
Cancels
PUCN Sheet No. ____

Tariff No. 1-W (Water)

RULE NO. 17
EXISTING CERTIFICATED SERVICE TERRITORY OF PAHRUMP
A. MAPS (Continued)
W-2

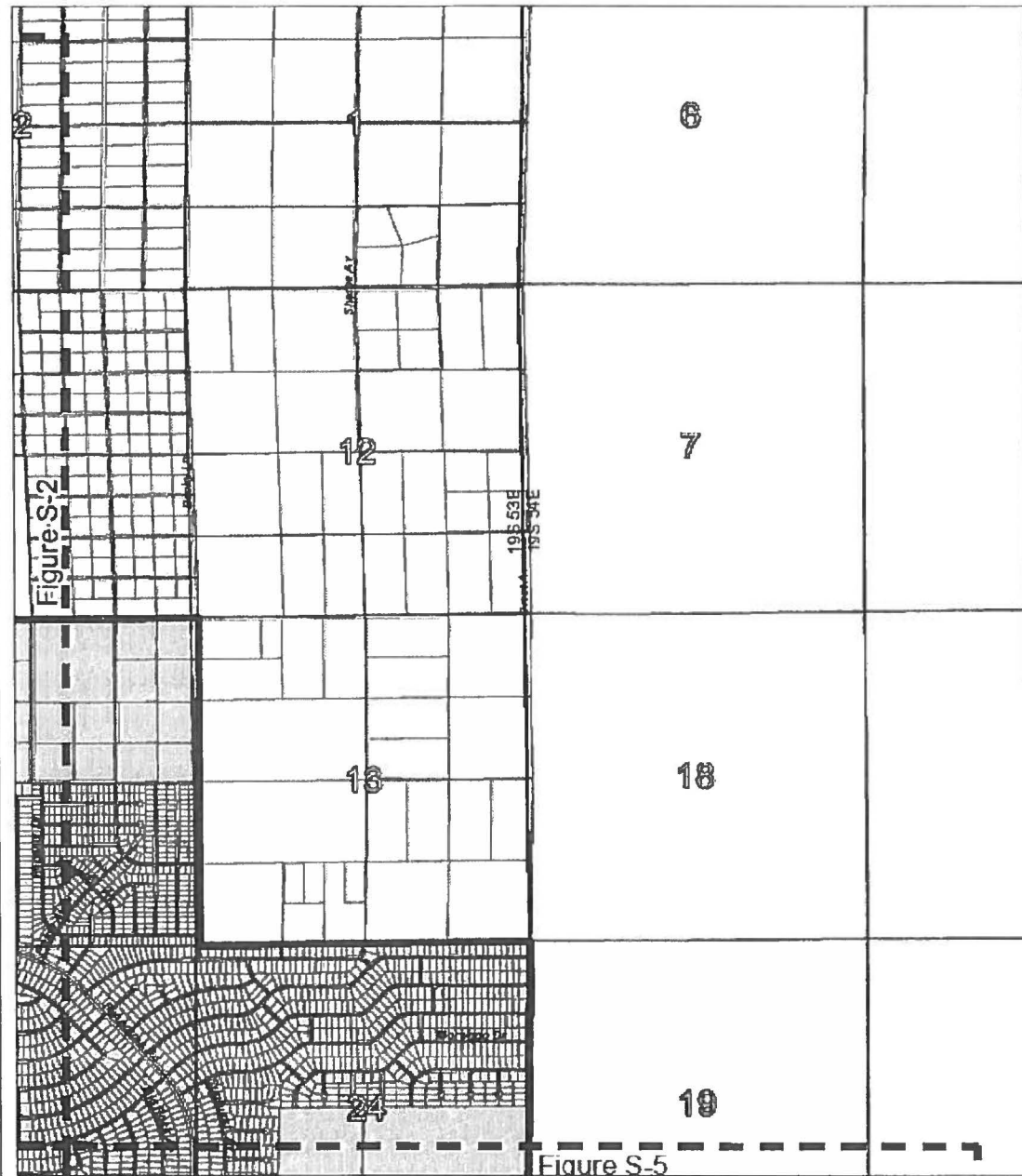

Issued:
Effective:
Advice No.:

Issued by:
Wendy Barnett, President
Great Basin Water Co.

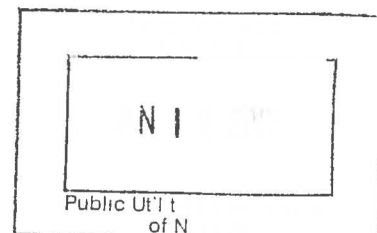

Great Basin Water Co.
1240 E. State St., Ste. 115
Pahrump, NV 89048

ORIGINAL PUCN Sheet No. 150
Cancels
PUCN Sheet No. ____

Tariff No. 1-W (Water)

RULE NO. 17
EXISTING CERTIFICATED SERVICE TERRITORY OF PAHRUMP
A. MAPS (Continued)
W-3

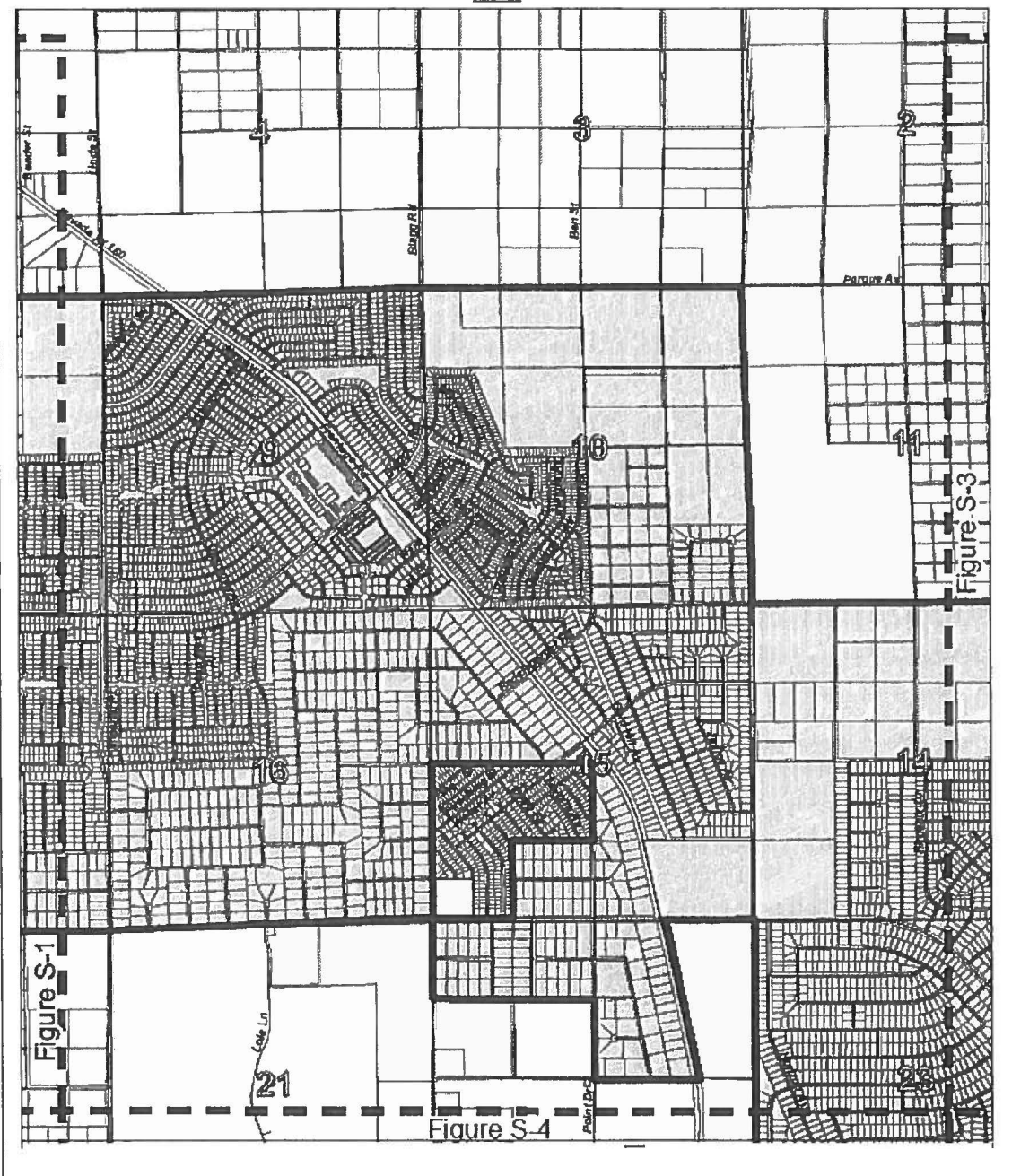

Issued:
Effective:
Advice No.:

Issued by:
Wendy Barnett, President
Great Basin Water Co.

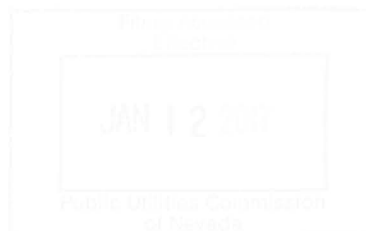

ORIGINAL PUCN Sheet No. 151
Cancels
PUCN Sheet No. _____

RULE NO. 17
EXISTING CERTIFICATED SERVICE TERRITORY OF PAHRUMP

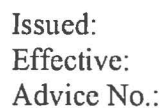
W-4

Issued by:
Wendy Barnett, President
Great Basin Water Co.

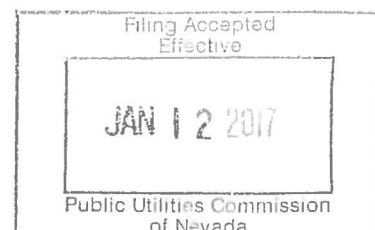

Great Basin Water Co.
1240 E. State St., Ste. 115
Pahrump, NV 89048

ORIGINAL PUCN Sheet No. 152
Cancels
PUCN Sheet No. _____

Tariff No. 1-W (Water)

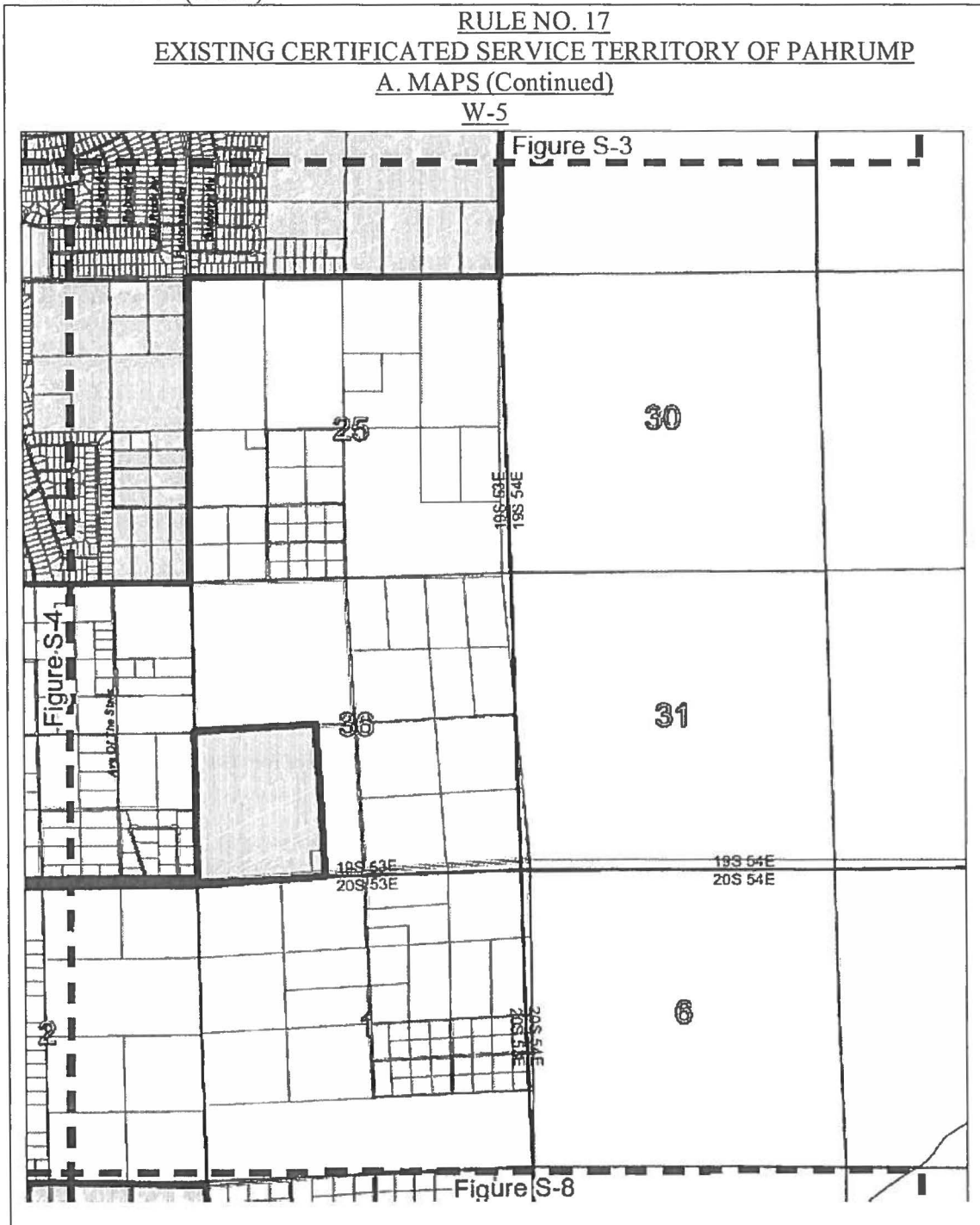

Issued:
Effective:
Advice No.:

Issued by:
Wendy Barnett, President
Great Basin Water Co.

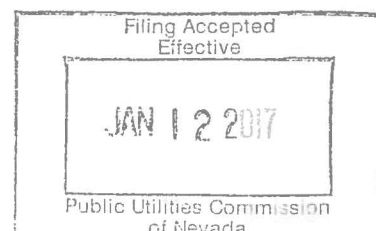

Great Basin Water Co.
1240 E. State St., Ste. 115
Pahrump, NV 89048

ORIGINAL PUCN Sheet No. 153
Cancels
PUCN Sheet No. ____

Tariff No. 1-W (Water)

RULE NO. 17
EXISTING CERTIFICATED SERVICE TERRITORY OF PAHRUMP
A. MAPS (Continued)
W-6

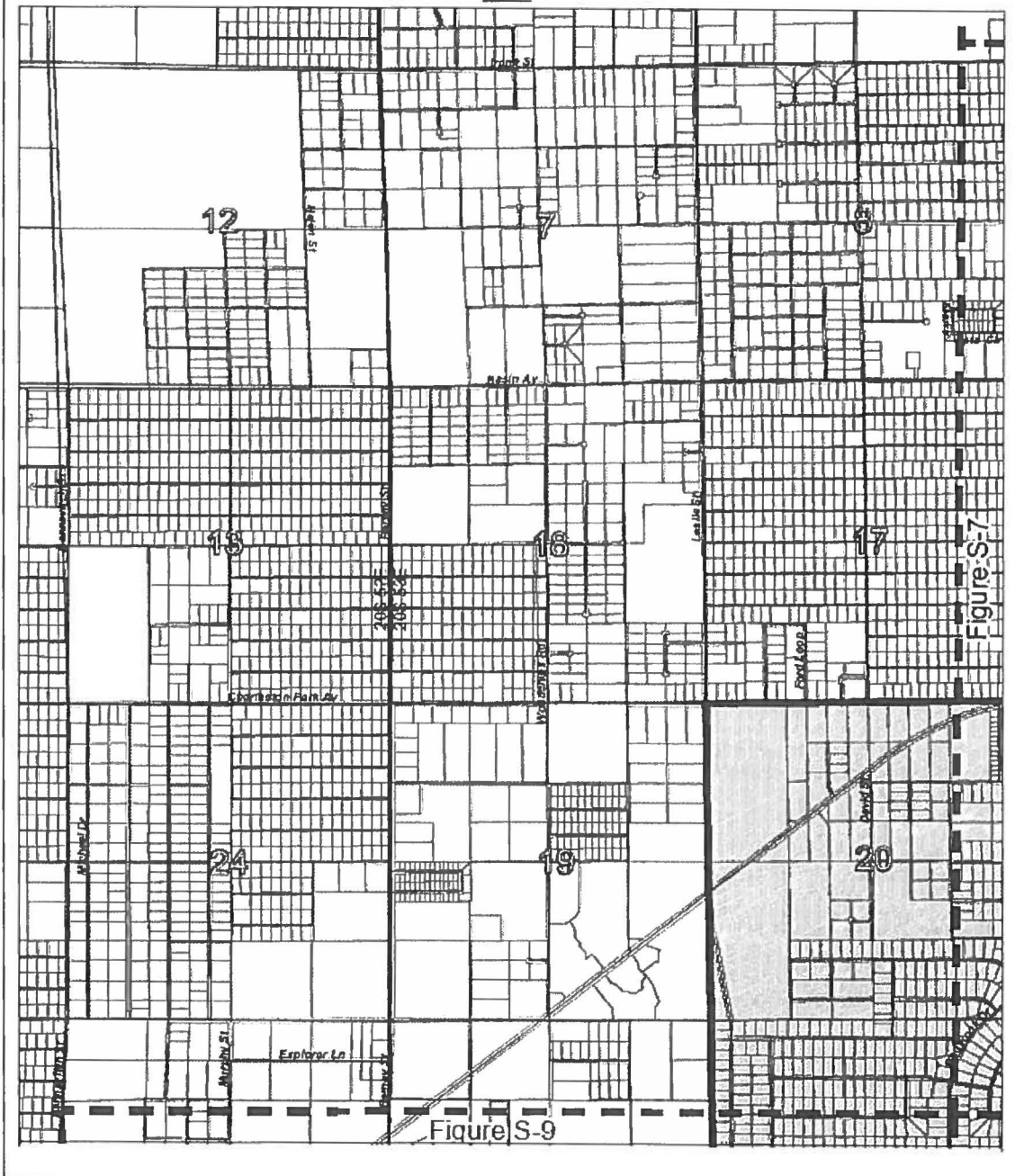

Issued:
Effective:
Advice No.:

Issued by:
Wendy Barnett, President
Great Basin Water Co.



Great Basin Water Co.
1240 E. State St., Ste. 115
Pahrump, NV 89048

REVISED PUCN Sheet No. 154
Cancels
ORIGINAL PUCN Sheet No. 154

Tariff No. 1-W (Water)

RULE NO. 17 (Continued)

EXISTING CERTIFICATED SERVICE TERRITORY OF PAHRUMP

A. MAPS (Continued)

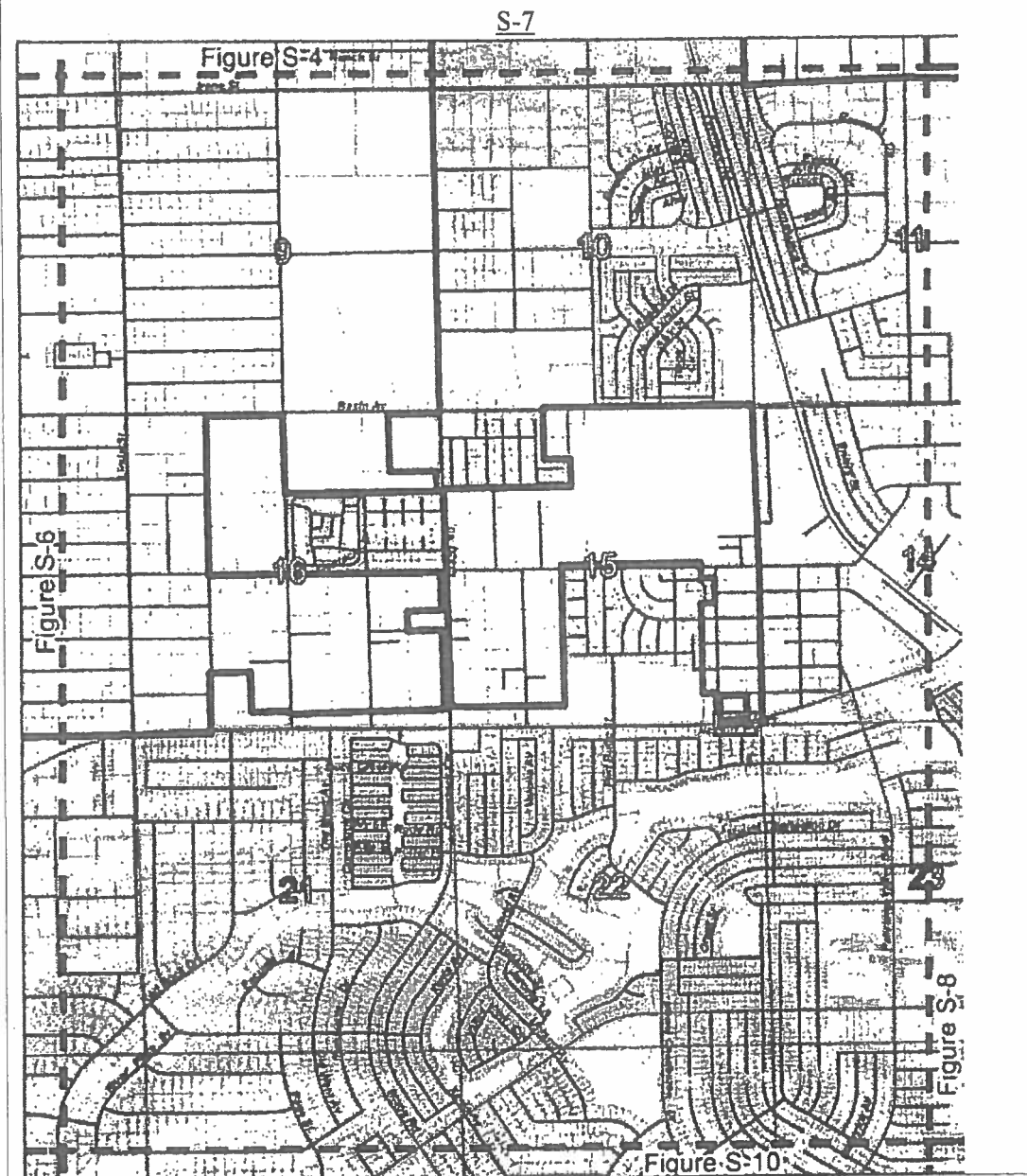

Issued:
Effective:
Advice No.:

Issued by:
Wendy Barnett, President
Great Basin Water Co.

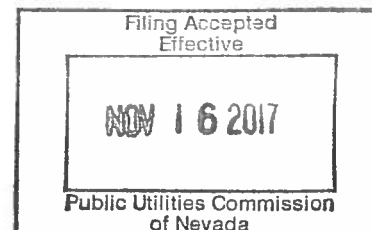

ORIGINAL PUCN Sheet No. 155
Cancels
PUCN Sheet No. _____

RULE NO. 17
EXISTING CERTIFICATED SERVICE TERRITORY OF PAHRUMP

W-8

Figure S-5

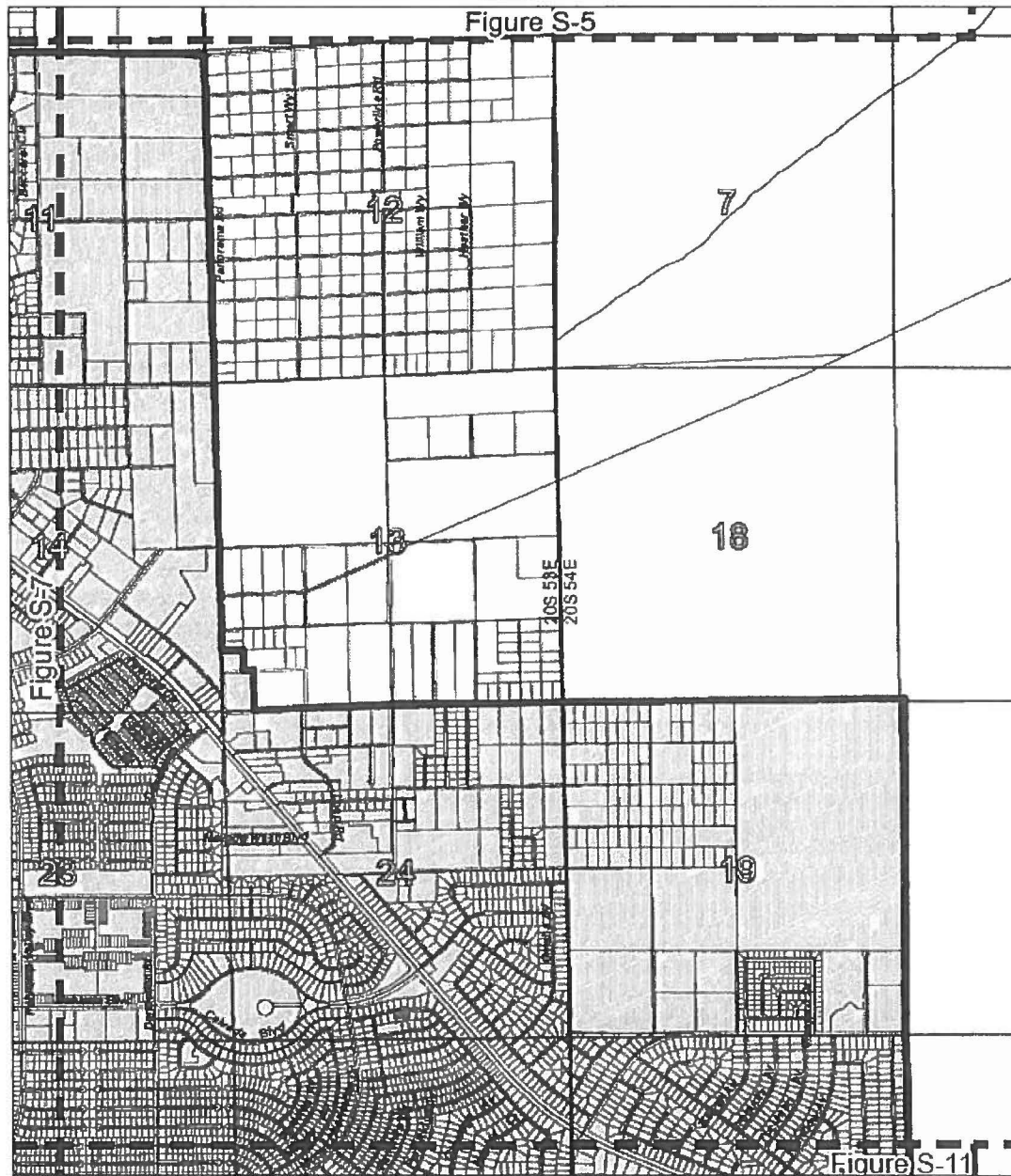

Issued by:
Wendy Barnett, President
Great Basin Water Co.

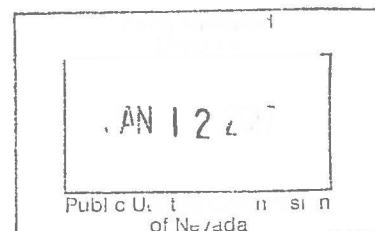

Great Basin Water Co.
1240 E. State St., Ste. 115
Pahrump, NV 89048

ORIGINAL PUCN Sheet No. 156
Cancels
PUCN Sheet No. ____

Tariff No. 1-W (Water)

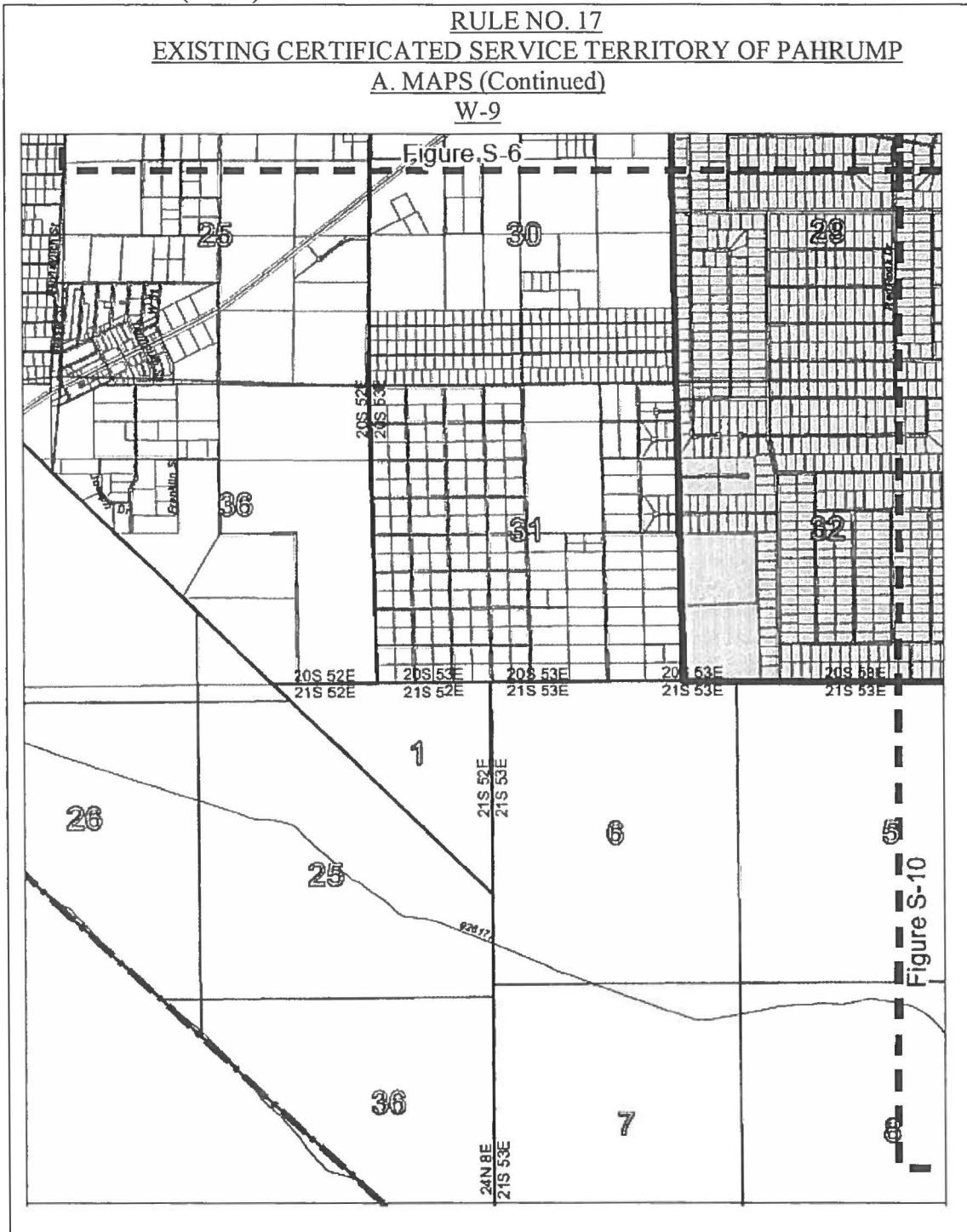

Issued:
Effective:
Advice No.:

Issued by:
Wendy Barnett, President
Great Basin Water Co.



Great Basin Water Co.
1240 E. State St., Ste. 115
Pahrump, NV 89048

ORIGINAL PUCN Sheet No. 157
Cancels
PUCN Sheet No. _____

Tariff No. 1-W (Water)

RULE NO. 17
EXISTING CERTIFICATED SERVICE TERRITORY OF PAHRUMP

A. MAPS (Continued)

W-10

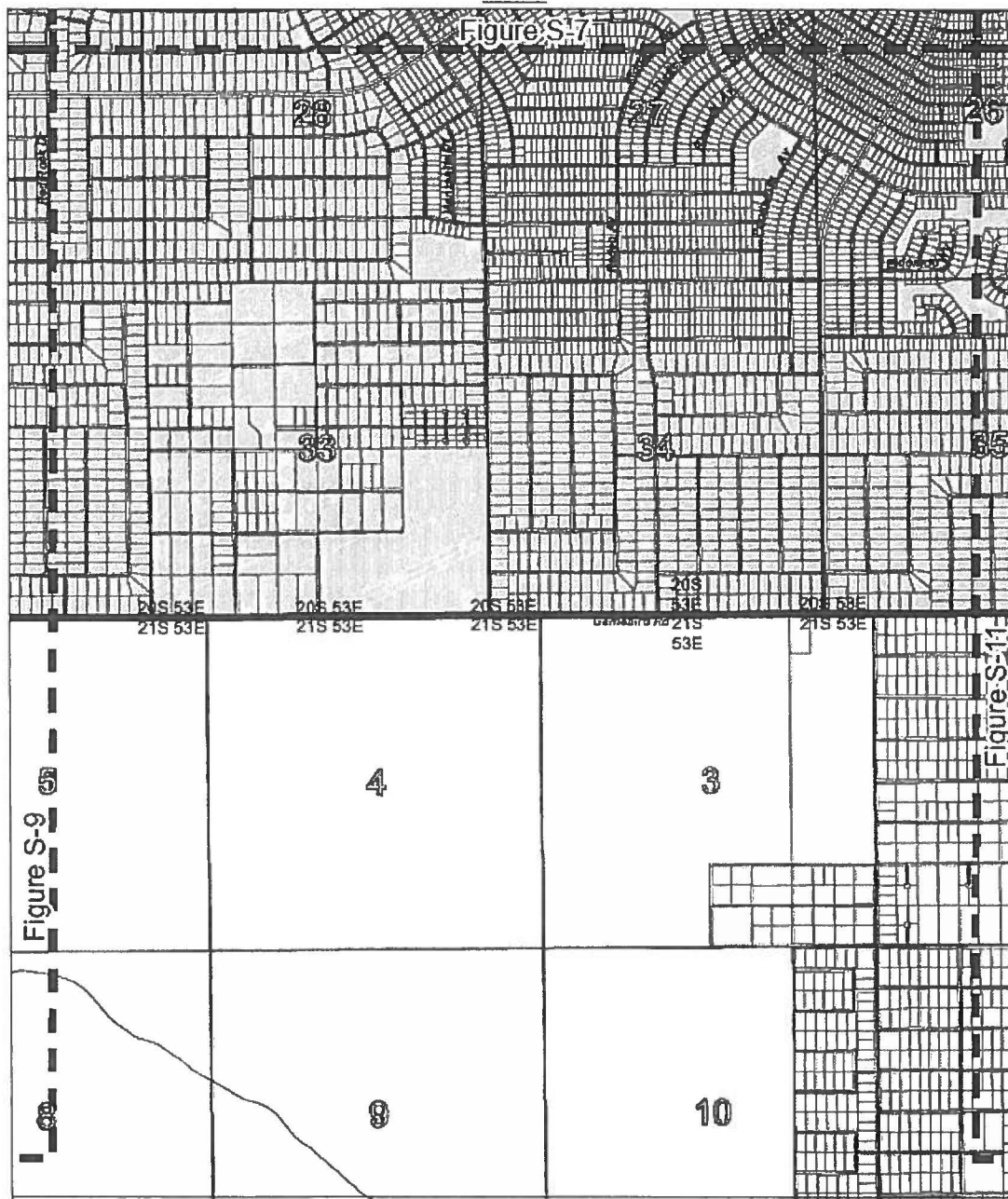

Issued:
Effective:
Advice No.:

Issued by:
Wendy Barnett, President
Great Basin Water Co.

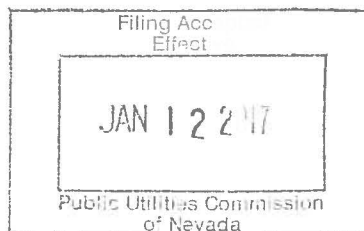

ORIGINAL PUCN Sheet No. 158
Cancels
PUCN Sheet No. ____

RULE NO. 17
EXISTING CERTIFICATED SERVICE TERRITORY OF PAHRUMP
A. MAPS (Continued)
W-11

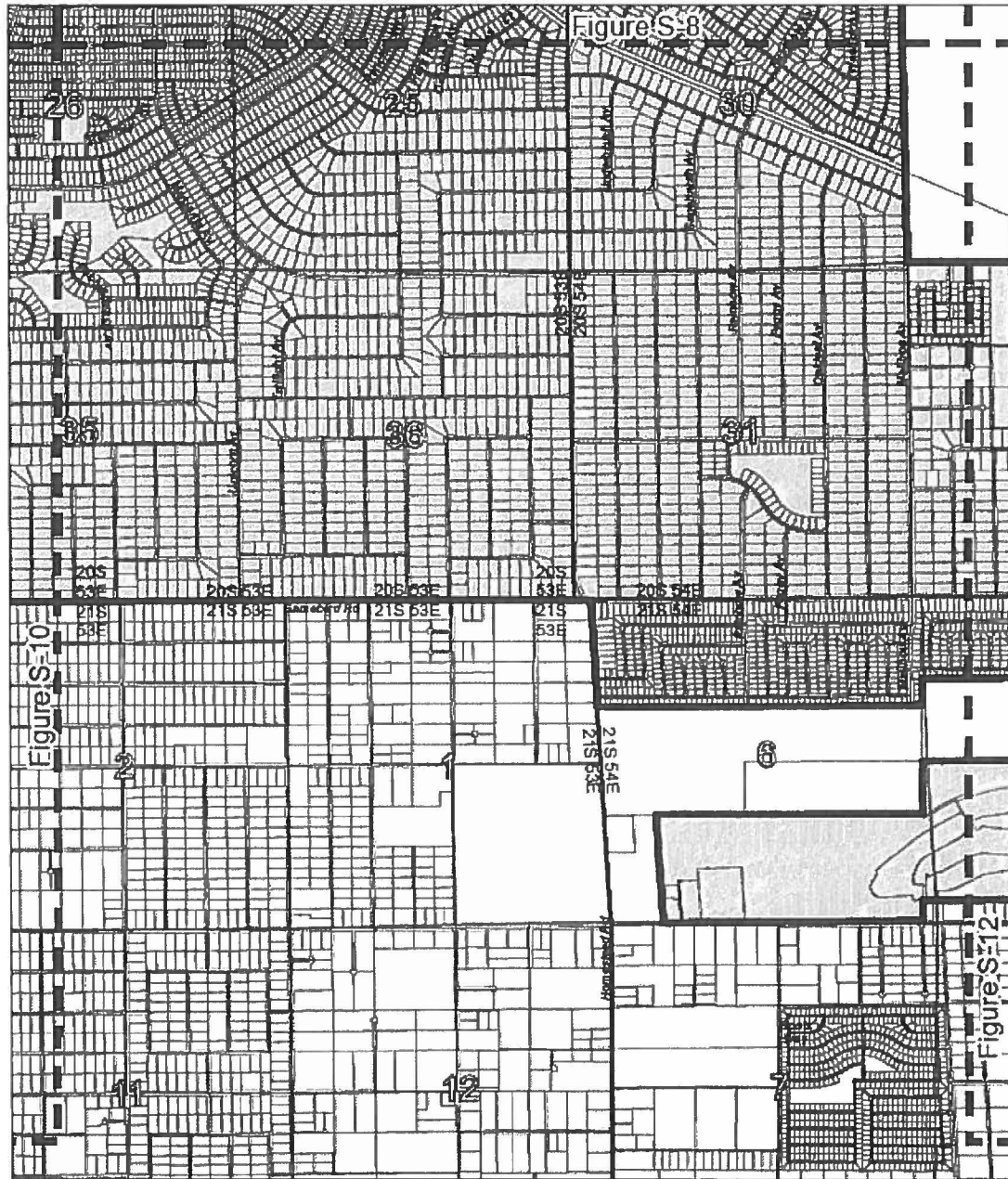

Issued by:
Wendy Barnett, President
Great Basin Water Co.

Great Basin Water Co.
1240 E. State St., Ste. 115
Pahrump, NV 89048

ORIGINAL PUCN Sheet No. 159

Cancels

PUCN Sheet No. ____

Tariff No. 1-W (Water)

RULE NO. 17
EXISTING CERTIFICATED SERVICE TERRITORY OF PAHRUMP
A. MAPS (Continued)
W-12

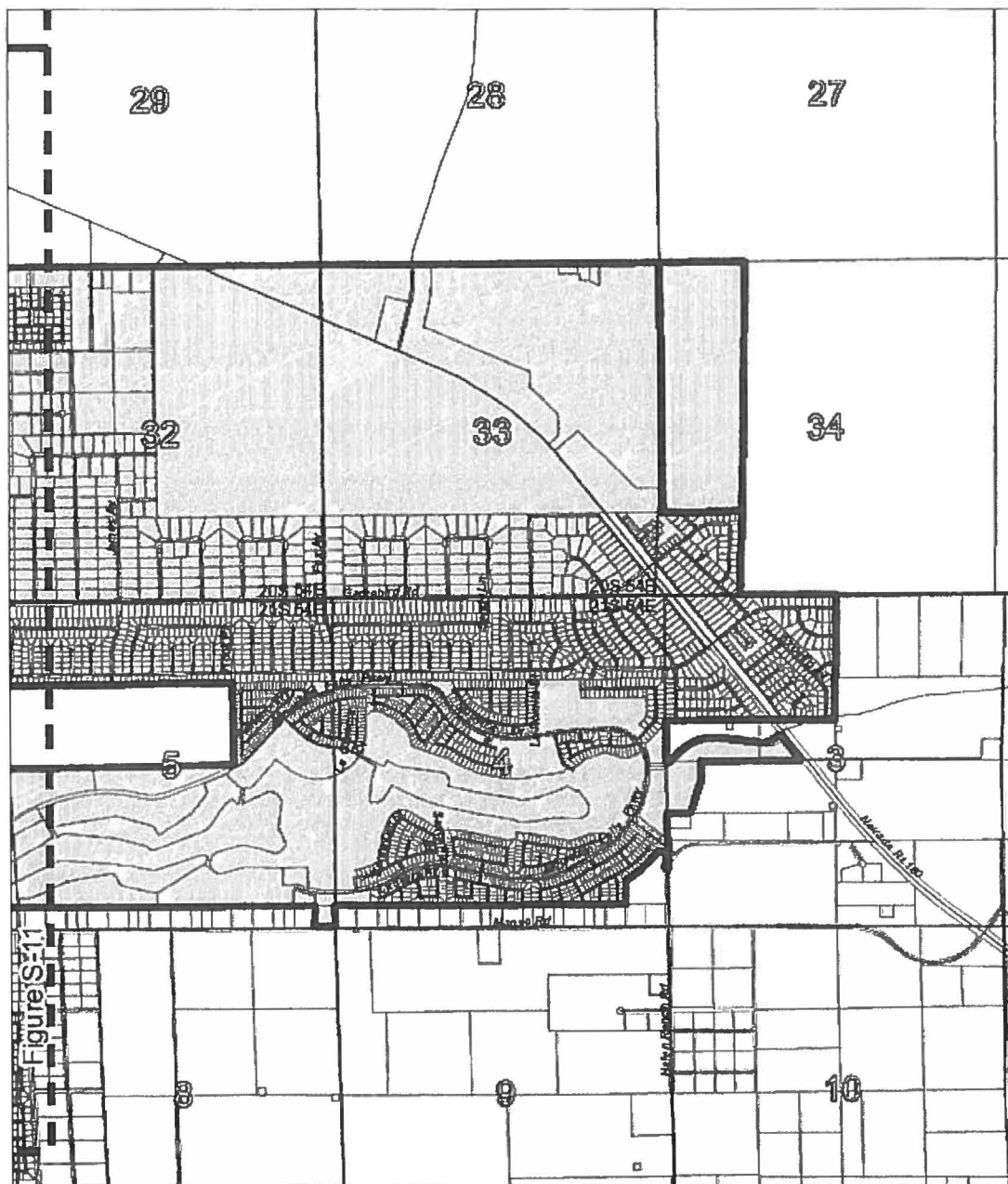

Issued:
Effective:
Advice No.:

Issued by:
Wendy Barnett, President
Great Basin Water Co.

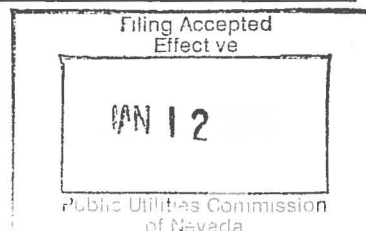

Great Basin Water Co.
1240 E. State St., Ste. 115
Pahrump, NV 89048

ORIGINAL PUCN Sheet No. 160
Cancels
PUCN Sheet No. ____

Tariff No. 1-W (Water)

RULE NO. 17
EXISTING CERTIFICATED SERVICE TERRITORY OF PAHRUMP
B. LEGAL DESCRIPTION

The following describes the Water Service area for Utilities Inc., located in Nye County, Nevada,

All that certain real property located within a portion of Sections 7, 8, 9, 10, 14, 23, 24, 26, 27, 33, 34, and 36 of Township 19 South, Range 53 East, M.D.M., Sections 3, 10, 11, 13, 14, 15, 16, 20, 21, 22, 23, 24, 25, 26, 27, 28, 29, 32, 33, 34, 35, and 36 of Township 20 South, Range 53 East, M.D.M., Sections 19, 30, 31, 32, 33, and 34 of Township 20 South, Range 54 East, M.D.M., Sections 3, 4, 5, and 6 of Township 21 South, Range 54 East, M.D.M., all in Nye County, Nevada more particularly described as follows:

Beginning at the Northwest Corner of Section 7, Township 19 South, Range 53 East, M.D.M., Nye County, Nevada; Thence departing said corner, North 89°43'37" East, along the North line of said Section 7, a distance of 5338.39 feet to the Northeast corner of said Section 7, said corner being common to Sections 5, 6, 7, and 8, of said Township 19 South, Range 53 East;

Thence departing said corner, North 89°24'44" East, along the North line of said Section 8, a distance of 5346.91 feet to the Northeast corner of said Section 8, said corner being common to Sections 4, 5, 8, and 9 of said Township 19 South, Range 53 East;

Thence departing said corner, North 88°31'22" East along the North line of said Section 9, a distance of 5208.72 feet to the Northeast corner of said Section 9, said corner being common to Sections 3, 4, 9, and 10 of said Township 19 South, Range 53 East;

Thence departing said corner North 89°48'09" East, along the North line of said Section 10, a distance of 5287.05 feet to the Northeast Corner of said Section 10, said corner being common to Sections 2, 3, 10, and 11 of said Township 19 South, Range 53 East ;

Thence departing said corner, South 01°44'11" East, along the East line of said Section 10, a distance of 5321.75 feet to the Southeast corner of said Section 10, said corner being common to Sections 10, 11, 14 and 15 of said Township 19 South, Range 53 East;

Thence departing said corner, North 89°28'26" East, along the North line of said Section 14, a distance of 5326.43 feet to the Northeast corner of said Section 14, said corner being common to Sections 11, 12, 13, and 14 of said Township 19 South, Range 53 East ;

Issued:
Effective:
Advice No.:

Issued by:
Wendy Barnett, President
Great Basin Water Co.

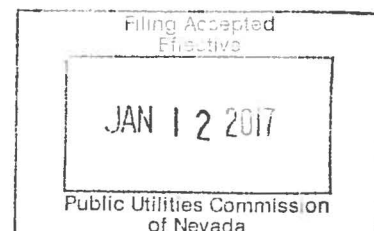

Great Basin Water Co.
1240 E. State St., Ste. 115
Pahrump, NV 89048

ORIGINAL PUCN Sheet No. 161
Cancels
PUCN Sheet No. ____

Tariff No. 1-W (Water)

RULE NO. 17
EXISTING CERTIFICATED SERVICE TERRITORY OF PAHRUMP
B. LEGAL DESCRIPTION (Continued)

Thence departing said corner, South 00°09'05" West, along the East line of said Section 14, a distance of 5325.58 feet to the Southeast corner of said Section 14, said corner being common to Sections 13, 14, 23, and 24 of said Township 19 South, Range 53 East;

Thence departing said corner, North 89°21'49" East, along the North line of said Section 24, a distance of 5234.11 feet to the Northeast corner of said Section 24, said corner being common to Sections 13 and 24 of said Township 19 South, Range 53 East and Sections 18 and 19 of Township 19 South, Range 54 East, M.D.M., Nye County, Nevada;

Thence departing said corner, South 00°48'31" West, along the West line of Section 24, said line being the line between said Range 53 East and said Range 54 East, a distance of 5338.30 feet to Southeast corner of said Section 24, said corner being common to Section 24 and 25 of said Township 19 South, Range 53 East and Sections 19 and 30 of said Township 19 South, Range 54 East;

Thence departing said corner, South 89°52'31" West, along the South line of said Section 24, a distance of 5315.55 feet to the Southwest corner of said Section 24, said corner being common to Sections 23, 24, 25, and 26 of said Township 19 South, Range 54 East;

Thence South 00°26'40" East, along the East line of said Section 26, a distance of 5410.97 feet to the Southeast corner of said Section 26, said corner being common to Sections 25, 26, 35 and 36 of said Township 19 South, Range 54 East;

Thence departing said corner, South 89°41'38" West, along the South line of said Section 26, a distance of 5166.61 feet to the Southwest corner of said Section 26, said corner being common to Sections 26, 27, 34 and 35 of said Township 19 South, Range 54 East;

Thence departing said corner, South 00°14'33" West, along the East line of Section 34, a distance of 5244.60 feet to a point coincident with the Northerly Right of Way line of Mesquite Avenue;

Thence departing said point, North 89°26'18" East, along said northerly right of Way line, a distance of 5281.46 feet, to a point on the West section line of said Section 35, said point being coincident with the center line of Panorama Road;

Thence departing said point, North 00°47'30" West, along said centerline of Panorama Road, a distance of 2605.75 feet, to the East Quarter corner of said Section 35, said corner being the West Quarter corner of Section 36;

Thence departing said corner, North 86°30'12" East, along the Center Section line of said Section 36, a distance of 2063.79 feet to the Northeast corner of the West Half (W1/2) of the East Half (E1/2) of the Southwest Quarter (SW1/4) of said Section 36;

Issued:
Effective:
Advice No.:

Issued by:
Wendy Barnett, President
Great Basin Water Co.

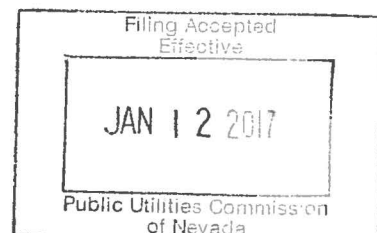

Great Basin Water Co.
1240 E. State St., Ste. 115
Pahrump, NV 89048

ORIGINAL PUCN Sheet No. 162

Cancels

PUCN Sheet No. ____

Tariff No. 1-W (Water)

RULE NO. 17

EXISTING CERTIFICATED SERVICE TERRITORY OF PAHRUMP

B. LEGAL DESCRIPTION (Continued)

Thence departing said corner, South 03°11'15" East, along the East line of said West Half (W1/2), a distance of 2655.46 feet to the Southeast corner of said West Half (W1/2). Said point being coincident with the North line Section 1, of Township 20 South, Range 53 East, Nye County, Nevada;

Thence departing said corner, South 86°10'34" West, along the South line of said Section 36, said line being coincident with the Township line between said Township 19 South and said Township 20 South, a distance of 2176.05 feet, to the Southwest corner of said Section 36, said corner being common to Sections 35 and 36 of said Township 19 South, Range 53 East and Sections 1 and 2 of said Township 20 South, Range 53 East,;

Thence departing said corner, South 89°14'41" West, along the South line of said Section 35, a distance of 5282.29 feet to the Southwest corner of said Section 35, said corner being common to Sections 34 and 35 of said Township 19 South, Range 53 East and Sections 2 and 3 of said Township 20 South, Range 53 East;

Thence departing said corner, South 00°33'43" East, along the West line of said Section 2, a distance of 5356.30 feet, to the Southwest corner of said Section 2, said corner being common to Sections 2, 3, 10 and 11 of said Township 20 South, Range 53 East;

Thence departing said corner, North 88°04'49" East, along the South line of said Section 2, a distance of 2721.18 feet, to the South Quarter corner of said Section 2, said corner being the North Quarter corner of said Section 11;

Thence departing said corner, South 88°55'58" East, continuing along the South line of said Section 2, a distance of 2637.05 feet, to the Southeast corner of said Section 2, said corner being common to Sections 1, 2, 11, and 12 of said Township 20 South, Range 53 East;

Thence departing said corner, South 01°32'25" East, along the East line of said Section 11, a distance of 5352.99 feet, to the Southeast corner of said Section 11, said corner being common to Sections 11, 12, 13, and 14 of said Township 20 South, Range 53 East;

Thence South 01°24'12" East, a distance of 4338.43 feet to the Northwest corner of the Southwest Quarter (SW1/4) of the Northwest Quarter (NW1/4) of the Southwest Quarter (SW1/4) of the Southwest Quarter (SW1/4) of Section 13; Thence departing said point, North 87°24'09" East along the North line of said Southwest Quarter, a distance of 336.81 feet to the Northeast corner of said Southwest Quarter (SW1/4);

Thence South 00°26'14" East, along the East line of said Southwest Quarter (SW1/4), a distance of 335.06 feet to the Southeast corner of said Southwest Quarter (SW1/4);

Issued:
Effective:
Advice No.:

Issued by:
Wendy Barnett, President
Great Basin Water Co.

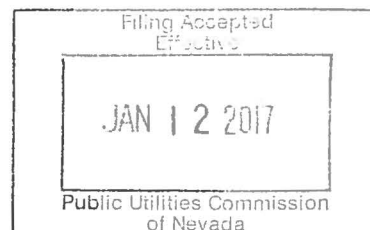

Great Basin Water Co.
1240 E. State St., Ste. 115
Pahrump, NV 89048

ORIGINAL PUCN Sheet No. 163

Cancels

PUCN Sheet No. ____

Tariff No. 1-W (Water)

RULE NO. 17

EXISTING CERTIFICATED SERVICE TERRITORY OF PAHRUMP

B. LEGAL DESCRIPTION (Continued)

Thence North 88°26'08" East, along the North line of the Southwest Quarter (SW1/4) of the Southwest Quarter (SW1/4) of the Southwest Quarter (SW1/4) of the Southwest Quarter (SW1/4) of said Section 13, a distance of 169.20 feet to the Northeast corner of said Southwest Quarter (SW1/4);

Thence departing said corner, South 01°03'26" East along the East line of said Southwest Quarter (SW1/4), 664.27 feet to the Southeast corner of said Southwest Quarter (SW1/4), said point being on the South line of said Section 13; Thence North 86°52'56" East, along the South line of said Section 13, 2188.14 feet to the South Quarter corner of Section 13, said point also being the North Quarter corner of Section 24 of said Township 20 South, Range 53 East;

Thence departing said corner, North 89°34'06" East, along the South line of said Section 13, a distance of 2706.25 feet to the Southeast corner of said Section 13, said corner being common to Sections 13 and 24 of said Township 20 South, Range 53 East and Sections 18 and 19 of Township 20 South, Range 54 East, M.D.M., Nye County, Nevada;

Thence North 89°20'57" East, along the North line of said Section 19, a distance of 5395.78 feet to the Northeast corner of said Section 19, said corner being common to Sections 17, 18, 19 and 20 of said of Township 20 South, Range 54 East;

Thence departing said corner, South 00°07'21" West, along the East line of said Section 19, 5457.75 feet to the Southeast corner of said Section 19, said corner being common to Sections 19, 20, 29 and 30 of said of Township 20 South, Range 54 East;

Thence departing said corner, South 01°12'38" East, along the east line of said Section 30, a distance of 5326.70 feet to the Southeast corner of said Section 30, said corner being common to Sections 29, 30, 31, and 32 of said of Township 20 South, Range 54 East;

Thence departing said corner, North 89°39'45" East, along the North line of said Section 32, a distance of 5278.74 feet to the Northeast corner of said Section 32, said corner being common to Sections 28, 29, 32, and 33 of said of Township 20 South, Range 54 East;

Thence departing said corner, North 89°34'12" East, along the North line of said Section 33, a distance of 5389.03 feet to the Northeast corner of said Section 33, said corner being common to Sections 27, 28, 33 and 34 of said of Township 20 South, Range 54 East;

Thence departing said corner, South 00°35'43" East, along the East line of said Section 33, 4017.39 feet to the Northwest corner of the Southwest Quarter (SW1/4) of the Southwest Quarter (SW1/4) of said Section 34;

Issued:
Effective:
Advice No.:

Issued by:
Wendy Barnett, President
Great Basin Water Co.

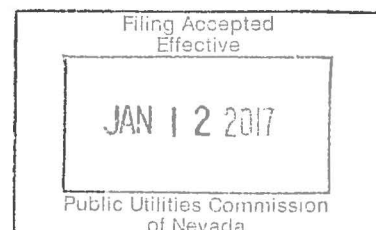

Great Basin Water Co.
1240 E. State St., Ste. 115
Pahrump, NV 89048

ORIGINAL PUCN Sheet No. 164
Cancels
PUCN Sheet No. ____

Tariff No. 1-W (Water)

RULE NO. 17
EXISTING CERTIFICATED SERVICE TERRITORY OF PAHRUMP
B. LEGAL DESCRIPTION (Continued)

Thence departing said corner, North 89°02'52" East, along the North line of said Southwest Quarter (SW1/4), a distance of 1252.88 feet to the Northeast corner of said Southwest Quarter (SW1/4);

Thence departing said corner, South 01°51'18" West, along the East line of said Southwest Quarter (SW1/4), a distance of 1351.15 feet to the Southeast corner of said Southwest Quarter (SW1/4), said corner also being on the North line of Section 3, Township 21 South, Range 54 East, M.D.M., Nye County, Nevada;

Thence departing said corner, North 89°35'54" East, along the North line of Said Section 3, a distance of 1510.54 feet to the North Quarter corner of said Section 3;

Thence departing said corner, South 00°22'06" West, along the center section line of said Section 3, a distance of 2013.00 feet to the Northeast corner of the South Half (S1/2) of the Southeast Quarter (SE1/4) of the Northwest Quarter (NW1/4) of said Section 3;

Thence departing said corner departing said corner, South 89°30'52" West, along the North line of the South Half (S1/2) of the South Half (S1/2) of the Northwest Quarter (NW1/4) of said Section 3, a distance of 2674.21 feet to the Northwest corner of said South Half (S1/2) of said Section 3;

Thence departing said corner, South 00°42'23" East, along the West line of said Section 3, a distance of 675.00 feet to the West quarter corner of said Section 3;

Thence departing said corner, North 72°22'00" East a distance of 56.58 feet to a point;

Thence North 44°54'54" East a distance of 152.08 feet to a point;

Thence North 47°07'08" East a distance of 146.21 feet to the beginning of a 627.29 foot radius curve;

Thence along the arc of a 627.29 foot radius curve to the right, through a central angle of 20°26'18" and arc distance of 146.21 feet to a point of compound curvature;

Thence along the arc of a 644.70 foot radius curve to the right, through a central angle of 18°00'51", an arc distance of 202.70 feet to a point;

Thence departing said point, North 88°48'54" East a distance of 139.18 feet to the beginning of a 971.35 foot radius curve;

Thence along the arc of a 971.35 foot radius curve to the right, through a central angle of 13°45'14", an arc distance of 233.17 feet to a point;

Thence departing said point, South 83°37'29" East a distance of 418.72 feet to the beginning of a 395.45 foot radius curve;

Issued:
Effective:
Advice No.:

Issued by:
Wendy Barnett, President
Great Basin Water Co.

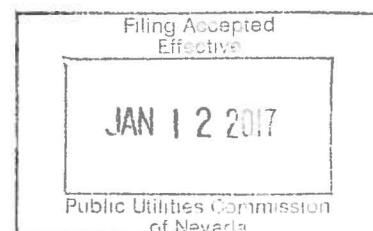

Great Basin Water Co.
1240 E. State St., Ste. 115
Pahrump, NV 89048

ORIGINAL PUCN Sheet No. 165
Cancels
PUCN Sheet No. __

Tariff No. 1-W (Water)

RULE NO. 17
EXISTING CERTIFICATED SERVICE TERRITORY OF PAHRUMP
B. LEGAL DESCRIPTION (Continued)

Thence along the arc of a 395.45 foot radius curve to the left, through a central angle of 41°02'17" an arc distance of 283.24 feet;

Thence North 51°51'29" East a distance of 91.86 feet to a point on the Southwesterly Right of Way line of State Highway 160;

Thence departing said point, South 38°26'59" East, along said Southwesterly Right of Way line, a distance of 539.47 feet to a point on the center of section line of said Section 3;

Thence departing said point, South 89°42'31" West, along said center of section line, a distance of 1575.51 feet to a point;

Thence departing said center of section line, South 00°18'23" East a distance of 282.58 feet to a point;

Thence departing said point, South 17°26'07" West a distance of 578.66 feet to a point;

Thence departing said point, South 89°49'27" West a distance of 365.40 feet to a point on the West line of said Section 3;

Thence departing said point, South 00°54'39" East, along the West line of said Section 3, a distance of 897.31 feet to a point;

Thence departing said West line, North 87°34'33" West a distance of 45.89 feet to a point;

Thence departing said point, North 02°46'15" East a distance of 218.32 feet to a point;

Thence departing said point, North 52°22'54" West a distance of 129.82 feet to a point;

Thence departing said point, South 43°27'24" West a distance of 182.49 feet to the beginning of a 2081.55 foot radius curve.

Thence along the arc of a 2081.55 foot radius curve to the right, through a central angle of 15°08'31", an arc distance of 550.10 feet to a point;

Thence departing said point, South 00°47'00" West a distance of 386.31 feet to a point;

Thence departing said point, South 89°40'00" West a distance of 4605.98 feet to a point on the West line of Section 4, Township 21 South, Range 54 East, M.D.M., Nye County, Nevada;

Issued:
Effective:
Advice No.:

Issued by:
Wendy Barnett, President
Great Basin Water Co.

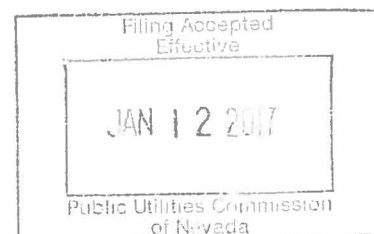

Great Basin Water Co.
1240 E. State St., Ste. 115
Pahrump, NV 89048

ORIGINAL PUCN Sheet No. 166
Cancels
PUCN Sheet No. ____

Tariff No. 1-W (Water)

RULE NO. 17
EXISTING CERTIFICATED SERVICE TERRITORY OF PAHRUMP
B. LEGAL DESCRIPTION (Continued)

Thence departing said point, South 00°49'54" East, along said West line of said Section 4, a distance of 326.61 feet to the Southwest corner of said Section 4, said corner being common to Sections 4, 5, 8, and 9 of said Township 21 South, Range 54 East;

Thence departing said corner, South 89°44'21" West, along the South line of said Section 5, distance of 329.61 feet to a point;

Thence departing said South line, North 00°43'41" East a distance of 330.83 feet to a point;

Thence departing said point, South 89°39'14" West a distance of 4939.99 feet to a point on the West line of said Section 5;

Thence departing said point, South 00°07'01" East, along said West line, a distance of 331.38 feet to the Southwest corner of said Section 5, said corner being common to Sections 5, 6, 7, and 8 Township 21 South, Range 54 East;

Thence departing said corner, South 89°36'08" West, along the South line of said Section 6, a distance of 4128.17 feet;

Thence departing said South line, North 03°43'07" West a distance of 1749.52 feet to a point;

Thence departing said point, North 89°49'11" East a distance of 4239.94 feet to a point on the West line of said Section 5;

Thence departing said point, North 00°33'12" West, along said West line of Section 5, a distance of 850.88 feet to the West quarter corner of Said Section 5, said point also being the East quarter corner of said Section 6;

Thence departing said corner, North 89°36'49" East, a distance of 1442.37 feet to a point;

Thence departing said point, North 88°57'33" East, a distance of 2227.26 feet to a point;

Thence departing said point, North 00°25'23" West, a distance of 1324.66 feet to a point;

Thence departing said point, South 89°13'26" West, a distance of 3660.39 feet to a point on the East line of said Section 6;

Thence departing said point, South 00°02'25" East, along said East line of Section 6, a distance of 425.42 feet to a point;

Thence departing said East line, South 89°39'22" West a distance of 5153.92 feet to a point on the west line of said Section 6;

Issued:
Effective:
Advice No.:

Issued by:
Wendy Barnett, President
Great Basin Water Co.

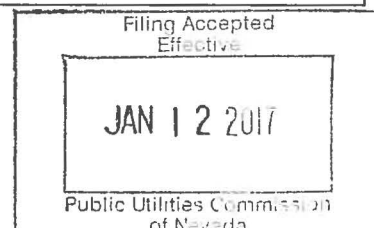

Great Basin Water Co.
1240 E. State St., Ste. 115
Pahrump, NV 89048

ORIGINAL PUCN Sheet No. 167
Cancels
PUCN Sheet No. ____

Tariff No. 1-W (Water)

RULE NO. 17
EXISTING CERTIFICATED SERVICE TERRITORY OF PAHRUMP
B. LEGAL DESCRIPTION (Continued)

Thence departing said point, North 03°17'10" West, along the West line of said Section 6, a distance of 1741.55 feet to the Northwest corner of said Section 6, said corner being common to Section 1, Township 21 South, Range 53 East, M.D.M., Nye County, Nevada;

Thence departing said corner, South 89°50'09" West, along the North line of Said Section 1, a distance of 4859.80 feet to the Northwest corner of said Section 1, said corner being common to Sections 1 and 2 of said Township 21 South, Range 53 East;

Thence departing said corner, South 89°41'37" West, along the north line of said Township 21 South, Range 53 East, a distance of 6033.71 feet to the Southeast corner of Section 34, of said Township 20 South, Range 53 East said corner being common to Sections 34 and 35;

Thence departing said corner, South 89°35'58" West, along the South line of said Section 34, a distance of 5334.63 feet to the Southwest corner of said Section 34, said corner being common to Section 33, of said Township 20 South, Range 53 East;

Thence departing said corner, South 89°32'55" West, along the South line of said Section 33, a distance of 2667.68 feet to the South Quarter corner of said Section 33;

Thence departing said corner, South 89°32'55" West, along said South line, a distance of 1866.25 feet to the Northeast corner of Section 5, Township 21 South, Range 53 East, M.D.M., Nye County, Nevada, said corner being common to Sections 4 and 5 of said Township 21 South, Range 53 East;

Thence departing said corner, South 89°52'14" West, along the North line of said Section 5, a distance of 4457.07 feet to a point being at the center line of Winchester Avenue;

Thence departing said centerline, North 89°55'59" West, along said North line, a distance of 1659.01 feet to the Southwest corner of Section 32, of said Township 20 South, Range 53 East, M.D.M., said corner being common to Section 31 of said Township 20 South, Range 53 East;

Thence departing said corner, North 01°09'03" West, along the West line of said Section 32, a distance of 5316.12 feet to the Northwest corner of said Section 32, said corner being common to Sections 29, 30, 31, and 32 of Said Township 20 North, Range 53 East;

Thence departing said corner, North 00°56'10" West, along the West line of said Section 29, a distance of 5317.49 feet to the Northwest corner of said Section 29, said corner being common to Sections 19, 20, 29, and 30 of Said Township 20 North, Range 53 East;

Thence departing said corner, North 00°57'03" West, along the West line of said Section 20, a distance of 5294.40 feet to the Northwest corner of said Section 20, said corner being common to Sections 17, 18, 19, and 20 of Said Township 20 North, Range 53 East;

Thence departing said corner, South 89°52'14" West, along the North line of said Section 5, a distance of 4457.07 feet to a point being at the center line of Winchester Avenue;

Issued:
Effective:
Advice No.:

Issued by:
Wendy Barnett, President
Great Basin Water Co.

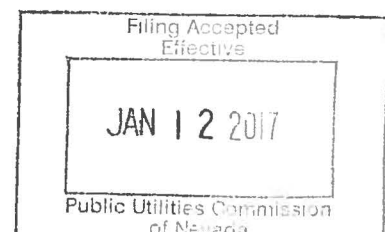

Great Basin Water Co.
1240 E. State St., Ste. 115
Pahrump, NV 89048

ORIGINAL PUCN Sheet No. 168
Cancels
PUCN Sheet No. ____

Tariff No. 1-W (Water)

RULE NO. 17
EXISTING CERTIFICATED SERVICE TERRITORY OF PAHRUMP
B. LEGAL DESCRIPTION (Continued)

Thence departing said corner, North 89°06'19" East, along the North line of said Section 20, a distance of 5280.26 feet to the Northeast corner of said Section 20, said corner being common to Sections 16, 17, 20 and 21 of Said Township 20 North, Range 53 East;

Thence departing said corner, North 89°25'58" East along the South line of said Section 16, a distance of 1312.73 feet to the West 1/16TH corner of Said Section 16;

Thence departing said corner, North 01°13'58" West along the sixteenth line of the Southwest Quarter (SW1/4) of said Section 16, a distance of 1003.28 feet to a point;

Thence departing said point, North 87°10'32" East a distance of 697.13 feet to a point;

Thence departing said point, South 01°08'39" East a distance of 669.33 feet to a point;

Thence departing said point, North 88°53'49" East a distance of 637.50 feet to a point on the Westerly Right of Way line of Lola Lane;

Thence departing said point, South 53°03'24" East a distance of 79.01 feet to a point on the Easterly Right of Way line of Lola Lane;

Thence departing said Right of Way line, North 88°21'39" East a distance of 2561.94 feet to a point;

Thence departing said point, North 01°37'18" West a distance of 1316.96 feet to a point;

Thence departing said point, South 88°35'50" West a distance of 579.24 feet to a point;

Thence departing said point, North 01°28'12" West a distance of 330.00 feet to a point;

Thence departing said point, North 88°21'26" East a distance of 577.95 feet to a point;

Thence departing said point, North 01°32'23" West a distance of 632.73 feet to a point on the Southerly Right of Way of Wilson Road;

Thence departing said point, South 89°23'57" West, along said Southerly Right of Way line, a distance of 3909.72 feet to a point on the centerline of Margaret Street;

Thence departing said Right of Way line, North 00°47'40" West, along the sixteenth line of the Northwest Quarter (NW1/4) of said Section 16, a distance of 2666.06 feet to a point on the Southerly Right of Way line of Basin Road;

Thence departing said point, North 89°19'52" East, along said southerly Right of Way line, a distance of 1310.81 feet to a point on the center section line of said Section 16;

Issued:
Effective:
Advice No.:

Issued by:
Wendy Barnett, President
Great Basin Water Co.

