



Lake Wildwood
Source Water Protection
Plan

Marshall County, IL
June 2024

ENGINEERING ENTERPRISES, INC.



SOURCE WATER PROTECTION PLAN

Prairie Path Water Company – Lake Wildwood

TABLE OF CONTENTS

<u>SECTION</u>	<u>PAGE NO.</u>
1.0 INTRODUCTION.....	1-1
1.1 Background	1-1
2.0 VISION STATEMENT	2-1
2.1 Policy and Commitment to Protecting Source Water	2-1
2.2 Reasons to Protect Source Water	2-1
2.3 Barriers to Protecting Source Water	2-2
2.4 Names of the Individuals Who Developed the Vision Statement	2-3
3.0 SOURCE WATER ASSESSMENT	3-1
3.1 Statement of the Importance of Source Water	3-1
3.2 List of Water Supplies that Obtain Water from the Community Water Supply ...	3-2
3.3 Delineation of all Sources of Water Used by the Community Water Supply	3-2
3.4 Report on the Quality of the Source Water for All Sources of Water.....	3-4
3.5 Report on the Quality of the Finished Water	3-6
3.6 Identification of Potential Sources of Contamination to the Source Water	3-9
3.7 Analysis of the Source Water's Susceptibility to Contamination	3-11
3.8 Explanation of the Community Water Supply's Efforts to Protect Its Source Water	3-13
4.0 SOURCE WATER PROTECTION PLAN OBJECTIVES.....	4-1
4.1 Identified Concerns	4-1
4.2 Objectives.....	4-1
5.0 ACTION PLAN	5-1
5.1 Projects, Programs, and Activities to Meet Objectives	5-1
5.2 Schedule for Implementing Projects, Programs, and Activities	5-1
5.3 Identification of Necessary Resources to Implement the Plan	5-1
5.4 Identification of Potential Problems and Obstacles in Implementing the Plan....	5-2

Tables

3-1	Water Supply Well Information.....	3-3
3-2	Source Water Quality Summary.....	3-5
3-3	Finished Water Quality Summary	3-8
3-4	Potential Contaminant Source Inventory.....	3-14
5-1	Source Water Protection Plan Schedule.....	5-3 and 5-4

Exhibits

1-1	Municipal Boundary and Water Supply Wells	1-2
3-1	Municipal Boundary and Water Supply Wells	3-3
3-2	Barium Concentration Trend	3-6
3-3	Map of Potential Sources of Contamination	3-10
3-4	Groundwater Susceptibility	3-12

Appendices

Appendix A.....	Source Water Protection Plan Regulations
Appendix B.....	Well Information
Appendix C	Representative Source Water Quality Analytical Reports

SECTION 1: INTRODUCTION

Prairie Path Water Company (PPWC) owns and operates the Lake Wildwood Community Water System (CWS) (IL1235200) according to the rules and regulations of the State of Illinois. On July 26, 2019, the Illinois Pollution Control Board passed new and updated regulations for community water systems including Illinois Administrative Code Title 35, Subpart 604, Subpart C - Source Water Protection Plan. The purpose of this new requirement is to facilitate protection of source water quality and quantity throughout the State. It requires each community water supply that treats surface or groundwater as a primary or emergency supply of water to develop a Source Water Protection Plan (SWPP). The SWPP must contain the following minimum elements:

- a) a vision statement;
- b) a source water assessment;
- c) the objectives; and
- d) an action plan.

The specific requirements for each of the elements list above are contained in the regulation, which is included herein as Appendix A. This report is submitted to the Illinois Environmental Protection Agency (IEPA) in fulfillment of the Lake Wildwood CWS's requirement under Subpart C – Source Water Protection Plan.

1.1 Background

The Lake Wildwood CWS is in Roberts Township, Marshall County (Exhibit 1-1). The CWS is comprised of a network of various supply, treatment, storage, distribution, and control components. The water system components are specifically designed and operated to provide safe, reliable, and affordable drinking water to the Lake Wildwood CWS water customers. The existing supply consists of two shallow wells designated Well 1 and Well 3. Well 1 is cased off through the upper sand and gravel layers and draws from the deeper sand and gravel glacial drift material. Well 3 is nearly equivalent in depth to Well 1 and also draws from the lower glacial drift aquifer, belonging to the Quaternary geologic group in Marshall County. The system also features a third supply well designated Well 2 which was abandoned and sealed in 2008.

The pumped water from Wells 1 and 3 flow to Lake Wildwood CWS's Water Treatment Plant (TP01). The raw groundwater is then treated chemically with sodium hypochlorite for bacterial

disinfection. The water from Well 1 is treated to meet drinking water quality standards and is then distributed to Lake Wildwood CWS's service area delivered through 513 residential water service connections.

The effectiveness of the system depends on the availability and quality of the water used as the source of water (source water). Significant changes in source water availability or quality often require costly modifications to the water system. Therefore, the Lake Wildwood CWS benefits from Source Water Protection because the program can reduce the risk of source water impairment.

Exhibit 1-1: Lake Wildwood CWS Location Map

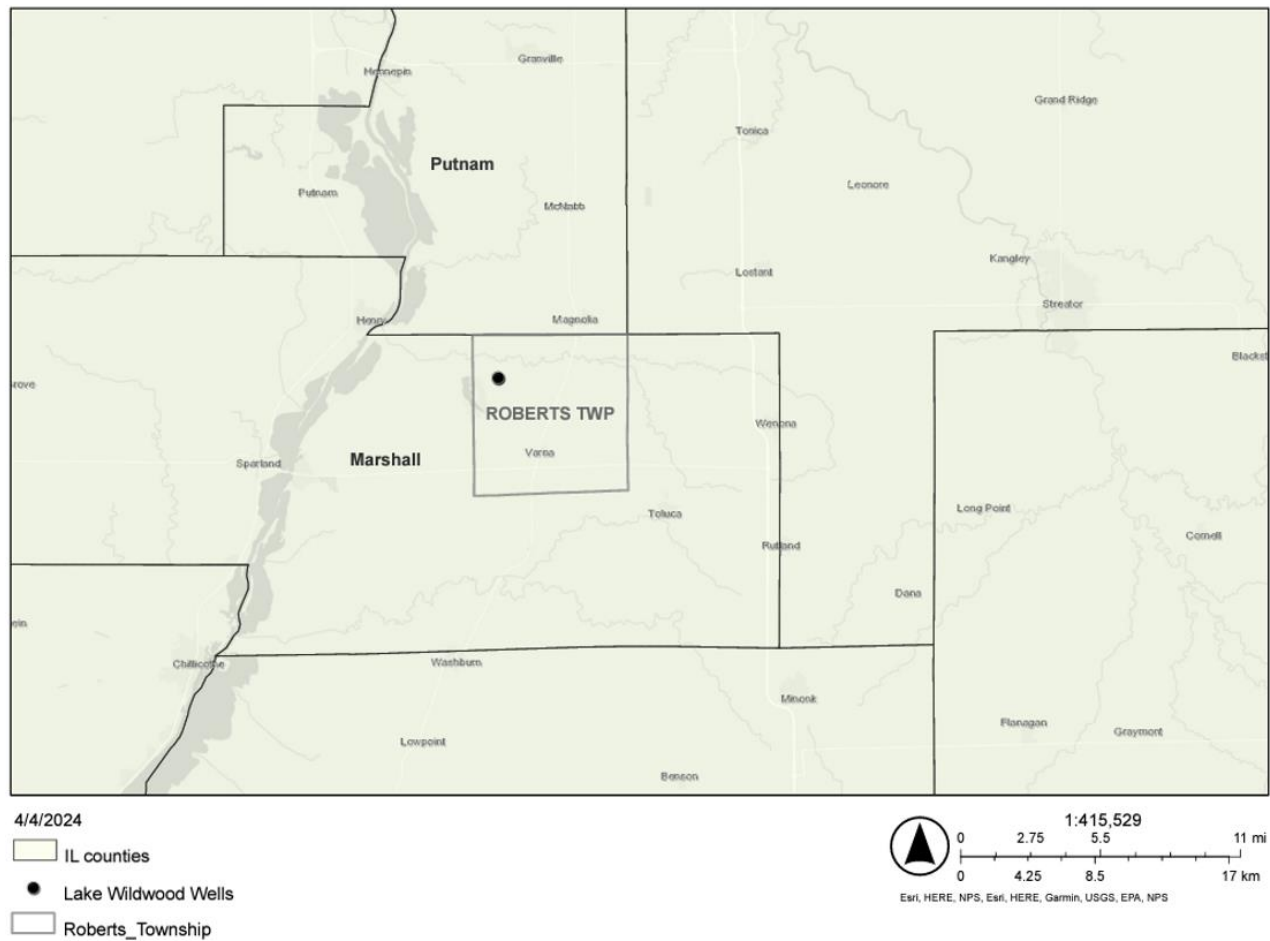

SECTION 2: VISION STATEMENT

This section presents the System's adherence to the requirements of Section 604.310 Vision Statement, which are:

The vision statement must include the following:

- a) the community water supply's policy and commitment to protecting source water;*
- b) an explanation of the community water supply's resources to protect source water;*
- c) an explanation of the barriers to protecting source water; and*
- d) the names of the individuals who developed the vision statement.*

2.1 Policy and Commitment to Protecting Source Water

The Prairie Path Water Company - Lake Wildwood CWS policy and commitment to protect source water begins with the following vision statement:

Prairie Path Water Company is committed to Source Water Protection Programs with the purpose of ensuring the safety, integrity and sustainability of our communities' drinking water, for current and future generations to come, all in an effort to help people enjoy a better life and help communities thrive.

2.2 Resources to Protect Source Water

Prairie Path Water Company commits the following resources to protect the source water of the Lake Wildwood CWS:

- Human capital and financial resources to protect our source water and to back our commitment to the preservation of safe and sustainable drinking water.
- Staff time and effort to regularly monitor the well supply, monitor changes in potential sources of contamination, and regularly coordinate with local zoning officials to identify future potential sources of contamination.
- Engaging consultants to update the existing source water protection plan to demonstrate the System's commitment to continually improving the plan with updated

information and incorporating lessons learned through experience.

- Development and continual updates to the Lake Wildwood CWS Emergency Response Plan.

2.3 Barriers to Protecting Source Water

The key to ensuring clean, safe and reliable drinking water is to understand the drinking water supply from the source all the way to the consumer's tap. This knowledge includes understanding the general characteristics of the water and the land surrounding the water source, as well as mapping all the real and potential threats to the water quality. These threats can be natural, such as seasonal droughts or flooding, or created by human activity, such as agriculture, industrial practices, or recreational activities in the watershed. Threats can also arise in the treatment plant or distribution system thanks to operational breakdowns or aging infrastructure.

The multi-barrier approach takes all these threats into account and makes sure there are "barriers" in place to either eliminate them or minimize their impact. It includes selecting the best available source (e.g., lake, river, aquifer) and protecting it from contamination, using effective water treatment, and preventing water quality deterioration in the distribution system. The approach recognizes that while each individual barrier may not be able to completely remove or prevent contamination, and therefore protect public health, together the barriers work to provide greater assurance that the water will be safe to drink over the long term.

By placing integrated barriers from the source to the consumer at the tap, the Lake Wildwood CWS helps protect the population it serves from the risk of contamination and waterborne disease. The System's multiple barrier approach includes:

- Source Water Protection - delineation of areas that contribute groundwater to the water supply wells, inventory of existing and future threats also referred to as potential sources of contamination, and management of activities in and around the recharge areas of wells.
- Treatment Systems – disinfection to eliminate pathogens that are responsible for waterborne diseases.

- Distribution Systems – maintaining adequate pressure within the water distribution system to prohibit inflow of non-potable water, controlling pressure during water main breaks using water system valving, conducting water main repairs quickly, and properly disinfecting water mains before they are placed back into service.
- Monitoring programs - 24-hour a day monitoring of the water system using a customized Supervisory Control and Data Acquisition (SCADA) system, frequently collecting, and analyzing water samples, security fencing, and visual inspections of operating facilities.
- Well security – PPWC wellheads are located within locked well houses and or gated off areas to protect from vandalism or intentional contamination efforts.
- Operational Response – maintaining an emergency response plan, employing certified operators with proper training and experience to operate the water system, commitment of the organization to continuous improvement, and the assistance of outside experts as needed.

2.4 Names of the Individuals Who Developed the Vision Statement

The names of the individuals who developed the Vision Statement are as follows:

- Justin Kersey, PPWC President
- Mike Miller, PPWC Vice-President of Operations
- David Hankins, PPWC Safety and Compliance Manager
- Bob Bishop, PPWC Area Manager
- Tim Holdeman, Engineering Enterprises, Inc.
- Sydney Shaffer, Engineering Enterprises, Inc.
- Jeniece Neville, Engineering Enterprises, Inc.

SECTION 3: SOURCE WATER ASSESSMENT

This section presents the System's adherence to the requirements of Section 604.315 Source Water Assessment, which are:

- a) *The source water assessment must contain the following information:*
 - 1) *statement of the importance of the source water;*
 - 2) *a list of water supplies that obtain water from this community water supply;*
 - 3) *delineation of all sources of water used by the community water supply, including:*
 - A) *for surface water, description of the watershed, map of the watershed, and intake locations;*
 - B) *for groundwater, the well identification number, well description, well status and well depth; a description of setback zones, and a description of the aquifer for each well;*
 - 4) *a report on the quality of the source water for all sources of water delineated in subsection (a)(3), including:*
 - A) *when and where samples used to determine the quality of the source water were taken. These samples must be tested by a certified laboratory; and*
 - B) *the certified laboratory's results;*
 - 5) *a report on the quality of the finished water;*
 - 6) *identification of potential sources of contamination to the source water;*
 - 7) *analysis of the source water's susceptibility to contamination; and*
 - 8) *explanation of the community water supply's efforts to protect its source water.*

3.1 Statement of the Importance of Source Water

The importance of source water can be conveyed by the importance water plays in the communities it serves. The Lake Wildwood CWS provides water to several residential sites. The sand and gravel aquifers are the primary sources of this water. The Lake Wildwood CWS utilizes two (2) active community water supply wells. The system's water supply wells provides drinking water to a population of approximately 950 people (513 service connections) based on most recent Illinois Safe Drinking Water System data. Prairie Path Water Company recognizes that no community can exist without a safe, reliable source of drinking water, and protection of that source water is of the utmost importance.

3.2 List of Water Supplies that Obtain Water from the Community Water Supply

The Lake Wildwood CWS currently does not supply water to any Community Water Supplies.

3.3 Delineation of all Sources of Water Used by the Community Water Supply

The Lake Wildwood CWS operates two (2) groundwater wells (Wells 1 and 3). A map showing the location of the water utility service area and water supply wells is shown as Exhibit 3-1. Key information about the wells is listed in Table 3-1, including information required by the SWPP regulation and additional information. Additional well information can be found in Appendix B.

The Illinois Groundwater Protection Act (IGPA) in its first phase established setback zones to prohibit the siting of potential sources of contamination within a number of feet of the wellhead. The minimum setback zone prohibits the siting of primary or secondary sources within 200 ft of the wellhead for shallow aquifers. An optional maximum setback zone of 1,000 feet is allowed to prohibit primary sources of contamination from being sited between the minimum setback and 1,000 radial feet of the well.

In the second phase, the IGPA established the delineation of a wellhead protection area (WHPA) for wells that draw from unconfined aquifers out to a 5-year time-of-travel boundary, although it is not used in this report.

Table 3-1: Water Supply Well Information

INFORMATION REQUIRED BY SWPP REGULATION							ADDITIONAL INFORMATION	
WELL ID NUMBER	WELL NAME	WELL STATUS	WELL DEPTH	CASING LENGTH	MINIMUM SETBACK	AQUIFER	ADDRESS	YEAR DRILLED
WL31328	1	Active	273	243	200	Quaternary - Glacial Drift	1733 Tanglewood Dr., Varna, IL 61375	1968
WL01799	3	Active	275	No Record	200	Quaternary - Glacial Drift	1733 Tanglewood Dr., Varna, IL 61375	2009
WL31329	2	Inactive	305					1968

Exhibit 3-1: Lake Wildwood CWS Boundary and Water Supply Well



4/4/2024

- Lake Wildwood Wells
- Lake Wildwood Water Service Area
- 200ft_Buffer_of_Lake_Wildwood_Wells
- 1000ft_Buffer_of_Lake_Wildwood_Wells

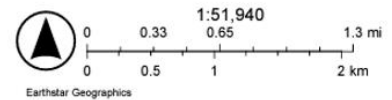

3.4 Report on The Quality of the Source Water for All Sources of Water

An analysis of the quality of groundwater from the sand and gravel aquifers used by the System as its source water was conducted as part of the Source Water Assessment. Water quality data from groundwater samples from the System's wells collected from 2015 to 2021 is presented in Table 3-2. A select number of analytical results are included in Appendix C.

The concentration of inorganic constituents in the groundwater pumped by the System's wells is summarized and compared to Class 1 Water Quality Standards for Groundwater (35 Ill. Admin. Code Part 620). No inorganic or radiological constituents have been reported above the Water Quality Standards in Lake Wildwood's wells. However, some trends to note are that naturally occurring fluoride concentrations in the groundwater basin have been steadily increasing over time, yet the increasing concentrations are not concerning close to the Groundwater Quality Standard of 3mg/L. The second and final trend in the water quality results is a gradual decrease of radium-226 and gross alpha particle activity over time. Even at the historical peak of 0.62pCi/L radium-228 in Lake Wildwood groundwater, the concentration did not nearly approach the Groundwater Quality Standard of 20pCi/L. All organic compounds including the Volatile Organic Compounds (VOCs) and Synthetic Organic Compounds (SOCs) were reported below the detection limits of each testing method.

Exhibit 3-2 is a graph of fluoride concentrations from Well 1. The graph shows that fluoride concentrations have been steadily rising since 2015 with the latest sample being in December 2021. Fluoride is present naturally in geologic features containing minerals such as fluorite (CaF_2).

Table 3-2: Source Water Quality Summary

	Wells		1 and 3 (WL31328 and WL01799)	Class 1 GW Qual. Std.
Aquifer	Sand and Gravel		•	
	Silurian Dolomite			
	Galena-Platteville			
	St. Peter Sandstone			
	Ironton-Galesville Sandstone			
	Eau Claire Sandstone			
	Mt. Simon Sandstone			
Inorganic Compounds	Antimony	(µg/L)	ND	6
	Arsenic	(µg/L)	ND - 1.1	10
	Barium	(µg/L)	30 - 32	2000
	Beryllium	(µg/L)	ND	4
	Boron	(mg/L)	NR	2
	Cadmium	(µg/L)	ND	5
	Chloride	(mg/L)	22 - 23	200
	Chromium	(µg/L)	ND	100
	Cyanide	(mg/L)	ND	0.2
	Fluoride	(mg/L)	0.746 - 1.3	4
	Iron	(mg/L)	ND - 0.027	5
	Manganese	(µg/L)	2 - 5.3	150
	Mercury	(µg/L)	ND	2
	Nickel	(µg/L)	ND	100
	Selenium	(µg/L)	ND - 1.4	50
	Sodium	(mg/L)	8.2 - 8.8	
	Sulfate	(mg/L)	60 - 66	400
	Thallium	(µg/L)	ND	2
	Total Dissolved Solids	(mg/L)	380 - 390	1200
Radiologicals	ALPHA, Gross	pCi/L	ND - 0.228	
	Radium-226	pCi/L	ND - 0.495	20
	Radium-228	pCi/L	ND - 0.103	20
	Combined Radium	pCi/L	ND - 0.598	
PFAS	PFOA	(ng/L)	ND	4
	PFOS	(ng/L)	ND	4
	SOCs ^b	(µg/L)	ND	
	VOCs ^b	(µg/L)	ND	

Notes:

^a Results from Safe Drinking Water Information System (SDWIS) Lab Sample Numbers EL02100-01, 8100569-01, 5101034-01, 0032498-01, 1041114-01, 0032498-01, 4012885-01, 0012521-01, 4011083-01

NR = No Record
 ND = Non Detect

^b Detailed laboratory results can be found in Appendix C

 Highlighted value indicates finished water concentration exceeds Class 1 Groundwater Quality Standards. In all cases, treatment is in place to reduce concentration below the standard, and routine monitoring is required.

 Highlighted value indicates finished water concentration for parameter that may be approaching the Groundwater Quality Standard or may cause water quality issues. In some cases, treatment is in place to reduce concentration below the standard, and routine monitoring is recommended.

Exhibit 3-2: Fluoride Concentration Trend



3.5 Report on the Quality of the Finished Water

An analysis of Lake Wildwood’s finished water was conducted as part of the Source Water Assessment. Table 3-3 presents a summary of the System’s finished water quality based on analytical results from 2019 to 2023. Based on the water quality sampling results shown in Table 3-3, the System’s finished water does not exceed any primary maximum contaminant levels (MCLs). Nitrate has exhibited an un concerning level of potential to progress towards the MCL.

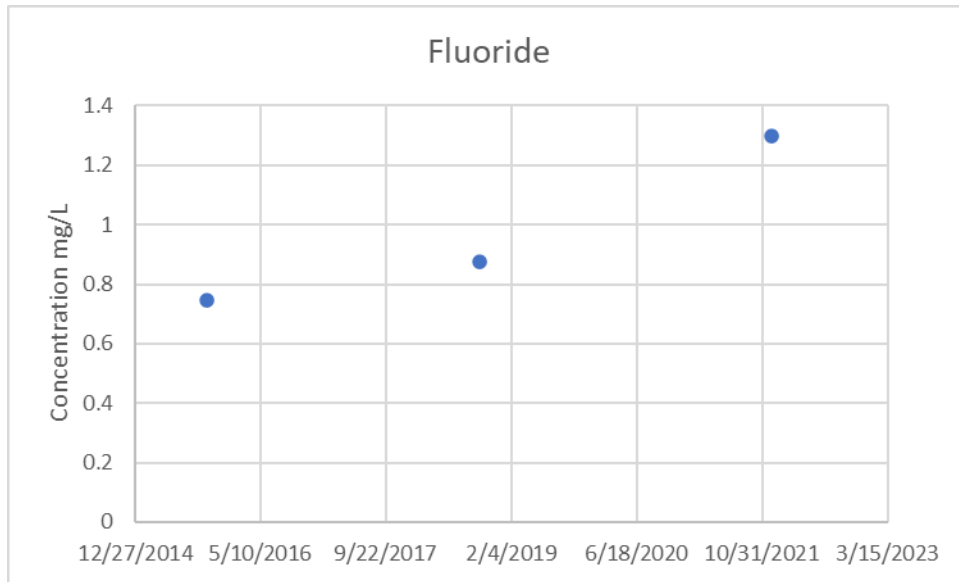
Shallow aquifers in much of Northeastern Illinois are experiencing elevated Per- and Polyfluoroalkyl Substances (PFAS) levels. The IEPA has initiated a statewide testing program to test for and monitor PFAS levels of 18 PFAS compounds in water supplies throughout the state but has not yet set enforceable drinking water standards for these compounds. Rather, it has set a health guidance level for six (6) PFAS compounds. The USEPA has recently finalized MCLs for PFOS and PFOA and four (4) other PFAS compounds, although those will not take effect until 2029. The Lake Wildwood System has no detectable PFAS levels in its finished water. The treatment processes applied in the Lake Wildwood CWS do not remove PFAS compounds, therefore the finished water sample results are representative of PFAS compounds in the source water.

The water quality reports in the form of Consumer Confidence Report can be found on the System's website at: <https://www.myutility.us/prairiepathwater/water-safety/water-quality-reports>.

Table 3-3: Finished Water Quality Summary

			Well Effluent ^a	MCLG ^b	MCL ^b
Aquifer	Sand and Gravel		☐		
	Silurian Dolomite				
	Galena-Platteville				
	St. Peter Sandstone				
	Ironton-Galesville Sandstone				
	Mt. Simon Sandstone				
IOCs	Copper	ppm	0.21 - 0.49	1.3	1.3
	Lead	ppb	1.1 - 3.1		15
	Arsenic	ppb	1.1		10
	Barium	ppm	0.03 - 0.031	2	2
	Iron	ppm	0.01		1
	Manganese	ppb	2 - 3.4	150	150
	Total Nitrate & Nitrite	ppm	NR	10	10
	Nitrate as N	ppm	3.5 - 5.8	10	10
	Fluoride	ppm	0.746 - 0.876	4	4
	Sulfate	ppm	NR		
	Selenium	ppb	1.4	50	50
	Sodium	ppm	8.7 - 8.8		
	Zinc	ppm	0.0079 - 0.008	5	5
Disinfectants	TTHMs	ppb	6.42 - 9.1		80
	HAA5	ppb	1.14 - 1.17		60
	Chlorine as Cl ₂	ppm	0.65 - 1.02	4	4
	TOC	n/a	NR		
Microbials	Turbidity	NTU	NR		1
	Turbidity (%<+ 0.3NTU)		NR		≤ 0.3
	Total Coliform Bacteria	#pos/mo	NR	1	
Radiologicals	Comb. Radium	ppm	0.598		5
	Gross ALPHA	(pCi/L)	0.228		15
	SOCs		NR		
	VOCs		NR		

Notes:

Results are from Lake Wildwood 2019 - 2023 Water Quality Reports. NR = No Record

^a The Well Effluent column reflects the water in the distribution system. ND = Non Detect

^b MCL = Maximum Contaminant Level MCLG=Maximum Contaminant Level Goal

 Highlighted value indicates finished water concentration exceeds Primary MCL for parameter.

In all cases, treatment is in place to reduce concentration below the MCL, and routine monitoring is required.

 Highlighted value indicates finished water concentration exceeds Secondary MCL for parameter.

In some cases, treatment is in place to reduce concentration below the MCL, and routine monitoring is recommended.

 Highlighted value indicates finished water concentration for parameter that may be approaching

Primary or Secondary MCL or may cause water quality issues. In some cases, treatment is in place to reduce concentration below the MCL, and routine monitoring is recommended.

3.6 Identification of Potential Sources of Contamination to the Source Water

To identify all potential sources of contamination to the source water, both land use contamination and point source contamination were investigated. The proximity of the wells to shallow water bodies was also considered.

The point sources were identified using several hazardous chemical inventory databases. A list of a select number of databases used to determine potential sources of contamination to the System's wells are as follows:

- Agency Facility Inventory and Information Search System (AFIIS) (IEPA)
- Environmental Compliance and History Online (ECHO) (USEPA)
- Tier 2 Hazardous Chemical Database (IEMA Tier 2) (IEMA)
- Illinois Underground Storage Tank Database (IUST) (ISFM)
- Leaking Underground Storage Tank Database (LUST) (IEPA)
- Site Remediation Program Database (SRP) (IEPA)
- National Priority List (NPL)
- Comprehensive Environmental Response, Compensation and Liability Information System (CERCLIS)
- Resource Conservation and Recovery Act Generator List (RCRA LQG)
- Emergency Response Notification System (ERNS)
- Facility Response Plan (FRP)
- FEMA Underground Storage Tank Listing (FEMA UST)
- Clean Construction or Demolition Debris (CCDD)
- Above Ground Storage Tank (AST)

An environmental consultant, A3 Environmental, was engaged to assist in identifying potential sources of contamination within the maximum setback zone of each well. The consultant performed a search of publicly available information from environmental contamination databases belonging to federal, state, tribal, and local sources. These databases contain site specific history and details that aid in identifying if the contaminant is a threat to the source water.

In addition to these databases, the location of oil and gas pipelines and railroad lines were also evaluated. Sites within the well's 200- and 1,000-foot setback zones were considered as possible threats to groundwater quality. As shown in Exhibit 3-3, there were no point source contaminants identified for either well within the setback zones of the well.

Exhibit 3-3: Map of Potential Sources of Contamination

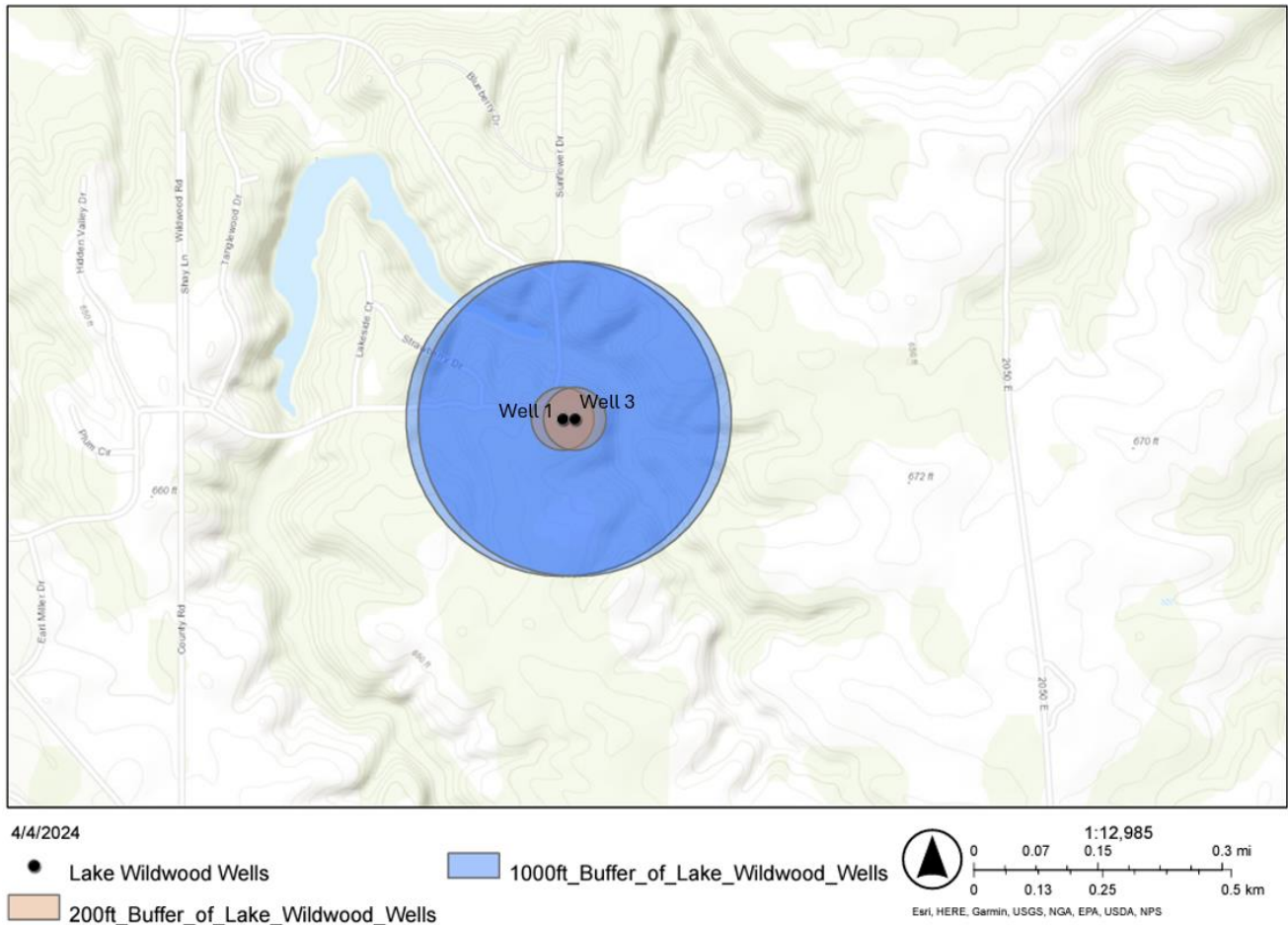

3.7 Analysis of the Source Water's Susceptibility to Contamination

The wells operated by the Lake Wildwood CWS are shallow sand and gravel wells drawing from glacial drift and overburden saturated aquifers. Shallow wells are typically more vulnerable to surface contamination than deep wells because of their lack of bedrock cover due to their proximity to the surface.

Exhibit 3-4 shows the map of geologic susceptibility along with Well 1 and Well 3. The well is located in an area with a geologic susceptibility rating of E, characterized as impermeable bedrock at 20 feet or less from the surface with till or other fine-grained material overlay. The system's well is a shallow bedrock well, so it is somewhat susceptible to contamination due to its proximity to the surface but because it is in the E rating the susceptibility is greatly decreased. Therefore, the geologic susceptibility to contamination of groundwater pumped by the well is considered low.

Exhibit 3-4: Groundwater Susceptibility

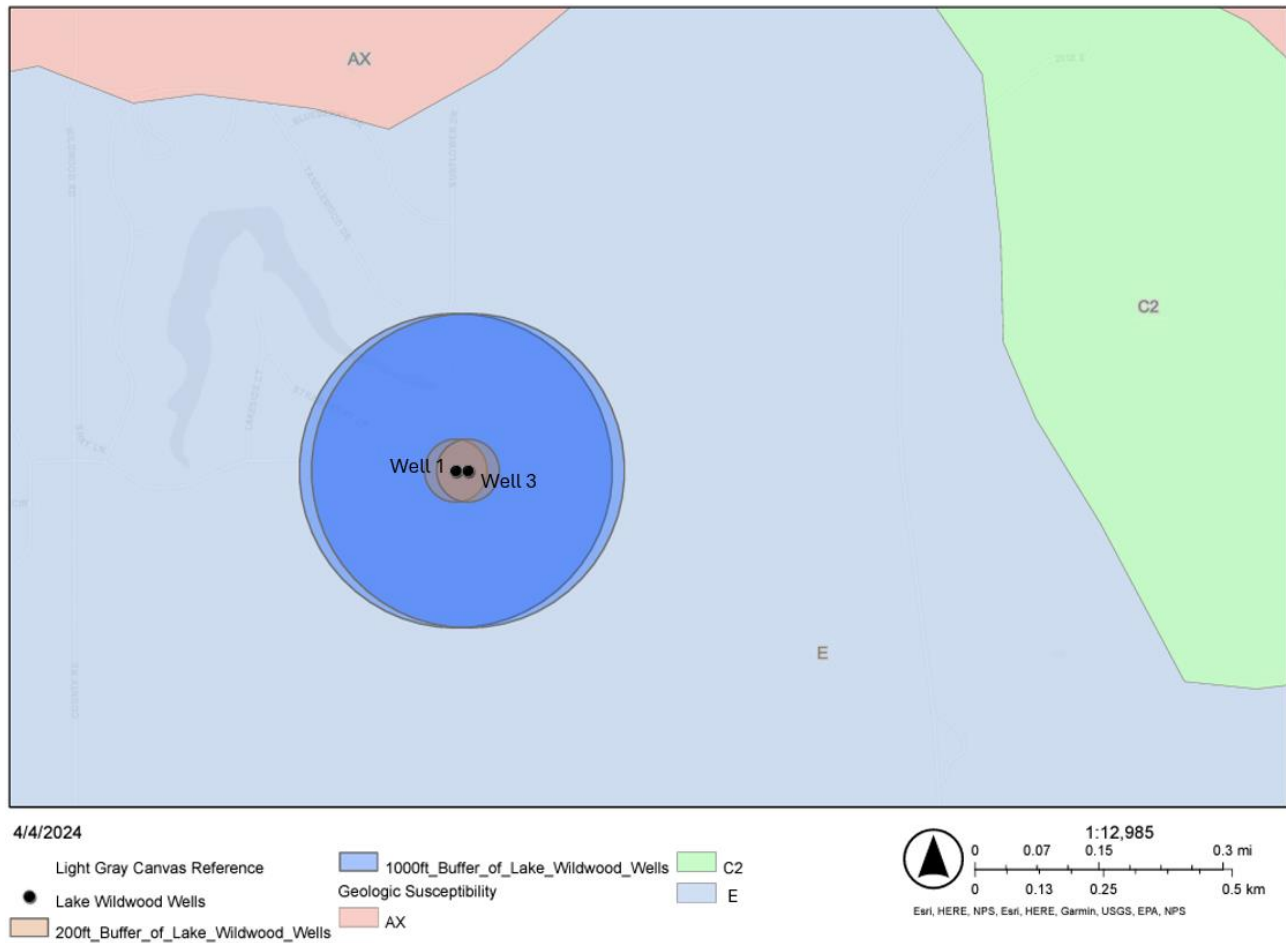

3.8 Explanation of the Community Water Supply's Efforts to Protect its Source Water

- The Illinois Environmental Protection Act provides a minimum protection zone of 200 feet for Well 1 and Well 3. These minimum protection zones are regulated by the Illinois EPA.
- The System's SCADA system monitors each well 24/7.
- The Lake Wildwood CWS maintains the Emergency Response Plan as contingency planning documents to ensure that, through emergency preparedness, the community minimizes its risk of being without safe and adequate drinking water.
- The following regulations, which contribute to source water protection are currently active in the System:
 1. Minimum Setback Zones (200 and 400 feet, as designated by Illinois EPA) (415 ILCS 5/14.1 - 14.3)
 2. Wells and Water Supply (Jo Daviess Co. Code of Ordinance, Chapter 7 Water Supply)
 3. Well Construction and Pump Installation (77 ILL ADMIN CODE PART 915, 920 and 925)
 4. Backflow and Cross-Connection Programs Required (Illinois Plumbing Code, 77 Ill. Adm. Code 890)

SECTION 5: ACTION PLAN

This section presents the System's adherence to the requirements of Section 604.325 Action Plan, which are:

In the action plan, the community water supply must identify the actions needed to achieve the community water supply's objectives determined under Section 604.320. The action plan must include the following:

- a) descriptions of all projects, programs, and activities developed by the community water supply to meet the objectives listed in Section 604.320;*
- b) the community water supply's schedule for implementing projects, programs and activities;*
- c) an identification of the necessary resources to implement the plan; and*
- d) an identification of the potential problems with and obstacles to implementing the plan.*

5.1 Projects, Programs, and Activities to Meet Objectives

To meet its Source Water Protection Objectives, the System will continue its current initiatives (as described in Section 3.8), as well as implement the projects, programs, and activities identified below. The entire Action Plan including objectives; projects, programs, and activities; schedule; necessary resources; and potential problems is presented in Table No. 5-1.

5.2 Schedule for Implementing Projects, Programs, and Activities

The schedule for implementing the projects, programs, and activities of the System's Source Water Protection Program is presented in Table No. 5-1.

5.3 Identification of Necessary Resources to Implement the Plan

The resources necessary for implementation of the plan and the specific projects, programs, and activities requiring these resources are identified in the Action Plan presented in Table No. 5-1.

5.4 Identification of Potential Problems and Obstacles in Implementing the Plan

The potential problems and obstacles in implementing the plan and the specific projects, programs, and activities requiring these resources are identified in the Action Plan presented in Table No. 5-1.

PRAIRIE PATH WATER COMPANY - LAKE WILDWOOD CWS SOURCE WATER PROTECTION PLAN (July 2024)

Category	Objective	Projects, Programs, and Activities	Schedule	Necessary Resources	Potential Problems
I. Source Water Characterization / Protection Area Delineation	A. Characterize the aquifers used by Lake Wildwood CWS as the source of water supply by identifying groundwater flow patterns, estimating hydraulic properties, and analyzing groundwater quality sampling results.	1. Review delineated maximum setback and recharge zones refine/update as necessary.	July 2029	Staff time	Limited data available
		2. Collect static and pumping water levels along with well pumping rates; Collect well performance data during well rehabilitation and testing. Analyze these data for anomalies and trends.	Annually	Staff time	Other priorities
		3. Designate source water protection areas for each of PPWC's water supply wells. For example: minimum setback zone (200 or 400 feet), maximum setback zone (1,000 feet), or recharge areas.	Completed	N/A	N/A
II. Potential Contaminant Source and Land Use Inventories	A. Use local, state, and federal data resources to identify the location and nature of potential sources of groundwater contamination and associated land uses within the source water protection areas of Lake Wildwood CWS water supply wells.	1. PPWC staff conduct visual surveys of activities within the minimum and maximum setback zones of water supply wells.	Monthly	Staff time	None
		2. Coordinate with jurisdictional authorities to monitor land use changes within the protection areas.	July 2029	Staff time	Cooperation of jurisdictions
		3. Establish program to engage local Fire Protection Authorities.	July 2029	Staff Time	Interest of jurisdictions
III. Source Water Protection Management	A. Public Engagement - Engage the community at-large and provide additional opportunities for source water protection stakeholders.	1. Public Awareness - Develop and distribute information regarding PPWC source water, including: • Newsletters • Annual Water Quality Report • Bill stuffers / Specialty mailers	Annually	Staff time	None -WQ Report must be updated for compliance
		2. Public Education - Educate community and property owners on how they can participate in PPWC's source water protection efforts.	July 2029	Staff time	Stakeholder interest
		3. Public Involvement - Consider creating local source water protection group to promote communication and collaboration on all matters pertaining to source water protection.	July 2029	Staff time	Stakeholder interest
	B. Source Water Monitoring - Continue to monitor the quality of source water as needed to characterize constituents and ensure the safety of drinking water, always seeking to identify potential future threats to source water and finished water.	1. Monitor known and emerging contaminants, including the collection of source water samples for current and emerging contaminants and the analysis of these data for anomalies and trends.	As required	Staff time	None - Must be completed for compliance
	C. Contingency Planning - Maintain and update existing emergency response plans, particularly as it pertains to groundwater contamination.	1. Update Emergency Response Plan (ERP)	Annually	Staff time	Competing priorities

PRAIRIE PATH WATER COMPANY - LAKE WILDWOOD CWS SOURCE WATER PROTECTION PLAN page 2 (July 2024)

III. Source Water Protection Management (continued)	D. Existing Regulatory - Leverage existing local, state, and federal regulations / programs that include source water protection components and incorporate into Lake Wildwood CWS's source water protection program.	1. Minimum Setback Zones (200 and 400 feet, as designated by Illinois EPA) (415 ILCS 5/14.1 - 14.3)	Ongoing	Staff time	None - State regulation
		2. Wells and Water Supply (Jo Daviess Co. Code of Ordinance, Chapter 7 Water Supply)	Ongoing	Staff time	None - local regs.
		3. Well Construction and Pump Installation (77 ILL ADMIN CODE PART 915, 920 and 925)	Ongoing	Staff time	None - local regs.
		4. Backflow and Cross-Connection Programs Required (Illinois Plumbing Code, 77 Ill. Adm. Code 890)	Ongoing	Staff time	None - State regulation
	E. New Regulatory - Consider additional programs that will contribute to protecting source water and incorporate those that are applicable into Lake Wildwood CWS's source water protection program.	1. Overlay Ordinance establishing a 1,000-foot maximum setback zone.	July 2029	Staff time	Cooperation of local jurisdiction
		2. Signage at wells and water treatment facilities	July 2029	Staff time, cost of signs	None
		3. Land acquisition / Conservation easements	July 2029	Staff time, funding	Availability of land
	F. Planning - Actively review, update, and improve all aspects of Lake Wildwood CWS's Source Water Protection Plan.	1. Participation in the Local Emergency Planning Committee (LEPC) or other local water resources planning agencies.	July 2029	Staff time	Competing priorities
		2. Support County Water Sustainability efforts (if applicable).	July 2029	Staff time	Existence of such programs
		3. Periodic review and updating of the Source Water Protection Plan Vision statement, Source Water Assessment, Objectives, and Action Plan with input from external stakeholders.	July 2029	Staff time / Consultant	None -required for compliance

SECTION 4: SOURCE WATER PROTECTION PLAN OBJECTIVES

This section presents the Apple Canyon CWS's adherence to the requirements of Section 604.320 Source Water Protection Plan Objectives, which are:

The source water protection plan must contain a list of the community water supply's objectives for protecting source water. These objectives can include meeting the requirements of any of the Sections in this Subpart, including developing a vision statement or performing a source water assessment. Objectives may also address the specific problems or issues identified in the source water assessment and should consider current and potential future issues.

4.1 Identified Concerns

The following concerns regarding the Apple Canyon CWS's source water were identified based on the source water assessment.

- Impacts of existing and potential future contamination on the Apple Canyon CWS's source water.
- Impacts of source water contamination on the Apple Canyon CWS's finished drinking water quality.
- Implications of removing existing and potential future contamination from the Apple Canyon CWS's source water to meet drinking water standards.
- Identifying and implementing effective programs and activities for protecting the Apple Canyon CWS's source water.

4.2 Objectives

Given the identified concerns, the Apple Canyon CWS developed the following SWPP objectives. These objectives provide a framework for the Apple Canyon CWS's source water protection activities. The specific activities that align with these objectives are outlined in Section 5 of this Plan.

I. Source Water Characterization / Protection Area Delineation

- A. Characterize the aquifers used by Apple Canyon CWS as the source of water supply by identifying groundwater flow patterns, estimating hydraulic properties, and analyzing groundwater quality sampling results.

II. Potential Contaminant Source and Land Use Inventories

- A. Use local, state, and federal data resources to identify the location and nature of potential sources of groundwater contamination and associated land uses within the source water protection areas of Apple Canyon CWS water supply wells.

III. Source Water Protection Management

- A. Public Engagement - Engage the community at-large and provide additional opportunities for source water protection stakeholders.
- B. Source Water Monitoring - Continue to monitor the quality of source water as needed to characterize constituents and ensure the safety of drinking water, always seeking to identify potential future threats to source water and finished water.
- C. Contingency Planning - Maintain and update existing emergency response plans, particularly as it pertains to groundwater contamination.
- D. Existing Regulatory - Leverage existing local, state, and federal regulations / programs that include source water protection components and incorporate into Apple Canyon CWS's source water protection program.
- E. New Regulatory - Consider additional programs that will contribute to protecting source water and incorporate those that are applicable into Apple Canyon CWS's source water protection program.
- F. Planning - Actively review, update, and improve all aspects of Apple Canyon CWS's Source Water Protection Plan.

APPENDIX A

Illinois Administrative Code Title 35, Subpart 604, Subpart C - Source Water Protection Plan

TITLE 35: ENVIRONMENTAL PROTECTION
SUBTITLE F: PUBLIC WATER SUPPLIES
CHAPTER I: POLLUTION CONTROL BOARD

PART 604
DESIGN, OPERATION AND MAINTENANCE CRITERIA

SUBPART C: SOURCE WATER PROTECTION PLAN

Section 604.300 Purpose

The purpose of the following requirements is to facilitate protection of source water quality and quantity.

Section 604.305 Source Water Protection Plan Requirement and Contents

Each community water supply that treats surface or groundwater as a primary or emergency supply of water must develop a source water protection plan that contains the following minimum elements:

- a) a vision statement as set forth in Section 604.310;
- b) a source water assessment as set forth in Section 604.315;
- c) the objectives set forth in Section 604.320; and
- d) an action plan as set forth in Section 604.325.

Section 604.310 Vision Statement

The vision statement must include the following:

- a) the community water supply's policy and commitment to protecting source water;
- b) an explanation of the community water supply's resources to protect source water;
- c) an explanation of the barriers to protecting source water; and
- d) the names of the individuals who developed the vision statement.

Section 604.315 Source Water Assessment

- a) The source water assessment must contain the following information:
 - 1) statement of the importance of the source water;

- 2) a list of water supplies that obtain water from this community water supply;
 - 3) delineation of all sources of water used by the community water supply, including:
 - A) for surface water, description of the watershed, map of the watershed, and intake locations;
 - B) for groundwater, the well identification number, well description, well status and well depth; a description of setback zones, and a description of the aquifer for each well;
 - 4) a report on the quality of the source water for all sources of water delineated in subsection (a)(3), including:
 - A) when and where samples used to determine the quality of the source water were taken. These samples must be tested by a certified laboratory; and
 - B) the certified laboratory's results;
 - 5) a report on the quality of the finished water;
 - 6) identification of potential sources of contamination to the source water;
 - 7) analysis of the source water's susceptibility to contamination; and
 - 8) explanation of the community water supply's efforts to protect its source water.
- b) Upon request, the Agency will provide technical assistance to a community water supply in conducting the source water assessment.
- b) A community water supply may use a Source Water Assessment Program Fact Sheet prepared by the Agency to fulfill the requirements of this Section.

Section 604.320 Source Water Protection Plan Objectives

The source water protection plan must contain a list of the community water supply's objectives for protecting source water. These objectives can include meeting the requirements of any of the Sections in this Subpart, including developing a vision statement or performing a source water

assessment. Objectives may also address the specific problems or issues identified in the source water assessment and should consider current and potential future issues.

Section 604.325 Action Plan

In the action plan, the community water supply must identify the actions needed to achieve the community water supply's objectives determined under Section 604.320. The action plan must include the following:

- a) descriptions of all projects, programs, and activities developed by the community water supply to meet the objectives listed in Section 604.320;
- c) the community water supply's schedule for implementing projects, programs and activities;
- c) an identification of the necessary resources to implement the plan; and
- d) an identification of the potential problems with and obstacles to implementing the plan.

Section 604.330 Submission

- a) A community water supply that first commenced construction after July 26, 2019, must develop and submit a source water protection plan simultaneously with the construction permit application.
- b) A community water supply in existence as of July 26, 2019, must develop and submit to the Agency for approval a source water protection plan within the following time frame after July 26, 2019:
 - 1) within 3 years, for a community water supply serving a population greater than 50,000 persons;
 - 2) within 4 years, for a community water supply serving a population of greater than 3,000 but less than or equal to 49,999 persons; or
 - 3) within 5 years, for a community water supply serving a population of less than or equal to 2,999 persons.
- d) An existing community water supply that anticipates using a new source of water for its supply must develop and submit a revised source water protection plan simultaneously with the construction permit application.

Section 604.335 Agency Approval

The Agency, not later than 45 days after the receipt of the source water protection plan, will either approve or disapprove the plan. If the Agency takes no action within the 45 days, the community water supply may deem the plan approved. A community water supply may waive the requirement that the Agency take an action within the 45 days by so advising the Agency in writing.

Section 604.340 Evaluation and Revision

The community water supply must review, and revise as necessary, its source water protection plan no less frequently than every five years. If the community water supply revises its source water protection plan, it must submit the plan to the Agency for approval under Section 604.335.

APPENDIX B

Well Information

Water Well for Commercial Operation	Top	Bottom
clay with layers of sand	0	190
sand & fine gravel	190	275
Total Depth		275
Casing: 12" STEEL 49.56# from -2' to 243'		
Screen: 30' of 12" diameter .06 slot		
Water from drift at 190' to 275'.		
Static level 140' below casing top which is 2' above GL		
Pumping level 150' when pumping at 500 gpm for 8 hours		
Driller's Log filed		
Sample set # 55605 (0' - 276')		
Owner Address: Box 266 Varna, IL		
Location source: Location from permit		

Permit Date: January 1, 1968

Permit #: NF 4535

COMPANY Miller, J.P. Artesian Well Co.

FARM Equitable Development,

DATE DRILLED August 6, 1968

NO. 1

ELEVATION 0

COUNTY NO. 00135

LOCATION 115'N 110'W SE/c NE

LATITUDE 41.079228

LONGITUDE -89.259303

COUNTY Marshall

API 121230013500

7 - 30N - 1W

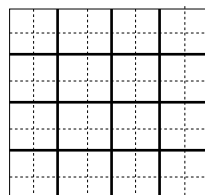

APPENDIX C

Representative Source Water Quality Analytical Lab Reports

Lake Wildwood Water System

Sampling Location	Date Sampled	All results reported as Nanograms per liter(ng/L)				Result Below Health Advisory Level?
		PFOS	PFOA	Combined PFOS + PFOA	EPA Health Advisory Level	
Entry Point Well 1	5/18/2020	ND	ND	ND	70	Y
Entry Point Well 3	5/18/2020	ND	ND	ND	70	Y

- **PFOS** – Perfluorooctane Sulfonate
- **PFOA** – Perfluorooctanoic Acid
- **Health Advisory Level (HAL)** – To provide Americans, including the most sensitive populations, with a margin of protection from a lifetime of exposure to PFOA and PFOS from drinking water, EPA established the health advisory levels at 70 parts per trillion.
- **Ng/L** – Nanograms per liter(ng/L) which equals Parts per trillion (ppt) – One part per trillion corresponds to one minute in 2,000,000 years, or a single penny in \$10,000,000,000.
- **ND (No Detect)** - Laboratory analysis indicates that the constituent is not present. 2.0 ng/L is the minimum level the lab is reporting a detection for these parameters. The ND (No Detect) represented in the table is indicating there was no detection.

Drinking Water Branch

Chem/Rad Sample Results

[Return
Links](#)

[Chem/Rad
Samples](#)

[Analyte List](#)

[Water System
Detail](#)

[Water
Systems](#)

[Water System
Search](#)

[County Map](#)

[Glossary](#)

Water System No. :	IL0855150	Federal Type :	C
Water System Name :	PRAIRIE PATH WATER COMPANY-APPLE CANYON	State Type :	C
Principal County Served :	JO DAVIESS	Primary Source :	GW
Status :	A	Activity Date :	01-01-1970
Lab Sample No. :	2103985-01	Collection Date :	10-29-2012

This list displays sample/results of all non-microbial analytes (TSAANLYT.TYPE_CODE <> MOR) associated to the selected sample. Results for Microbial Analytes are not included.

Analyte Code	Analyte Name	Method Code	Less than Indicator	Level Type	Reporting Level	Concentration level	Monitoring Period Begin Date	Monitoring Period End Date
1005	ARSENIC	200.8	Y	MRL	1 UG/L		01-01-2011	12-31-2013
1010	BARIUM	200.8			0	110 UG/L	01-01-2011	12-31-2013
1015	CADMIUM	200.8	Y	MRL	1 UG/L		01-01-2011	12-31-2013
1020	CHROMIUM	200.8	Y	MRL	4 UG/L		01-01-2011	12-31-2013
1024	CYANIDE	4500CN-C	Y	MRL	0.2 MG/L		01-01-2011	12-31-2019
1025	FLUORIDE	4500F-C			0	0.702 MG/L	01-01-2011	12-31-2013
1028	IRON	200.7			0	0.45 MG/L	01-01-2011	12-31-2013
1032	MANGANESE	200.8			0	8 UG/L	01-01-2011	12-31-2013
1035	MERCURY	200.8	Y	MRL	0.2 UG/L		01-01-2011	12-31-2013
1036	NICKEL	200.8	Y	MRL	5 UG/L		01-01-2011	12-31-2013
1045	SELENIUM	200.8	Y	MRL	5 UG/L		01-01-2011	12-31-2013
1052	SODIUM	200.7			0	2.4 MG/L	01-01-2011	12-31-2013
1055	SULFATE	300.0			0	21 MG/L	01-01-2011	12-31-2013
1074	ANTIMONY, TOTAL	200.8	Y	MRL	3 UG/L		01-01-2011	12-31-2013
1075	BERYLLIUM, TOTAL	200.8	Y	MRL	1 UG/L		01-01-2011	12-31-2013
1085	THALLIUM, TOTAL	200.8	Y	MRL	2 UG/L		01-01-2011	12-31-2013
1095	ZINC	200.8			0	12 UG/L	01-01-2011	12-31-2013

Total Number of Records Fetched = 17

Drinking Water Branch

Chem/Rad Sample Results

[Return
Links](#)

[Chem/Rad
Samples](#)

[Analyte List](#)

[Water System
Detail](#)

[Water
Systems](#)

[Water System
Search](#)

[County Map](#)

[Glossary](#)

Water System No. :	IL0855150	Federal Type :	C
Water System Name :	PRAIRIE PATH WATER COMPANY-APPLE CANYON	State Type :	C
Principal County Served :	JO DAVIESS	Primary Source :	GW
Status :	A	Activity Date :	01-01-1970
Lab Sample No. :	2103985-02	Collection Date :	10-29-2012

This list displays sample/results of all non-microbial analytes (TSAANLYT.TYPE_CODE <> MOR) associated to the selected sample. Results for Microbial Analytes are not included.

Analyte Code	Analyte Name	Method Code	Less than Indicator	Level Type	Reporting Level	Concentration level	Monitoring Period Begin Date	Monitoring Period End Date
1005	ARSENIC	200.8	Y	MRL	1 UG/L		01-01-2011	12-31-2013
1010	BARIUM	200.8			0	75 UG/L	01-01-2011	12-31-2013
1015	CADMIUM	200.8	Y	MRL	1 UG/L		01-01-2011	12-31-2013
1020	CHROMIUM	200.8	Y	MRL	4 UG/L		01-01-2011	12-31-2013
1024	CYANIDE	4500CN-C	Y	MRL	0.2 MG/L		01-01-2011	12-31-2019
1025	FLUORIDE	4500F-C			0	1.3 MG/L	01-01-2011	12-31-2013
1028	IRON	200.7			0	0.54 MG/L	01-01-2011	12-31-2013
1032	MANGANESE	200.8			0	10 UG/L	01-01-2011	12-31-2013
1035	MERCURY	200.8	Y	MRL	0.2 UG/L		01-01-2011	12-31-2013
1036	NICKEL	200.8			0	6.2 UG/L	01-01-2011	12-31-2013
1045	SELENIUM	200.8	Y	MRL	5 UG/L		01-01-2011	12-31-2013
1052	SODIUM	200.7			0	5.7 MG/L	01-01-2011	12-31-2013
1055	SULFATE	300.0			0	13 MG/L	01-01-2011	12-31-2013
1074	ANTIMONY, TOTAL	200.8	Y	MRL	3 UG/L		01-01-2011	12-31-2013
1075	BERYLLIUM, TOTAL	200.8	Y	MRL	1 UG/L		01-01-2011	12-31-2013
1085	THALLIUM, TOTAL	200.8	Y	MRL	2 UG/L		01-01-2011	12-31-2013
1095	ZINC	200.8	Y	MRL	6 UG/L		01-01-2011	12-31-2013

Total Number of Records Fetched = 17

Drinking Water Branch

Chem/Rad Sample Results

[Return
Links](#)

[Chem/Rad
Samples](#)

[Analyte List](#)

[Water System
Detail](#)

[Water
Systems](#)

[Water System
Search](#)

[County Map](#)

[Glossary](#)

Water System No. :	IL0855150	Federal Type :	C
Water System Name :	PRAIRIE PATH WATER COMPANY-APPLE CANYON	State Type :	C
Principal County Served :	JO DAVIESS	Primary Source :	GW
Status :	A	Activity Date :	01-01-1970
Lab Sample No. :	5102164-01	Collection Date :	10-13-2015

This list displays sample/results of all non-microbial analytes (TSAANLYT.TYPE_CODE <> MOR) associated to the selected sample. Results for Microbial Analytes are not included.

Analyte Code	Analyte Name	Method Code	Less than Indicator	Level Type	Reporting Level	Concentration level	Monitoring Period Begin Date	Monitoring Period End Date
1005	ARSENIC	200.8	Y	MRL	1 UG/L		01-01-2014	12-31-2016
1010	BARIUM	200.8			0	88 UG/L	01-01-2014	12-31-2016
1015	CADMIUM	200.8	Y	MRL	1 UG/L		01-01-2014	12-31-2016
1020	CHROMIUM	200.8	Y	MRL	4 UG/L		01-01-2014	12-31-2016
1024	CYANIDE	4500CN-C	Y	MRL	0.2 MG/L		01-01-2011	12-31-2019
1025	FLUORIDE	4500F-C			0	1.05 MG/L	01-01-2014	12-31-2016
1028	IRON	200.7			0	0.79 MG/L	01-01-2014	12-31-2016
1032	MANGANESE	200.8			0	7.6 UG/L	01-01-2014	12-31-2016
1035	MERCURY	200.8	Y	MRL	0.2 UG/L		01-01-2014	12-31-2016
1036	NICKEL	200.8	Y	MRL	5 UG/L		01-01-2014	12-31-2016
1045	SELENIUM	200.8	Y	MRL	5 UG/L		01-01-2014	12-31-2016
1052	SODIUM	200.7			0	5.5 MG/L	01-01-2014	12-31-2016
1055	SULFATE	300.0			0	24 MG/L	01-01-2014	12-31-2016
1074	ANTIMONY, TOTAL	200.8	Y	MRL	3 UG/L		01-01-2014	12-31-2016
1075	BERYLLIUM, TOTAL	200.8	Y	MRL	1 UG/L		01-01-2014	12-31-2016
1085	THALLIUM, TOTAL	200.8	Y	MRL	1 UG/L		01-01-2014	12-31-2016
1095	ZINC	200.8	Y	MRL	6 UG/L		01-01-2014	12-31-2016

Total Number of Records Fetched = 17

Drinking Water Branch

Chem/Rad Sample Results

[Return
Links](#)

[Chem/Rad
Samples](#)

[Analyte List](#)

[Water System
Detail](#)

[Water
Systems](#)

[Water System
Search](#)

[County Map](#)

[Glossary](#)

Water System No. :	IL0855150	Federal Type :	C
Water System Name :	PRAIRIE PATH WATER COMPANY-APPLE CANYON	State Type :	C
Principal County Served :	JO DAVIESS	Primary Source :	GW
Status :	A	Activity Date :	01-01-1970
Lab Sample No. :	5102164-02	Collection Date :	10-13-2015

This list displays sample/results of all non-microbial analytes (TSAANLYT.TYPE_CODE <> MOR) associated to the selected sample. Results for Microbial Analytes are not included.

Analyte Code	Analyte Name	Method Code	Less than Indicator	Level Type	Reporting Level	Concentration level	Monitoring Period Begin Date	Monitoring Period End Date
1005	ARSENIC	200.8	Y	MRL	1 UG/L		01-01-2014	12-31-2016
1010	BARIUM	200.8			0	62 UG/L	01-01-2014	12-31-2016
1015	CADMIUM	200.8	Y	MRL	1 UG/L		01-01-2014	12-31-2016
1020	CHROMIUM	200.8	Y	MRL	4 UG/L		01-01-2014	12-31-2016
1024	CYANIDE	4500CN-C	Y	MRL	0.2 MG/L		01-01-2011	12-31-2019
1025	FLUORIDE	4500F-C			0	1.01 MG/L	01-01-2014	12-31-2016
1028	IRON	200.7			0	0.54 MG/L	01-01-2014	12-31-2016
1032	MANGANESE	200.8			0	7.2 UG/L	01-01-2014	12-31-2016
1035	MERCURY	200.8	Y	MRL	0.2 UG/L		01-01-2014	12-31-2016
1036	NICKEL	200.8	Y	MRL	5 UG/L		01-01-2014	12-31-2016
1045	SELENIUM	200.8	Y	MRL	5 UG/L		01-01-2014	12-31-2016
1052	SODIUM	200.7			0	5.9 MG/L	01-01-2014	12-31-2016
1055	SULFATE	300.0			0	14 MG/L	01-01-2014	12-31-2016
1074	ANTIMONY, TOTAL	200.8	Y	MRL	3 UG/L		01-01-2014	12-31-2016
1075	BERYLLIUM, TOTAL	200.8	Y	MRL	1 UG/L		01-01-2014	12-31-2016
1085	THALLIUM, TOTAL	200.8	Y	MRL	1 UG/L		01-01-2014	12-31-2016
1095	ZINC	200.8	Y	MRL	6 UG/L		01-01-2014	12-31-2016

Total Number of Records Fetched = 17

Drinking Water Branch

Chem/Rad Sample Results

[Return
Links](#)

[Chem/Rad
Samples](#)

[Analyte List](#)

[Water System
Detail](#)

[Water
Systems](#)

[Water System
Search](#)

[County Map](#)

[Glossary](#)

Water System No. :	IL0855150	Federal Type :	C
Water System Name :	PRAIRIE PATH WATER COMPANY-APPLE CANYON	State Type :	C
Principal County Served :	JO DAVIESS	Primary Source :	GW
Status :	A	Activity Date :	01-01-1970
Lab Sample No. :	8104678-01	Collection Date :	10-23-2018

This list displays sample/results of all non-microbial analytes (TSAANLYT.TYPE_CODE <> MOR) associated to the selected sample. Results for Microbial Analytes are not included.

Analyte Code	Analyte Name	Method Code	Less than Indicator	Level Type	Reporting Level	Concentration level	Monitoring Period Begin Date	Monitoring Period End Date
1005	ARSENIC	200.8	Y	MRL	1 UG/L		01-01-2017	12-31-2019
1010	BARIUM	200.8			0	110 UG/L	01-01-2017	12-31-2019
1015	CADMIUM	200.8	Y	MRL	1 UG/L		01-01-2017	12-31-2019
1017	CHLORIDE	300.0			0	2.9 MG/L	01-01-2017	12-31-2019
1020	CHROMIUM	200.8	Y	MRL	5 UG/L		01-01-2017	12-31-2019
1024	CYANIDE	335.4	Y	MRL	0.2 MG/L		01-01-2011	12-31-2019
1025	FLUORIDE	4500F-C			0	0.534 MG/L	01-01-2017	12-31-2019
1028	IRON	200.7			0	0.27 MG/L	01-01-2017	12-31-2019
1031	MAGNESIUM	200.7			0	36 MG/L		
1032	MANGANESE	200.8			0	4.9 UG/L	01-01-2017	12-31-2019
1035	MERCURY	200.8	Y	MRL	0.2 UG/L		01-01-2017	12-31-2019
1036	NICKEL	200.8	Y	MRL	5 UG/L		01-01-2017	12-31-2019
1045	SELENIUM	200.8	Y	MRL	2 UG/L		01-01-2017	12-31-2019
1052	SODIUM	200.7			0	4.2 MG/L	01-01-2017	12-31-2019
1055	SULFATE	300.0			0	20 MG/L	01-01-2017	12-31-2019
1074	ANTIMONY, TOTAL	200.8	Y	MRL	3 UG/L		01-01-2017	12-31-2019
1075	BERYLLIUM, TOTAL	200.8	Y	MRL	1 UG/L		01-01-2017	12-31-2019
1085	THALLIUM, TOTAL	200.8	Y	MRL	2 UG/L		01-01-2017	12-31-2019
1095	ZINC	200.8	Y	MRL	6 UG/L		01-01-2017	12-31-2019
1915	HARDNESS, TOTAL (AS CaCO3)	2340B			0	280 MG/L	01-01-2017	12-31-2019
1919	CALCIUM	200.7	N		0	53 MG/L	01-01-2017	12-31-2019
1927	ALKALINITY, TOTAL	2320B			0	270 MG/L	01-01-2017	12-31-2019
1930	TDS	2540C			0	270 MG/L	01-01-2017	12-31-2019

Total Number of Records Fetched = 23

Drinking Water Branch

Chem/Rad Sample Results

[Return
Links](#)

[Chem/Rad
Samples](#)

[Analyte List](#)

[Water System
Detail](#)

[Water
Systems](#)

[Water System
Search](#)

[County Map](#)

[Glossary](#)

Water System No. :	IL0855150	Federal Type :	C
Water System Name :	PRAIRIE PATH WATER COMPANY-APPLE CANYON	State Type :	C
Principal County Served :	JO DAVIESS	Primary Source :	GW
Status :	A	Activity Date :	01-01-1970
Lab Sample No. :	EL01848-01	Collection Date :	12-07-2021

This list displays sample/results of all non-microbial analytes (TSAANLYT.TYPE_CODE <> MOR) associated to the selected sample. Results for Microbial Analytes are not included.

Analyte Code	Analyte Name	Method Code	Less than Indicator	Level Type	Reporting Level	Concentration level	Monitoring Period Begin Date	Monitoring Period End Date
1005	ARSENIC	200.8	Y	MRL	1 UG/L		01-01-2020	12-31-2022
1010	BARIUM	200.8			0	120 UG/L	01-01-2020	12-31-2022
1015	CADMIUM	200.8	Y	MRL	1 UG/L		01-01-2020	12-31-2022
1017	CHLORIDE	300.0			0	3.1 MG/L	01-01-2020	12-31-2022
1020	CHROMIUM	200.8	Y	MRL	4 UG/L		01-01-2020	12-31-2022
1024	CYANIDE	335.4	Y	MRL	0.2 MG/L		01-01-2020	12-31-2028
1025	FLUORIDE	4500F-C			0	0.43 MG/L	01-01-2020	12-31-2022
1028	IRON	200.7			0	0.34 MG/L	01-01-2020	12-31-2022
1031	MAGNESIUM	200.7			0	36 MG/L		
1032	MANGANESE	200.8			0	5 UG/L	01-01-2020	12-31-2022
1035	MERCURY	200.8	Y	MRL	0.2 UG/L		01-01-2020	12-31-2022
1036	NICKEL	200.8	Y	MRL	5 UG/L		01-01-2020	12-31-2022
1045	SELENIUM	200.8			0	1.2 UG/L	01-01-2020	12-31-2022
1052	SODIUM	200.7			0	4.4 MG/L	01-01-2020	12-31-2022
1055	SULFATE	300.0			0	17 MG/L	01-01-2020	12-31-2022
1074	ANTIMONY, TOTAL	200.8	Y	MRL	3 UG/L		01-01-2020	12-31-2022
1075	BERYLLIUM, TOTAL	200.8	Y	MRL	1 UG/L		01-01-2020	12-31-2022
1085	THALLIUM, TOTAL	200.8	Y	MRL	1 UG/L		01-01-2020	12-31-2022
1095	ZINC	200.8			0	19 UG/L	01-01-2020	12-31-2022
1915	HARDNESS, TOTAL (AS CaCO3)	2340B			0	290 MG/L	01-01-2020	12-31-2022
1919	CALCIUM	200.7			0	56 MG/L	01-01-2020	12-31-2022
1927	ALKALINITY, TOTAL	2320B			0	270 MG/L	01-01-2020	12-31-2022
1930	TDS	2540C			0	360 MG/L	01-01-2020	12-31-2022

Total Number of Records Fetched = 23

Drinking Water Branch

Chem/Rad Sample Results

[Return
Links](#)

[Chem/Rad
Samples](#)

[Analyte List](#)

[Water System
Detail](#)

[Water
Systems](#)

[Water System
Search](#)

[County Map](#)

[Glossary](#)

Water System No. :	IL0855150	Federal Type :	C
Water System Name :	PRAIRIE PATH WATER COMPANY-APPLE CANYON	State Type :	C
Principal County Served :	JO DAVIESS	Primary Source :	GW
Status :	A	Activity Date :	01-01-1970
Lab Sample No. :	EL01848-02	Collection Date :	12-07-2021

This list displays sample/results of all non-microbial analytes (TSAANLYT.TYPE_CODE <> MOR) associated to the selected sample. Results for Microbial Analytes are not included.

Analyte Code	Analyte Name	Method Code	Less than Indicator	Level Type	Reporting Level	Concentration level	Monitoring Period Begin Date	Monitoring Period End Date
1005	ARSENIC	200.8	Y	MRL	1 UG/L			
1010	BARIUM	200.8			0	67 UG/L		
1015	CADMIUM	200.8	Y	MRL	1 UG/L			
1017	CHLORIDE	300.0	Y	MRL	1 MG/L			
1020	CHROMIUM	200.8	Y	MRL	4 UG/L			
1024	CYANIDE	335.4	Y	MRL	0.2 MG/L			
1025	FLUORIDE	4500F-C			0	0.635 MG/L		
1028	IRON	200.7			0	0.53 MG/L		
1031	MAGNESIUM	200.7			0	34 MG/L		
1032	MANGANESE	200.8			0	10 UG/L		
1035	MERCURY	200.8	Y	MRL	0.2 UG/L			
1036	NICKEL	200.8	Y	MRL	5 UG/L			
1045	SELENIUM	200.8	Y	MRL	1 UG/L			
1052	SODIUM	200.7			0	4 MG/L		
1055	SULFATE	300.0			0	11 MG/L		
1074	ANTIMONY, TOTAL	200.8	Y	MRL	3 UG/L			
1075	BERYLLIUM, TOTAL	200.8	Y	MRL	1 UG/L			
1085	THALLIUM, TOTAL	200.8	Y	MRL	1 UG/L			
1095	ZINC	200.8	Y	MRL	6 UG/L			
1915	HARDNESS, TOTAL (AS CaCO3)	2340B			0	300 MG/L		
1919	CALCIUM	200.7			0	63 MG/L		
1927	ALKALINITY, TOTAL	2320B			0	280 MG/L		
1930	TDS	2540C			0	280 MG/L		

Total Number of Records Fetched = 23

Drinking Water Branch

Chem/Rad Sample Results

[Return Links](#)

[Chem/Rad Samples](#)

[Analyte List](#)

[Water System Detail](#)

[Water Systems](#)

[Water System Search](#)

[County Map](#)

[Glossary](#)

Water System No. :	IL0855150	Federal Type :	C
Water System Name :	PRAIRIE PATH WATER COMPANY-APPLE CANYON	State Type :	C
Principal County Served :	JO DAVIESS	Primary Source :	GW
Status :	A	Activity Date :	01-01-1970
Lab Sample No. :	0023214-01	Collection Date :	02-18-2020

This list displays sample/results of all non-microbial analytes (TSAANLYT.TYPE_CODE <> MOR) associated to the selected sample. Results for Microbial Analytes are not included.

Analyte Code	Analyte Name	Method Code	Less than Indicator	Level Type	Reporting Level	Concentration level	Monitoring Period Begin Date	Monitoring Period End Date
1024	CYANIDE	335.4	Y	MRL	0.2 MG/L		01-01-2020	12-31-2028
2005	ENDRIN	525.2	Y	MRL	0.1 UG/L		01-01-2020	12-31-2028
2010	BHC-GAMMA	525.2	Y	MRL	0.1 UG/L		01-01-2020	12-31-2028
2015	METHOXYCHLOR	525.2	Y	MRL	0.1 UG/L		01-01-2020	12-31-2028
2020	TOXAPHENE	525.2	Y	MRL	1 UG/L		01-01-2020	12-31-2028
2021	CARBARYL	531.1	Y	MRL	2 UG/L			
2022	METHOMYL	531.1	Y	MRL	0.5 UG/L			
2031	DALAPON	515.3	Y	MRL	5 UG/L		01-01-2020	12-31-2028
2032	DIQUAT	549.2	Y	MRL	2 UG/L		01-01-2020	12-31-2028
2033	ENDOTHALL	548.1	Y	MRL	9 UG/L		01-01-2020	12-31-2028
2035	DI(2-ETHYLHEXYL) ADIPATE	525.2	Y	MRL	0.6 UG/L		01-01-2020	12-31-2028
2036	OXAMYL	531.1	Y	MRL	2 UG/L		01-01-2020	12-31-2028
2037	SIMAZINE	525.2	Y	MRL	0.35 UG/L		01-01-2020	12-31-2028
2039	DI(2-ETHYLHEXYL) PHTHALATE	525.2	Y	MRL	1.8 UG/L		01-01-2020	12-31-2028
2040	PICLORAM	515.3	Y	MRL	1 UG/L		01-01-2020	12-31-2028
2041	DINOSEB	515.3	Y	MRL	1 UG/L		01-01-2020	12-31-2028
2042	HEXACHLOROCYCLOPENTADIENE	525.2	Y	MRL	0.5 UG/L		01-01-2020	12-31-2028
2046	CARBOFURAN	531.1	Y	MRL	0.9 UG/L		01-01-2020	12-31-2028
2050	ATRAZINE	525.2	Y	MRL	0.3 UG/L		01-01-2020	12-31-2028
2051	LASSO	525.2	Y	MRL	0.2 UG/L		01-01-2020	12-31-2028
2065	HEPTACHLOR	525.2	Y	MRL	0.04 UG/L		01-01-2020	12-31-2028
2066	3-HYDROXYCARBOFURAN	531.1	Y	MRL	1 UG/L			
2067	HEPTACHLOR EPOXIDE	525.2	Y	MRL	0.02 UG/L		01-01-2020	12-31-2028
2070	DIELDRIN	525.2	Y	MRL	0.25 UG/L		01-01-2020	12-31-2028
2077	PROPACHLOR	525.2	Y	MRL	0.5 UG/L			
2105	2,4-D	515.3	Y	MRL	1 UG/L		01-01-2020	12-31-2028
2110	2,4,5-TP	515.3	Y	MRL	1 UG/L		01-01-2020	12-31-2028
2251	METHYL TERT-BUTYL ETHER	524.2	Y	MRL	0.5 UG/L			
2274	HEXACHLOROBENZENE	525.2	Y	MRL	0.1 UG/L		01-01-2020	12-31-2028
2306	BENZO(A)PYRENE	550	Y	MRL	0.1 UG/L		01-01-2020	12-31-2028
2326	PENTACHLOROPHENOL	515.3	Y	MRL	0.4 UG/L		01-01-2020	12-31-2028
2356	ALDRIN	525.2	Y	MRL	0.25 UG/L		01-01-2020	12-31-2028
2378	1,2,4-TRICHLOROBENZENE	524.2	Y	MRL	0.5 UG/L		01-01-2020	12-31-2025
2380	CIS-1,2-DICHLOROETHYLENE	524.2	Y	MRL	0.5 UG/L		01-01-2020	12-31-2025
2383	TOTAL POLYCHLORINATED BIPHENYLS (PCB)	525.2	Y	MRL	0.1 UG/L		01-01-2020	12-31-2028
2440	DICAMBA	515.3	Y	MRL	0.3 UG/L			
2775	TOTAL DDT	525.2	Y	MRL	1 UG/L		01-01-2020	12-31-2028
2931	1,2-DIBROMO-3-CHLOROPROPANE	504.1	Y	MRL	0.02 UG/L		01-01-2020	12-31-2028
2946	ETHYLENE DIBROMIDE	504.1	Y	MRL	0.01 UG/L		01-01-2020	12-31-2028
2955	XYLENES, TOTAL	524.2	Y	MRL	0.5 UG/L		01-01-2020	12-31-2025
2959	CHLORDANE	525.2	Y	MRL	0.2 UG/L		01-01-2020	12-31-2028
2964	DICHLOROMETHANE	524.2	Y	MRL	0.5 UG/L		01-01-2020	12-31-2025

2968	O-DICHLOROBENZENE	524.2	Y	MRL	0.5 UG/L		01-01-2020	12-31-2025
2969	P-DICHLOROBENZENE	524.2	Y	MRL	0.5 UG/L		01-01-2020	12-31-2025
2976	VINYL CHLORIDE	524.2	Y	MRL	0.5 UG/L		01-01-2020	12-31-2025
2977	1,1-DICHLOROETHYLENE	524.2	Y	MRL	0.5 UG/L		01-01-2020	12-31-2025
2979	TRANS-1,2-DICHLOROETHYLENE	524.2	Y	MRL	0.5 UG/L		01-01-2020	12-31-2025
2980	1,2-DICHLOROETHANE	524.2	Y	MRL	0.5 UG/L		01-01-2020	12-31-2025
2981	1,1,1-TRICHLOROETHANE	524.2	Y	MRL	0.5 UG/L		01-01-2020	12-31-2025
2982	CARBON TETRACHLORIDE	524.2	Y	MRL	0.5 UG/L		01-01-2020	12-31-2025
2983	1,2-DICHLOROPROPANE	524.2	Y	MRL	0.5 UG/L		01-01-2020	12-31-2025
2984	TRICHLOROETHYLENE	524.2	Y	MRL	0.5 UG/L		01-01-2020	12-31-2025
2985	1,1,2-TRICHLOROETHANE	524.2	Y	MRL	0.5 UG/L		01-01-2020	12-31-2025
2987	TETRACHLOROETHYLENE	524.2	Y	MRL	0.5 UG/L		01-01-2020	12-31-2025
2989	CHLOROBENZENE	524.2	Y	MRL	0.5 UG/L		01-01-2020	12-31-2025
2990	BENZENE	524.2	Y	MRL	0.5 UG/L		01-01-2020	12-31-2025
2991	TOLUENE	524.2	Y	MRL	0.5 UG/L		01-01-2020	12-31-2025
2992	ETHYLBENZENE	524.2	Y	MRL	0.5 UG/L		01-01-2020	12-31-2025
2996	STYRENE	524.2	Y	MRL	0.5 UG/L		01-01-2020	12-31-2025

Total Number of Records Fetched = 59

Drinking Water Branch

Chem/Rad Sample Results

[Return Links](#)

[Chem/Rad Samples](#)

[Analyte List](#)

[Water System Detail](#)

[Water Systems](#)

[Water System Search](#)

[County Map](#)

[Glossary](#)

Water System No. :	IL0855150	Federal Type :	C
Water System Name :	PRAIRIE PATH WATER COMPANY-APPLE CANYON	State Type :	C
Principal County Served :	JO DAVIESS	Primary Source :	GW
Status :	A	Activity Date :	01-01-1970
Lab Sample No. :	0033063-01	Collection Date :	03-16-2020

This list displays sample/results of all non-microbial analytes (TSAANLYT.TYPE_CODE <> MOR) associated to the selected sample. Results for Microbial Analytes are not included.

Analyte Code	Analyte Name	Method Code	Less than Indicator	Level Type	Reporting Level	Concentration level	Monitoring Period Begin Date	Monitoring Period End Date
1024	CYANIDE	335.4	Y	MRL	0.2 MG/L		01-01-2020	12-31-2028
2005	ENDRIN	525.2	Y	MRL	0.1 UG/L		01-01-2020	12-31-2028
2010	BHC-GAMMA	525.2	Y	MRL	0.1 UG/L		01-01-2020	12-31-2028
2015	METHOXYCHLOR	525.2	Y	MRL	0.1 UG/L		01-01-2020	12-31-2028
2020	TOXAPHENE	525.2	Y	MRL	1 UG/L		01-01-2020	12-31-2028
2031	DALAPON	515.3	Y	MRL	5 UG/L		01-01-2020	12-31-2028
2032	DIQUAT	549.2	Y	MRL	2 UG/L		01-01-2020	12-31-2028
2033	ENDOTHALL	548.1	Y	MRL	9 UG/L		01-01-2020	12-31-2028
2035	DI(2-ETHYLHEXYL) ADIPATE	525.2	Y	MRL	0.6 UG/L		01-01-2020	12-31-2028
2037	SIMAZINE	525.2	Y	MRL	0.35 UG/L		01-01-2020	12-31-2028
2039	DI(2-ETHYLHEXYL) PHTHALATE	525.2	Y	MRL	1.8 UG/L		01-01-2020	12-31-2028
2040	PICLORAM	515.3	Y	MRL	1 UG/L		01-01-2020	12-31-2028
2041	DINOSEB	515.3	Y	MRL	1 UG/L		01-01-2020	12-31-2028
2042	HEXACHLOROCYCLOPENTADIENE	525.2	Y	MRL	0.5 UG/L		01-01-2020	12-31-2028
2050	ATRAZINE	525.2	Y	MRL	0.3 UG/L		01-01-2020	12-31-2028
2051	LASSO	525.2	Y	MRL	0.2 UG/L		01-01-2020	12-31-2028
2065	HEPTACHLOR	525.2	Y	MRL	0.04 UG/L		01-01-2020	12-31-2028
2067	HEPTACHLOR EPOXIDE	525.2	Y	MRL	0.02 UG/L		01-01-2020	12-31-2028
2070	DIELDRIN	525.2	Y	MRL	0.25 UG/L		01-01-2020	12-31-2028
2077	PROPACHLOR	525.2	Y	MRL	0.5 UG/L			
2105	2,4-D	515.3	Y	MRL	1 UG/L		01-01-2020	12-31-2028
2110	2,4,5-TP	515.3	Y	MRL	1 UG/L		01-01-2020	12-31-2028
2251	METHYL TERT-BUTYL ETHER	524.2	Y	MRL	0.5 UG/L			
2274	HEXACHLOROBENZENE	525.2	Y	MRL	0.1 UG/L		01-01-2020	12-31-2028
2306	BENZO(A)PYRENE	550	Y	MRL	0.1 UG/L		01-01-2020	12-31-2028
2326	PENTACHLOROPHENOL	515.3	Y	MRL	0.4 UG/L		01-01-2020	12-31-2028
2356	ALDRIN	525.2	Y	MRL	0.25 UG/L		01-01-2020	12-31-2028
2378	1,2,4-TRICHLOROBENZENE	524.2	Y	MRL	0.5 UG/L		01-01-2020	12-31-2025
2380	CIS-1,2-DICHLOROETHYLENE	524.2	Y	MRL	0.5 UG/L		01-01-2020	12-31-2025
2383	TOTAL POLYCHLORINATED BIPHENYLS (PCB)	525.2	Y	MRL	0.1 UG/L		01-01-2020	12-31-2028
2440	DICAMBA	515.3	Y	MRL	0.3 UG/L			
2775	TOTAL DDT	525.2	Y	MRL	1 UG/L		01-01-2020	12-31-2028
2931	1,2-DIBROMO-3-CHLOROPROPANE	504.1	Y	MRL	0.02 UG/L		01-01-2020	12-31-2028
2946	ETHYLENE DIBROMIDE	504.1	Y	MRL	0.01 UG/L		01-01-2020	12-31-2028
2955	XYLENES, TOTAL	524.2	Y	MRL	0.5 UG/L		01-01-2020	12-31-2025
2959	CHLORDANE	525.2	Y	MRL	0.2 UG/L		01-01-2020	12-31-2028
2964	DICHLOROMETHANE	524.2	Y	MRL	0.5 UG/L		01-01-2020	12-31-2025
2968	O-DICHLOROBENZENE	524.2	Y	MRL	0.5 UG/L		01-01-2020	12-31-2025
2969	P-DICHLOROBENZENE	524.2	Y	MRL	0.5 UG/L		01-01-2020	12-31-2025
2976	VINYL CHLORIDE	524.2	Y	MRL	0.5 UG/L		01-01-2020	12-31-2025
2977	1,1-DICHLOROETHYLENE	524.2	Y	MRL	0.5 UG/L		01-01-2020	12-31-2025
2979	TRANS-1,2-DICHLOROETHYLENE	524.2	Y	MRL	0.5 UG/L		01-01-2020	12-31-2025

2980	1,2-DICHLOROETHANE	524.2	Y	MRL	0.5 UG/L		01-01-2020	12-31-2025
2981	1,1,1-TRICHLOROETHANE	524.2	Y	MRL	0.5 UG/L		01-01-2020	12-31-2025
2982	CARBON TETRACHLORIDE	524.2	Y	MRL	0.5 UG/L		01-01-2020	12-31-2025
2983	1,2-DICHLOROPROPANE	524.2	Y	MRL	0.5 UG/L		01-01-2020	12-31-2025
2984	TRICHLOROETHYLENE	524.2	Y	MRL	0.5 UG/L		01-01-2020	12-31-2025
2985	1,1,2-TRICHLOROETHANE	524.2	Y	MRL	0.5 UG/L		01-01-2020	12-31-2025
2987	TETRACHLOROETHYLENE	524.2	Y	MRL	0.5 UG/L		01-01-2020	12-31-2025
2989	CHLOROBENZENE	524.2	Y	MRL	0.5 UG/L		01-01-2020	12-31-2025
2990	BENZENE	524.2	Y	MRL	0.5 UG/L		01-01-2020	12-31-2025
2991	TOLUENE	524.2	Y	MRL	0.5 UG/L		01-01-2020	12-31-2025
2992	ETHYLBENZENE	524.2	Y	MRL	0.5 UG/L		01-01-2020	12-31-2025
2996	STYRENE	524.2	Y	MRL	0.5 UG/L		01-01-2020	12-31-2025

Total Number of Records Fetched = 54

Drinking Water Branch

Chem/Rad Sample Results

Return Links

[Chem/Rad
Samples](#)

[Analyte List](#)

[Water System
Detail](#)

[Water Systems](#)

[Water System
Search](#)

[County Map](#)

[Glossary](#)

Water System No. :	IL0855150	Federal Type :	C
Water System Name :	PRAIRIE PATH WATER COMPANY-APPLE CANYON	State Type :	C
Principal County Served :	JO DAVIESS	Primary Source :	GW
Status :	A	Activity Date :	01-01-1970
Lab Sample No. :	0076499-02	Collection Date :	07-30-2020

This list displays sample/results of all non-microbial analytes (TSAANLYT.TYPE_CODE <> MOR) associated to the selected sample. Results for Microbial Analytes are not included.

Analyte Code	Analyte Name	Method Code	Less than Indicator	Level Type	Reporting Level	Concentration level	Monitoring Period Begin Date	Monitoring Period End Date
4010	COMBINED RADIUM (-226 & -228)	null	null		null null	1.25 PCI/L	01-01-2020	12-31-2022
4020	RADIUM-226	903.1			0	0.58 PCI/L		
4030	RADIUM-228	904.0			0	0.669 PCI/L		
4109	GROSS ALPHA PARTICLE ACTIVITY	900.0	Y	MRL	2.72 PCI/L		01-01-2020	12-31-2025

Total Number of Records Fetched = 4

Drinking Water Branch

Chem/Rad Sample Results

[Return Links](#)

[Chem/Rad Samples](#)

[Analyte List](#)

[Water System Detail](#)

[Water Systems](#)

[Water System Search](#)

[County Map](#)

[Glossary](#)

Water System No. :	IL0855150	Federal Type :	C
Water System Name :	PRAIRIE PATH WATER COMPANY-APPLE CANYON	State Type :	C
Principal County Served :	JO DAVIESS	Primary Source :	GW
Status :	A	Activity Date :	01-01-1970
Lab Sample No. :	4021074-01	Collection Date :	02-10-2014

This list displays sample/results of all non-microbial analytes (TSAANLYT.TYPE_CODE <> MOR) associated to the selected sample. Results for Microbial Analytes are not included.

Analyte Code	Analyte Name	Method Code	Less than Indicator	Level Type	Reporting Level	Concentration level	Monitoring Period Begin Date	Monitoring Period End Date
2251	METHYL TERT-BUTYL ETHER	524.2	Y	MRL	0.5 UG/L			
2378	1,2,4-TRICHLOROBENZENE	524.2	Y	MRL	0.5 UG/L		01-01-2014	12-31-2019
2380	CIS-1,2-DICHLOROETHYLENE	524.2	Y	MRL	0.5 UG/L		01-01-2014	12-31-2019
2955	XYLENES, TOTAL	524.2	Y	MRL	0.5 UG/L		01-01-2014	12-31-2019
2964	DICHLROMETHANE	524.2	Y	MRL	0.5 UG/L		01-01-2014	12-31-2019
2968	O-DICHLOROBENZENE	524.2	Y	MRL	0.5 UG/L		01-01-2014	12-31-2019
2969	P-DICHLOROBENZENE	524.2	Y	MRL	0.5 UG/L		01-01-2014	12-31-2019
2976	VINYL CHLORIDE	524.2	Y	MRL	0.5 UG/L		01-01-2014	12-31-2019
2977	1,1-DICHLOROETHYLENE	524.2	Y	MRL	0.5 UG/L		01-01-2014	12-31-2019
2979	TRANS-1,2-DICHLOROETHYLENE	524.2	Y	MRL	0.5 UG/L		01-01-2014	12-31-2019
2980	1,2-DICHLOROETHANE	524.2	Y	MRL	0.5 UG/L		01-01-2014	12-31-2019
2981	1,1,1-TRICHLOROETHANE	524.2	Y	MRL	0.5 UG/L		01-01-2014	12-31-2019
2982	CARBON TETRACHLORIDE	524.2	Y	MRL	0.5 UG/L		01-01-2014	12-31-2019
2983	1,2-DICHLOROPROPANE	524.2	Y	MRL	0.5 UG/L		01-01-2014	12-31-2019
2984	TRICHLOROETHYLENE	524.2	Y	MRL	0.5 UG/L		01-01-2014	12-31-2019
2985	1,1,2-TRICHLOROETHANE	524.2	Y	MRL	0.5 UG/L		01-01-2014	12-31-2019
2987	TETRACHLOROETHYLENE	524.2	Y	MRL	0.5 UG/L		01-01-2014	12-31-2019
2989	CHLOROBENZENE	524.2	Y	MRL	0.5 UG/L		01-01-2014	12-31-2019
2990	BENZENE	524.2	Y	MRL	0.5 UG/L		01-01-2014	12-31-2019
2991	TOLUENE	524.2	Y	MRL	0.5 UG/L		01-01-2014	12-31-2019
2992	ETHYLBENZENE	524.2	Y	MRL	0.5 UG/L		01-01-2014	12-31-2019
2996	STYRENE	524.2	Y	MRL	0.5 UG/L		01-01-2014	12-31-2019

Total Number of Records Fetched = 22

Drinking Water Branch

Chem/Rad Sample Results

[Return Links](#)

[Chem/Rad Samples](#)

[Analyte List](#)

[Water System Detail](#)

[Water Systems](#)

[Water System Search](#)

[County Map](#)

[Glossary](#)

Water System No. :	IL0855150	Federal Type :	C
Water System Name :	PRAIRIE PATH WATER COMPANY-APPLE CANYON	State Type :	C
Principal County Served :	JO DAVIESS	Primary Source :	GW
Status :	A	Activity Date :	01-01-1970
Lab Sample No. :	4012618-02	Collection Date :	01-21-2014

This list displays sample/results of all non-microbial analytes (TSAANLYT.TYPE_CODE <> MOR) associated to the selected sample. Results for Microbial Analytes are not included.

Analyte Code	Analyte Name	Method Code	Less than Indicator	Level Type	Reporting Level	Concentration level	Monitoring Period Begin Date	Monitoring Period End Date
2251	METHYL TERT-BUTYL ETHER	524.2	Y	MRL	0.5 UG/L			
2378	1,2,4-TRICHLOROBENZENE	524.2	Y	MRL	0.5 UG/L		01-01-2014	12-31-2019
2380	CIS-1,2-DICHLOROETHYLENE	524.2	Y	MRL	0.5 UG/L		01-01-2014	12-31-2019
2955	XYLENES, TOTAL	524.2	Y	MRL	0.5 UG/L		01-01-2014	12-31-2019
2964	DICHLROMETHANE	524.2	Y	MRL	0.5 UG/L		01-01-2014	12-31-2019
2968	O-DICHLOROBENZENE	524.2	Y	MRL	0.5 UG/L		01-01-2014	12-31-2019
2969	P-DICHLOROBENZENE	524.2	Y	MRL	0.5 UG/L		01-01-2014	12-31-2019
2976	VINYL CHLORIDE	524.2	Y	MRL	0.5 UG/L		01-01-2014	12-31-2019
2977	1,1-DICHLOROETHYLENE	524.2	Y	MRL	0.5 UG/L		01-01-2014	12-31-2019
2979	TRANS-1,2-DICHLOROETHYLENE	524.2	Y	MRL	0.5 UG/L		01-01-2014	12-31-2019
2980	1,2-DICHLOROETHANE	524.2	Y	MRL	0.5 UG/L		01-01-2014	12-31-2019
2981	1,1,1-TRICHLOROETHANE	524.2	Y	MRL	0.5 UG/L		01-01-2014	12-31-2019
2982	CARBON TETRACHLORIDE	524.2	Y	MRL	0.5 UG/L		01-01-2014	12-31-2019
2983	1,2-DICHLOROPROPANE	524.2	Y	MRL	0.5 UG/L		01-01-2014	12-31-2019
2984	TRICHLOROETHYLENE	524.2	Y	MRL	0.5 UG/L		01-01-2014	12-31-2019
2985	1,1,2-TRICHLOROETHANE	524.2	Y	MRL	0.5 UG/L		01-01-2014	12-31-2019
2987	TETRACHLOROETHYLENE	524.2	Y	MRL	0.5 UG/L		01-01-2014	12-31-2019
2989	CHLOROBENZENE	524.2	Y	MRL	0.5 UG/L		01-01-2014	12-31-2019
2990	BENZENE	524.2	Y	MRL	0.5 UG/L		01-01-2014	12-31-2019
2991	TOLUENE	524.2	Y	MRL	0.5 UG/L		01-01-2014	12-31-2019
2992	ETHYLBENZENE	524.2	Y	MRL	0.5 UG/L		01-01-2014	12-31-2019
2996	STYRENE	524.2	Y	MRL	0.5 UG/L		01-01-2014	12-31-2019

Total Number of Records Fetched = 22

Drinking Water Branch

Chem/Rad Sample Results

[Return Links](#)

[Chem/Rad Samples](#)

[Analyte List](#)

[Water System Detail](#)

[Water Systems](#)

[Water System Search](#)

[County Map](#)

[Glossary](#)

Water System No. :	IL0855150	Federal Type :	C
Water System Name :	PRAIRIE PATH WATER COMPANY-APPLE CANYON	State Type :	C
Principal County Served :	JO DAVIESS	Primary Source :	GW
Status :	A	Activity Date :	01-01-1970
Lab Sample No. :	0033063-01	Collection Date :	03-16-2020

This list displays sample/results of all non-microbial analytes (TSAANLYT.TYPE_CODE <> MOR) associated to the selected sample. Results for Microbial Analytes are not included.

Analyte Code	Analyte Name	Method Code	Less than Indicator	Level Type	Reporting Level	Concentration level	Monitoring Period Begin Date	Monitoring Period End Date
1024	CYANIDE	335.4	Y	MRL	0.2 MG/L		01-01-2020	12-31-2028
2005	ENDRIN	525.2	Y	MRL	0.1 UG/L		01-01-2020	12-31-2028
2010	BHC-GAMMA	525.2	Y	MRL	0.1 UG/L		01-01-2020	12-31-2028
2015	METHOXYCHLOR	525.2	Y	MRL	0.1 UG/L		01-01-2020	12-31-2028
2020	TOXAPHENE	525.2	Y	MRL	1 UG/L		01-01-2020	12-31-2028
2031	DALAPON	515.3	Y	MRL	5 UG/L		01-01-2020	12-31-2028
2032	DIQUAT	549.2	Y	MRL	2 UG/L		01-01-2020	12-31-2028
2033	ENDOTHALL	548.1	Y	MRL	9 UG/L		01-01-2020	12-31-2028
2035	DI(2-ETHYLHEXYL) ADIPATE	525.2	Y	MRL	0.6 UG/L		01-01-2020	12-31-2028
2037	SIMAZINE	525.2	Y	MRL	0.35 UG/L		01-01-2020	12-31-2028
2039	DI(2-ETHYLHEXYL) PHTHALATE	525.2	Y	MRL	1.8 UG/L		01-01-2020	12-31-2028
2040	PICLORAM	515.3	Y	MRL	1 UG/L		01-01-2020	12-31-2028
2041	DINOSEB	515.3	Y	MRL	1 UG/L		01-01-2020	12-31-2028
2042	HEXACHLOROCYCLOPENTADIENE	525.2	Y	MRL	0.5 UG/L		01-01-2020	12-31-2028
2050	ATRAZINE	525.2	Y	MRL	0.3 UG/L		01-01-2020	12-31-2028
2051	LASSO	525.2	Y	MRL	0.2 UG/L		01-01-2020	12-31-2028
2065	HEPTACHLOR	525.2	Y	MRL	0.04 UG/L		01-01-2020	12-31-2028
2067	HEPTACHLOR EPOXIDE	525.2	Y	MRL	0.02 UG/L		01-01-2020	12-31-2028
2070	DIELDRIN	525.2	Y	MRL	0.25 UG/L		01-01-2020	12-31-2028
2077	PROPACHLOR	525.2	Y	MRL	0.5 UG/L			
2105	2,4-D	515.3	Y	MRL	1 UG/L		01-01-2020	12-31-2028
2110	2,4,5-TP	515.3	Y	MRL	1 UG/L		01-01-2020	12-31-2028
2251	METHYL TERT-BUTYL ETHER	524.2	Y	MRL	0.5 UG/L			
2274	HEXACHLOROBENZENE	525.2	Y	MRL	0.1 UG/L		01-01-2020	12-31-2028
2306	BENZO(A)PYRENE	550	Y	MRL	0.1 UG/L		01-01-2020	12-31-2028
2326	PENTACHLOROPHENOL	515.3	Y	MRL	0.4 UG/L		01-01-2020	12-31-2028
2356	ALDRIN	525.2	Y	MRL	0.25 UG/L		01-01-2020	12-31-2028
2378	1,2,4-TRICHLOROBENZENE	524.2	Y	MRL	0.5 UG/L		01-01-2020	12-31-2025
2380	CIS-1,2-DICHLOROETHYLENE	524.2	Y	MRL	0.5 UG/L		01-01-2020	12-31-2025
2383	TOTAL POLYCHLORINATED BIPHENYLS (PCB)	525.2	Y	MRL	0.1 UG/L		01-01-2020	12-31-2028
2440	DICAMBA	515.3	Y	MRL	0.3 UG/L			
2775	TOTAL DDT	525.2	Y	MRL	1 UG/L		01-01-2020	12-31-2028
2931	1,2-DIBROMO-3-CHLOROPROPANE	504.1	Y	MRL	0.02 UG/L		01-01-2020	12-31-2028
2946	ETHYLENE DIBROMIDE	504.1	Y	MRL	0.01 UG/L		01-01-2020	12-31-2028
2955	XYLENES, TOTAL	524.2	Y	MRL	0.5 UG/L		01-01-2020	12-31-2025
2959	CHLORDANE	525.2	Y	MRL	0.2 UG/L		01-01-2020	12-31-2028
2964	DICHLOROMETHANE	524.2	Y	MRL	0.5 UG/L		01-01-2020	12-31-2025
2968	O-DICHLOROBENZENE	524.2	Y	MRL	0.5 UG/L		01-01-2020	12-31-2025
2969	P-DICHLOROBENZENE	524.2	Y	MRL	0.5 UG/L		01-01-2020	12-31-2025
2976	VINYL CHLORIDE	524.2	Y	MRL	0.5 UG/L		01-01-2020	12-31-2025
2977	1,1-DICHLOROETHYLENE	524.2	Y	MRL	0.5 UG/L		01-01-2020	12-31-2025
2979	TRANS-1,2-DICHLOROETHYLENE	524.2	Y	MRL	0.5 UG/L		01-01-2020	12-31-2025

2980	1,2-DICHLOROETHANE	524.2	Y	MRL	0.5 UG/L		01-01-2020	12-31-2025
2981	1,1,1-TRICHLOROETHANE	524.2	Y	MRL	0.5 UG/L		01-01-2020	12-31-2025
2982	CARBON TETRACHLORIDE	524.2	Y	MRL	0.5 UG/L		01-01-2020	12-31-2025
2983	1,2-DICHLOROPROPANE	524.2	Y	MRL	0.5 UG/L		01-01-2020	12-31-2025
2984	TRICHLOROETHYLENE	524.2	Y	MRL	0.5 UG/L		01-01-2020	12-31-2025
2985	1,1,2-TRICHLOROETHANE	524.2	Y	MRL	0.5 UG/L		01-01-2020	12-31-2025
2987	TETRACHLOROETHYLENE	524.2	Y	MRL	0.5 UG/L		01-01-2020	12-31-2025
2989	CHLOROBENZENE	524.2	Y	MRL	0.5 UG/L		01-01-2020	12-31-2025
2990	BENZENE	524.2	Y	MRL	0.5 UG/L		01-01-2020	12-31-2025
2991	TOLUENE	524.2	Y	MRL	0.5 UG/L		01-01-2020	12-31-2025
2992	ETHYLBENZENE	524.2	Y	MRL	0.5 UG/L		01-01-2020	12-31-2025
2996	STYRENE	524.2	Y	MRL	0.5 UG/L		01-01-2020	12-31-2025

Total Number of Records Fetched = 54

Drinking Water Branch

Chem/Rad Sample Results

[Return Links](#)

[Chem/Rad Samples](#)

[Analyte List](#)

[Water System Detail](#)

[Water Systems](#)

[Water System Search](#)

[County Map](#)

[Glossary](#)

Water System No. :	IL0855150	Federal Type :	C
Water System Name :	PRAIRIE PATH WATER COMPANY-APPLE CANYON	State Type :	C
Principal County Served :	JO DAVIESS	Primary Source :	GW
Status :	A	Activity Date :	01-01-1970
Lab Sample No. :	0023214-01	Collection Date :	02-18-2020

This list displays sample/results of all non-microbial analytes (TSAANLYT.TYPE_CODE <> MOR) associated to the selected sample. Results for Microbial Analytes are not included.

Analyte Code	Analyte Name	Method Code	Less than Indicator	Level Type	Reporting Level	Concentration level	Monitoring Period Begin Date	Monitoring Period End Date
1024	CYANIDE	335.4	Y	MRL	0.2 MG/L		01-01-2020	12-31-2028
2005	ENDRIN	525.2	Y	MRL	0.1 UG/L		01-01-2020	12-31-2028
2010	BHC-GAMMA	525.2	Y	MRL	0.1 UG/L		01-01-2020	12-31-2028
2015	METHOXYCHLOR	525.2	Y	MRL	0.1 UG/L		01-01-2020	12-31-2028
2020	TOXAPHENE	525.2	Y	MRL	1 UG/L		01-01-2020	12-31-2028
2021	CARBARYL	531.1	Y	MRL	2 UG/L			
2022	METHOMYL	531.1	Y	MRL	0.5 UG/L			
2031	DALAPON	515.3	Y	MRL	5 UG/L		01-01-2020	12-31-2028
2032	DIQUAT	549.2	Y	MRL	2 UG/L		01-01-2020	12-31-2028
2033	ENDOTHALL	548.1	Y	MRL	9 UG/L		01-01-2020	12-31-2028
2035	DI(2-ETHYLHEXYL) ADIPATE	525.2	Y	MRL	0.6 UG/L		01-01-2020	12-31-2028
2036	OXAMYL	531.1	Y	MRL	2 UG/L		01-01-2020	12-31-2028
2037	SIMAZINE	525.2	Y	MRL	0.35 UG/L		01-01-2020	12-31-2028
2039	DI(2-ETHYLHEXYL) PHTHALATE	525.2	Y	MRL	1.8 UG/L		01-01-2020	12-31-2028
2040	PICLORAM	515.3	Y	MRL	1 UG/L		01-01-2020	12-31-2028
2041	DINOSEB	515.3	Y	MRL	1 UG/L		01-01-2020	12-31-2028
2042	HEXACHLOROCYCLOPENTADIENE	525.2	Y	MRL	0.5 UG/L		01-01-2020	12-31-2028
2046	CARBOFURAN	531.1	Y	MRL	0.9 UG/L		01-01-2020	12-31-2028
2050	ATRAZINE	525.2	Y	MRL	0.3 UG/L		01-01-2020	12-31-2028
2051	LASSO	525.2	Y	MRL	0.2 UG/L		01-01-2020	12-31-2028
2065	HEPTACHLOR	525.2	Y	MRL	0.04 UG/L		01-01-2020	12-31-2028
2066	3-HYDROXYCARBOFURAN	531.1	Y	MRL	1 UG/L			
2067	HEPTACHLOR EPOXIDE	525.2	Y	MRL	0.02 UG/L		01-01-2020	12-31-2028
2070	DIELDRIN	525.2	Y	MRL	0.25 UG/L		01-01-2020	12-31-2028
2077	PROPACHLOR	525.2	Y	MRL	0.5 UG/L			
2105	2,4-D	515.3	Y	MRL	1 UG/L		01-01-2020	12-31-2028
2110	2,4,5-TP	515.3	Y	MRL	1 UG/L		01-01-2020	12-31-2028
2251	METHYL TERT-BUTYL ETHER	524.2	Y	MRL	0.5 UG/L			
2274	HEXACHLOROBENZENE	525.2	Y	MRL	0.1 UG/L		01-01-2020	12-31-2028
2306	BENZO(A)PYRENE	550	Y	MRL	0.1 UG/L		01-01-2020	12-31-2028
2326	PENTACHLOROPHENOL	515.3	Y	MRL	0.4 UG/L		01-01-2020	12-31-2028
2356	ALDRIN	525.2	Y	MRL	0.25 UG/L		01-01-2020	12-31-2028
2378	1,2,4-TRICHLOROBENZENE	524.2	Y	MRL	0.5 UG/L		01-01-2020	12-31-2025
2380	CIS-1,2-DICHLOROETHYLENE	524.2	Y	MRL	0.5 UG/L		01-01-2020	12-31-2025
2383	TOTAL POLYCHLORINATED BIPHENYLS (PCB)	525.2	Y	MRL	0.1 UG/L		01-01-2020	12-31-2028
2440	DICAMBA	515.3	Y	MRL	0.3 UG/L			
2775	TOTAL DDT	525.2	Y	MRL	1 UG/L		01-01-2020	12-31-2028
2931	1,2-DIBROMO-3-CHLOROPROPANE	504.1	Y	MRL	0.02 UG/L		01-01-2020	12-31-2028
2946	ETHYLENE DIBROMIDE	504.1	Y	MRL	0.01 UG/L		01-01-2020	12-31-2028
2955	XYLENES, TOTAL	524.2	Y	MRL	0.5 UG/L		01-01-2020	12-31-2025
2959	CHLORDANE	525.2	Y	MRL	0.2 UG/L		01-01-2020	12-31-2028
2964	DICHLOROMETHANE	524.2	Y	MRL	0.5 UG/L		01-01-2020	12-31-2025

2968	O-DICHLOROBENZENE	524.2	Y	MRL	0.5 UG/L		01-01-2020	12-31-2025
2969	P-DICHLOROBENZENE	524.2	Y	MRL	0.5 UG/L		01-01-2020	12-31-2025
2976	VINYL CHLORIDE	524.2	Y	MRL	0.5 UG/L		01-01-2020	12-31-2025
2977	1,1-DICHLOROETHYLENE	524.2	Y	MRL	0.5 UG/L		01-01-2020	12-31-2025
2979	TRANS-1,2-DICHLOROETHYLENE	524.2	Y	MRL	0.5 UG/L		01-01-2020	12-31-2025
2980	1,2-DICHLOROETHANE	524.2	Y	MRL	0.5 UG/L		01-01-2020	12-31-2025
2981	1,1,1-TRICHLOROETHANE	524.2	Y	MRL	0.5 UG/L		01-01-2020	12-31-2025
2982	CARBON TETRACHLORIDE	524.2	Y	MRL	0.5 UG/L		01-01-2020	12-31-2025
2983	1,2-DICHLOROPROPANE	524.2	Y	MRL	0.5 UG/L		01-01-2020	12-31-2025
2984	TRICHLOROETHYLENE	524.2	Y	MRL	0.5 UG/L		01-01-2020	12-31-2025
2985	1,1,2-TRICHLOROETHANE	524.2	Y	MRL	0.5 UG/L		01-01-2020	12-31-2025
2987	TETRACHLOROETHYLENE	524.2	Y	MRL	0.5 UG/L		01-01-2020	12-31-2025
2989	CHLOROBENZENE	524.2	Y	MRL	0.5 UG/L		01-01-2020	12-31-2025
2990	BENZENE	524.2	Y	MRL	0.5 UG/L		01-01-2020	12-31-2025
2991	TOLUENE	524.2	Y	MRL	0.5 UG/L		01-01-2020	12-31-2025
2992	ETHYLBENZENE	524.2	Y	MRL	0.5 UG/L		01-01-2020	12-31-2025
2996	STYRENE	524.2	Y	MRL	0.5 UG/L		01-01-2020	12-31-2025

Total Number of Records Fetched = 59

Drinking Water Branch

Chem/Rad Sample Results

[Return Links](#)

[Chem/Rad Samples](#)

[Analyte List](#)

[Water System Detail](#)

[Water Systems](#)

[Water System Search](#)

[County Map](#)

[Glossary](#)

Water System No. :	IL0855150	Federal Type :	C
Water System Name :	PRAIRIE PATH WATER COMPANY-APPLE CANYON	State Type :	C
Principal County Served :	JO DAVIESS	Primary Source :	GW
Status :	A	Activity Date :	01-01-1970
Lab Sample No. :	11021494-1	Collection Date :	02-07-2011

This list displays sample/results of all non-microbial analytes (TSAANLYT.TYPE_CODE <> MOR) associated to the selected sample. Results for Microbial Analytes are not included.

Analyte Code	Analyte Name	Method Code	Less than Indicator	Level Type	Reporting Level	Concentration level	Monitoring Period Begin Date	Monitoring Period End Date
1024	CYANIDE	335.4	Y	MRL	0.01 MG/L		01-01-2011	12-31-2019
2005	ENDRIN	508	Y	MRL	0.1 UG/L		01-01-2011	12-31-2019
2010	BHC-GAMMA	508	Y	MRL	0.01 UG/L		01-01-2011	12-31-2019
2015	METHOXYCHLOR	508	Y	MRL	0.1 UG/L		01-01-2011	12-31-2019
2020	TOXAPHENE	508	Y	MRL	1 UG/L		01-01-2011	12-31-2019
2031	DALAPON	515.3	Y	MRL	5 UG/L		01-01-2011	12-31-2019
2032	DIQUAT	549.2	Y	MRL	2 UG/L		01-01-2011	12-31-2019
2033	ENDOTHALL	548.1	Y	MRL	9 UG/L		01-01-2011	12-31-2019
2035	DI(2-ETHYLHEXYL) ADIPATE	525.2	Y	MRL	40 UG/L		01-01-2011	12-31-2019
2036	OXAMYL	531.1	Y	MRL	2 UG/L		01-01-2011	12-31-2019
2037	SIMAZINE	525.2	Y	MRL	0.4 UG/L		01-01-2011	12-31-2019
2039	DI(2-ETHYLHEXYL) PHTHALATE	525.2	Y	MRL	1.8 UG/L		01-01-2011	12-31-2019
2040	PICLORAM	515.3	Y	MRL	1 UG/L		01-01-2011	12-31-2019
2041	DINOSEB	515.3	Y	MRL	0.7 UG/L		01-01-2011	12-31-2019
2042	HEXACHLOROCYCLOPENTADIENE	508	Y	MRL	0.5 UG/L		01-01-2011	12-31-2019
2043	ALDICARB SULFOXIDE	531.1	Y	MRL	1 UG/L		01-01-2011	12-31-2019
2044	ALDICARB SULFONE	531.1	Y	MRL	1 UG/L		01-01-2011	12-31-2019
2046	CARBOFURAN	531.1	Y	MRL	0.9 UG/L		01-01-2011	12-31-2019
2047	ALDICARB	531.1	Y	MRL	1 UG/L		01-01-2011	12-31-2019
2050	ATRAZINE	525.2	Y	MRL	0.3 UG/L		01-01-2011	12-31-2019
2051	LASSO	525.2	Y	MRL	0.2 UG/L		01-01-2011	12-31-2019
2065	HEPTACHLOR	508	Y	MRL	0.04 UG/L		01-01-2011	12-31-2019
2067	HEPTACHLOR EPOXIDE	508	Y	MRL	0.02 UG/L		01-01-2011	12-31-2019
2070	DIELDRIN	508	Y	MRL	0.05 UG/L		01-01-2011	12-31-2019
2105	2,4-D	515.3	Y	MRL	1 UG/L		01-01-2011	12-31-2019
2110	2,4,5-TP	515.3	Y	MRL	1 UG/L		01-01-2011	12-31-2019
2274	HEXACHLOROBENZENE	508	Y	MRL	0.1 UG/L		01-01-2011	12-31-2019
2306	BENZO(A)PYRENE	525.2	Y	MRL	0.02 UG/L		01-01-2011	12-31-2019
2326	PENTACHLOROPHENOL	515.3	Y	MRL	0.1 UG/L		01-01-2011	12-31-2019
2356	ALDRIN	508	Y	MRL	0.05 UG/L		01-01-2011	12-31-2019
2383	TOTAL POLYCHLORINATED BIPHENYLS (PCB)	508	Y	MRL	0.1 UG/L		01-01-2011	12-31-2019
2775	TOTAL DDT	508	Y	MRL	1 UG/L		01-01-2011	12-31-2019
2931	1,2-DIBROMO-3-CHLOROPROPANE	504.1	Y	MRL	0.02 UG/L		01-01-2011	12-31-2019
2946	ETHYLENE DIBROMIDE	504.1	Y	MRL	0.01 UG/L		01-01-2011	12-31-2019
2959	CHLORDANE	508	Y	MRL	0.2 UG/L		01-01-2011	12-31-2019

Total Number of Records Fetched = 35

Drinking Water Branch

Chem/Rad Sample Results

[Return Links](#)

[Chem/Rad Samples](#)

[Analyte List](#)

[Water System Detail](#)

[Water Systems](#)

[Water System Search](#)

[County Map](#)

[Glossary](#)

Water System No. :	IL0855150	Federal Type :	C
Water System Name :	PRAIRIE PATH WATER COMPANY-APPLE CANYON	State Type :	C
Principal County Served :	JO DAVIESS	Primary Source :	GW
Status :	A	Activity Date :	01-01-1970
Lab Sample No. :	11021045-1	Collection Date :	01-31-2011

This list displays sample/results of all non-microbial analytes (TSAANLYT.TYPE_CODE <> MOR) associated to the selected sample. Results for Microbial Analytes are not included.

Analyte Code	Analyte Name	Method Code	Less than Indicator	Level Type	Reporting Level	Concentration level	Monitoring Period Begin Date	Monitoring Period End Date
1024	CYANIDE	335.4	Y	MRL	0.01 MG/L		01-01-2011	12-31-2019
2005	ENDRIN	508	Y	MRL	0.1 UG/L		01-01-2011	12-31-2019
2010	BHC-GAMMA	508	Y	MRL	0.01 UG/L		01-01-2011	12-31-2019
2015	METHOXYCHLOR	508	Y	MRL	0.1 UG/L		01-01-2011	12-31-2019
2020	TOXAPHENE	508	Y	MRL	1 UG/L		01-01-2011	12-31-2019
2031	DALAPON	515.3	Y	MRL	5 UG/L		01-01-2011	12-31-2019
2032	DIQUAT	549.2	Y	MRL	2 UG/L		01-01-2011	12-31-2019
2033	ENDOTHALL	548.1	Y	MRL	9 UG/L		01-01-2011	12-31-2019
2035	DI(2-ETHYLHEXYL) ADIPATE	525.2	Y	MRL	40 UG/L		01-01-2011	12-31-2019
2036	OXAMYL	531.1	Y	MRL	2 UG/L		01-01-2011	12-31-2019
2037	SIMAZINE	525.2	Y	MRL	0.4 UG/L		01-01-2011	12-31-2019
2039	DI(2-ETHYLHEXYL) PHTHALATE	525.2	Y	MRL	1.8 UG/L		01-01-2011	12-31-2019
2040	PICLORAM	515.3	Y	MRL	1 UG/L		01-01-2011	12-31-2019
2041	DINOSEB	515.3	Y	MRL	0.7 UG/L		01-01-2011	12-31-2019
2042	HEXACHLOROCYCLOPENTADIENE	508	Y	MRL	0.5 UG/L		01-01-2011	12-31-2019
2043	ALDICARB SULFOXIDE	531.1	Y	MRL	1 UG/L		01-01-2011	12-31-2019
2044	ALDICARB SULFONE	531.1	Y	MRL	1 UG/L		01-01-2011	12-31-2019
2046	CARBOFURAN	531.1	Y	MRL	0.9 UG/L		01-01-2011	12-31-2019
2047	ALDICARB	531.1	Y	MRL	1 UG/L		01-01-2011	12-31-2019
2050	ATRAZINE	525.2	Y	MRL	0.3 UG/L		01-01-2011	12-31-2019
2051	LASSO	525.2	Y	MRL	0.2 UG/L		01-01-2011	12-31-2019
2065	HEPTACHLOR	508	Y	MRL	0.04 UG/L		01-01-2011	12-31-2019
2067	HEPTACHLOR EPOXIDE	508	Y	MRL	0.02 UG/L		01-01-2011	12-31-2019
2070	DIELDRIN	508	Y	MRL	0.05 UG/L		01-01-2011	12-31-2019
2105	2,4-D	515.3	Y	MRL	1 UG/L		01-01-2011	12-31-2019
2110	2,4,5-TP	515.3	Y	MRL	1 UG/L		01-01-2011	12-31-2019
2274	HEXACHLOROBENZENE	508	Y	MRL	0.1 UG/L		01-01-2011	12-31-2019
2306	BENZO(A)PYRENE	525.2	Y	MRL	0.02 UG/L		01-01-2011	12-31-2019
2326	PENTACHLOROPHENOL	515.3	Y	MRL	0.1 UG/L		01-01-2011	12-31-2019
2356	ALDRIN	508	Y	MRL	0.05 UG/L		01-01-2011	12-31-2019
2383	TOTAL POLYCHLORINATED BIPHENYLS (PCB)	508	Y	MRL	0.1 UG/L		01-01-2011	12-31-2019
2775	TOTAL DDT	508	Y	MRL	1 UG/L		01-01-2011	12-31-2019
2931	1,2-DIBROMO-3-CHLOROPROPANE	504.1	Y	MRL	0.02 UG/L		01-01-2011	12-31-2019
2946	ETHYLENE DIBROMIDE	504.1	Y	MRL	0.01 UG/L		01-01-2011	12-31-2019
2959	CHLORDANE	508	Y	MRL	0.2 UG/L		01-01-2011	12-31-2019

Total Number of Records Fetched = 35

Drinking Water Branch

Chem/Rad Sample Results

Return Links

[Chem/Rad
Samples](#)

[Analyte List](#)

[Water System
Detail](#)

[Water Systems](#)

[Water System
Search](#)

[County Map](#)

[Glossary](#)

Water System No. :	IL0855150	Federal Type :	C
Water System Name :	PRAIRIE PATH WATER COMPANY-APPLE CANYON	State Type :	C
Principal County Served :	JO DAVIESS	Primary Source :	GW
Status :	A	Activity Date :	01-01-1970
Lab Sample No. :	GG04807-01	Collection Date :	07-25-2023

This list displays sample/results of all non-microbial analytes (TSAANLYT.TYPE_CODE <> MOR) associated to the selected sample. Results for Microbial Analytes are not included.

Analyte Code	Analyte Name	Method Code	Less than Indicator	Level Type	Reporting Level	Concentration level	Monitoring Period Begin Date	Monitoring Period End Date
4010	COMBINED RADIUM (-226 & -228)	null	null		null null	4.38 PCI/L	01-01-2023	12-31-2025
4020	RADIUM-226	903.1			0	3.07 PCI/L		
4030	RADIUM-228	904.0			0	1.31 PCI/L		

Total Number of Records Fetched = 3

Drinking Water Branch

Chem/Rad Sample Results

Return Links

[Chem/Rad
Samples](#)

[Analyte List](#)

[Water System
Detail](#)

[Water Systems](#)

[Water System
Search](#)

[County Map](#)

[Glossary](#)

Water System No. :	IL0855150	Federal Type :	C
Water System Name :	PRAIRIE PATH WATER COMPANY-APPLE CANYON	State Type :	C
Principal County Served :	JO DAVIESS	Primary Source :	GW
Status :	A	Activity Date :	01-01-1970
Lab Sample No. :	0076499-01	Collection Date :	07-30-2020

This list displays sample/results of all non-microbial analytes (TSAANLYT.TYPE_CODE <> MOR) associated to the selected sample. Results for Microbial Analytes are not included.

Analyte Code	Analyte Name	Method Code	Less than Indicator	Level Type	Reporting Level	Concentration level	Monitoring Period Begin Date	Monitoring Period End Date
4010	COMBINED RADIUM (-226 & -228)	null	null		null null	1.05 PCI/L	01-01-2020	12-31-2022
4020	RADIUM-226	903.1			0	1.05 PCI/L		
4030	RADIUM-228	904.0	Y	MRL	0.621 PCI/L			
4109	GROSS ALPHA PARTICLE ACTIVITY	900.0			0	5.17 PCI/L	01-01-2020	12-31-2025

Total Number of Records Fetched = 4

Drinking Water Branch

Chem/Rad Sample Results

Return Links

[Chem/Rad
Samples](#)

[Analyte List](#)

[Water System
Detail](#)

[Water Systems](#)

[Water System
Search](#)

[County Map](#)

[Glossary](#)

Water System No. :	IL0855150	Federal Type :	C
Water System Name :	PRAIRIE PATH WATER COMPANY-APPLE CANYON	State Type :	C
Principal County Served :	JO DAVIESS	Primary Source :	GW
Status :	A	Activity Date :	01-01-1970
Lab Sample No. :	0076499-02	Collection Date :	07-30-2020

This list displays sample/results of all non-microbial analytes (TSAANLYT.TYPE_CODE <> MOR) associated to the selected sample. Results for Microbial Analytes are not included.

Analyte Code	Analyte Name	Method Code	Less than Indicator	Level Type	Reporting Level	Concentration level	Monitoring Period Begin Date	Monitoring Period End Date
4010	COMBINED RADIUM (-226 & -228)	null	null		null null	1.25 PCI/L	01-01-2020	12-31-2022
4020	RADIUM-226	903.1			0	0.58 PCI/L		
4030	RADIUM-228	904.0			0	0.669 PCI/L		
4109	GROSS ALPHA PARTICLE ACTIVITY	900.0	Y	MRL	2.72 PCI/L		01-01-2020	12-31-2025

Total Number of Records Fetched = 4

Drinking Water Branch

Chem/Rad Sample Results

Return Links

[Chem/Rad
Samples](#)

[Analyte List](#)

[Water System
Detail](#)

[Water Systems](#)

[Water System
Search](#)

[County Map](#)

[Glossary](#)

Water System No. :	IL0855150	Federal Type :	C
Water System Name :	PRAIRIE PATH WATER COMPANY-APPLE CANYON	State Type :	C
Principal County Served :	JO DAVIESS	Primary Source :	GW
Status :	A	Activity Date :	01-01-1970
Lab Sample No. :	7072192-01	Collection Date :	07-11-2017

This list displays sample/results of all non-microbial analytes (TSAANLYT.TYPE_CODE <> MOR) associated to the selected sample. Results for Microbial Analytes are not included.

Analyte Code	Analyte Name	Method Code	Less than Indicator	Level Type	Reporting Level	Concentration level	Monitoring Period Begin Date	Monitoring Period End Date
4010	COMBINED RADIUM (-226 & -228)	null	null		null null	1.62 PCI/L	01-01-2017	12-31-2019
4020	RADIUM-226	903.1			0	0.96 PCI/L		
4030	RADIUM-228	904.0			0	0.663 PCI/L		

Total Number of Records Fetched = 3

Drinking Water Branch

Chem/Rad Sample Results

Return Links

[Chem/Rad
Samples](#)

[Analyte List](#)

[Water System
Detail](#)

[Water Systems](#)

[Water System
Search](#)

[County Map](#)

[Glossary](#)

Water System No. :	IL0855150	Federal Type :	C
Water System Name :	PRAIRIE PATH WATER COMPANY-APPLE CANYON	State Type :	C
Principal County Served :	JO DAVIESS	Primary Source :	GW
Status :	A	Activity Date :	01-01-1970
Lab Sample No. :	5071155-01	Collection Date :	07-07-2015

This list displays sample/results of all non-microbial analytes (TSAANLYT.TYPE_CODE <> MOR) associated to the selected sample. Results for Microbial Analytes are not included.

Analyte Code	Analyte Name	Method Code	Less than Indicator	Level Type	Reporting Level	Concentration level	Monitoring Period Begin Date	Monitoring Period End Date
4010	COMBINED RADIUM (-226 & -228)	null	null		null null	1.93 PCI/L	01-01-2014	12-31-2019
4020	RADIUM-226	903.1			0	1.07 PCI/L		
4030	RADIUM-228	904.0			0	0.864 PCI/L		
4109	GROSS ALPHA PARTICLE ACTIVITY	900			0	1.87 PCI/L	01-01-2014	12-31-2019

Total Number of Records Fetched = 4

Drinking Water Branch

Chem/Rad Sample Results

Return Links

[Chem/Rad
Samples](#)

[Analyte List](#)

[Water System
Detail](#)

[Water Systems](#)

[Water System
Search](#)

[County Map](#)

[Glossary](#)

Water System No. :	IL0855150	Federal Type :	C
Water System Name :	PRAIRIE PATH WATER COMPANY-APPLE CANYON	State Type :	C
Principal County Served :	JO DAVIESS	Primary Source :	GW
Status :	A	Activity Date :	01-01-1970
Lab Sample No. :	4071413-01	Collection Date :	07-08-2014

This list displays sample/results of all non-microbial analytes (TSAANLYT.TYPE_CODE <> MOR) associated to the selected sample. Results for Microbial Analytes are not included.

Analyte Code	Analyte Name	Method Code	Less than Indicator	Level Type	Reporting Level	Concentration level	Monitoring Period Begin Date	Monitoring Period End Date
4010	COMBINED RADIUM (-226 & -228)	null	null		null null	3.50 PCI/L	01-01-2014	12-31-2016
4020	RADIUM-226	903.1			0	1.62 PCI/L		
4030	RADIUM-228	904.0			0	1.88 PCI/L		
4109	GROSS ALPHA PARTICLE ACTIVITY	900			0	6.2 PCI/L	01-01-2014	12-31-2019

Total Number of Records Fetched = 4