

CANCELING

SHEET NO.

RECEIVED**OCT 27 2005**State of Alaska
Regulatory Commission of Alaska

COLLEGE UTILITIES CORPORATION

TITLE PAGE

COLLEGE UTILITIES CORP.
PO BOX 80370
FAIRBANKS, AK 99708-0370WASTEWATER SERVICE

APPLICABLE TO ENTIRE SERVICE AREA

RATES, RULES AND REGULATIONS

TARIFF #3
CANCELING CUC TARIFF #2

College Utilities Corporation hereby adopts, as if it had been originally filed by them, Golden Heart Utilities, Inc. Tariff #290 filed on or after October 25, 2005. By this notice, College Utilities Corporation also adopts and ratifies all supplements and amendments to the above referenced Golden Heart Utilities, Inc. tariff.

PURSUANT TO:

TARIFF ADVICE NO: 89-37

EFFECTIVE: January 19, 2006

ISSUED BY: COLLEGE UTILITIES CORPORATION

BY:

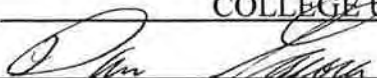

Dan Gavora

Title: President/CEO

CANCELING

1st REVISION

SHEET NO. 2

RECEIVED**JUN 03 2015**STATE OF ALASKA
REGULATORY COMMISSION OF ALASKA

COLLEGE UTILITIES CORPORATION

TABLE OF CONTENTS

TABLE OF CONTENTS

SECTION

BEGINNING AT
SHEET #

SERVICE AREA	
Service Area Map	3
Service Area Description	4
9. RULE & RATE CHANGES	5
5221 Single Residential Units Metered Wastewater Service	6
52212 Duplex Residential Units Metered Wastewater Service	7
5225 Multiple Residential Units Metered Wastewater Service	8
5211 Single Residential Units Unmetered Wastewater Service	9
52114 Duplex Residential Units Unmetered Wastewater Service ...	10
52116 Triplex Residential Unites Unmetered Wastewater Service..	11
5222 Commercial Metered Wastewater Service	12
5224 Public Authority Metered Wastewater Service	13
5250 Interdepartmental Sales Metered Wastewater Service	14
SCIAC-1 Combined CIAC	15
SCIAC-2 Onsite CIAC	16
SCIAC-3 Offsite CIAC	17
10. SCHEDULE OF WASTEWATER NON-RECURRING FEES	19
11. COST OF ENERGY ADJUSTMENT	21
12. PLANT REPLACEMENT IMPROVEMENT SURCHARGE	24

N

Pursuant to U-15-089(18)/U-15-091(18)/U-15-092(18)

TARIFF ADVICE NO: 121-37

EFFECTIVE: May 26, 2016

ISSUED BY: COLLEGE UTILITIES CORPORATION

BY:

Oran Paul

Title: President

RCA NO. 37

1st REVISION

SHEET NO. 3

CANCELING

ORIGINAL

SHEET NO.

RECEIVED

SEP 21 2009

STATE OF ALASKA
REGULATORY COMMISSION OF ALASKA

COLLEGE UTILITIES CORPORATION
SERVICE AREA MAP (WASTEWATER)

WASTEWATER SERVICE AREA

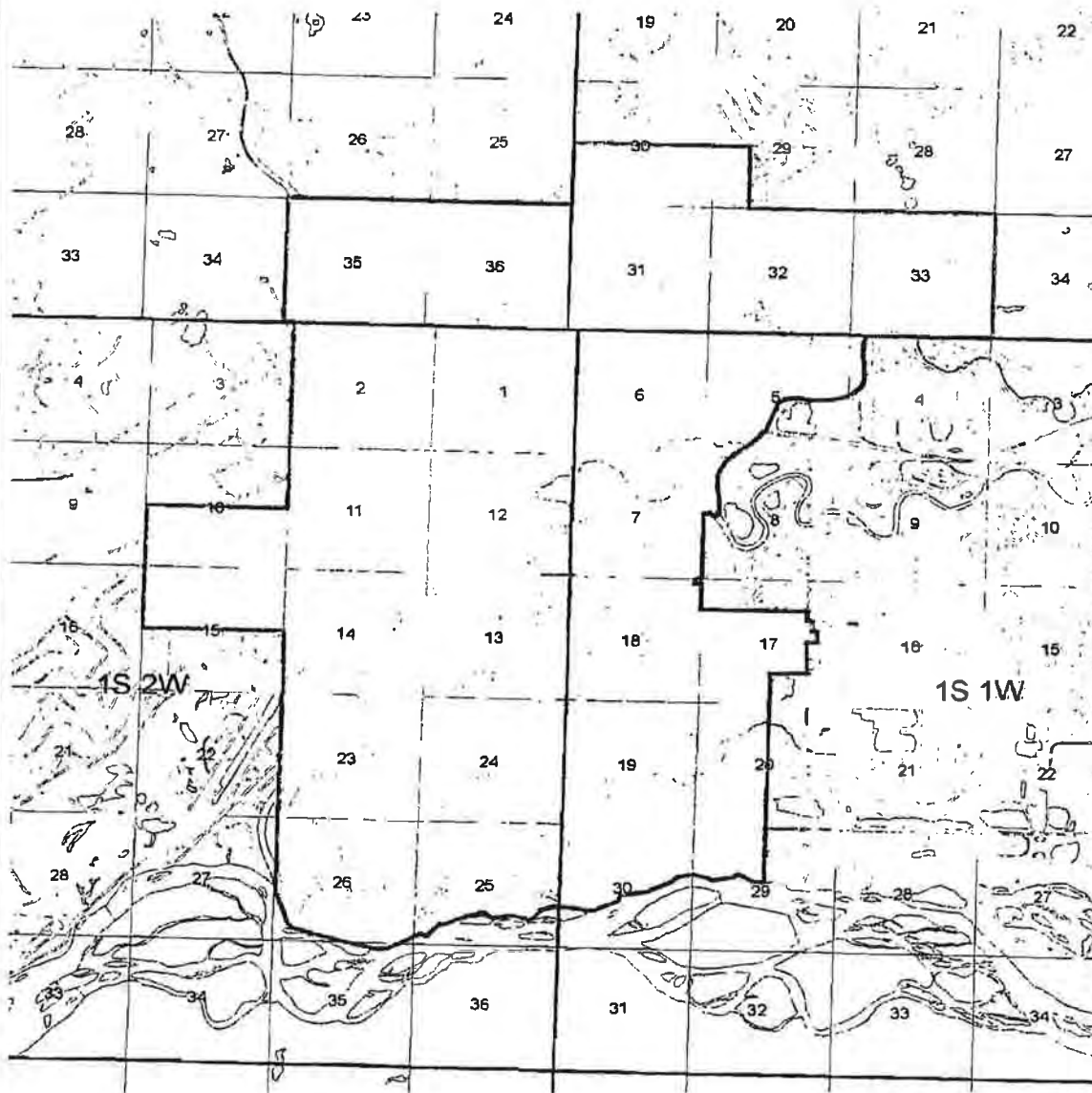

Pursuant to
U-09-105(2)/U-09-106(2)

TARIFF ADVICE NO:

EFFECTIVE:

March 19, 2010

ISSUED BY: COLLEGE UTILITIES CORPORATION

BY: 
Dan Gavora

Title: President/CEO

RCA NO. 37

2nd REVISION

SHEET NO. 4

RECEIVED

SEP 21 2009

CANCELING

1st REVISION

SHEET NO. 4

STATE OF ALASKA
REGULATORY COMMISSION OF ALASKA

COLLEGE UTILITIES CORPORATION

SERVICE AREA DESCRIPTION (WASTEWATER)

SERVICE AREA DESCRIPTION

T1S R2W Sections: 1, 2, S1/2 of 10, 11, 12, 13, 14, N1/2 of 15, 23, 24, and those portions of 25, 26, and 35 lying North of the right bank of the Tanana River T

T1S R1W Sections: That portion of W1/2 of W1/2 of NW1/4 of 4 lying West of Noyes Slough; that portion of 5 lying North of Noyes Slough; 6, 7, and that portion of W1/2 of NW1/4 of 8 lying West of Noyes Slough and North of the Chena River; SW1/4 of 17; S1/2 of NW1/4 of 17; SW1/4 of NE1/4 of 17; that portion of SE1/4 of NE1/4 of 17 more particularly described as the W1/2 of Block 13 and Block 16 of the E. M. Jones Subdivision; NW1/4 of SE1/4 of 17; 18, except a portion of the NE1/4 more particularly described as Lots 1 and 2, Block One, West Addition Fairwest Subdivision, filed in the Fairbanks Recording District on January 24, 1968, as Instrument No. 64-486; 19; W1/2 of 20; and that portion of the W1/2 of 29 and that portion of 30 lying North of the right bank of the Tanana River.

T1N R1W Sections: W1/2 of SW1/4 of 29; S1/2 of 30; 31; 32; and 33

T1N R2W Sections: 35 and 36

(All the above with reference to the Fairbanks Meridian)

Pursuant to
U-09-105(2)/U-09-106(2)

March 19, 2010

TARIFF ADVICE NO:

EFFECTIVE:

ISSUED BY: COLLEGE UTILITIES CORPORATION

BY: 
Dan Gavora

Title: President/CEO

RCA NO. 37

ORIGINAL

SHEET NO. 5

CANCELING

SHEET NO.

RECEIVED

OCT 27 2005

State of Alaska
Regulatory Commission of AlaskaCOLLEGE UTILITIES CORPORATION
RULE & RATE CHANGES EXTENSION

9. RULE & RATE CHANGES

The Utility reserves the right at any time to alter, amend, change, or add to these rules, regulations, and conditions of service, or to substitute other rules and regulations, and to change rates, subject to the approval of the Alaska Public Utilities Commission, or other regulatory body having jurisdiction thereof.

PURSUANT TO:

TARIFF ADVICE NO:

89-37

EFFECTIVE:

January 19, 2006

ISSUED BY:

COLLEGE UTILITIES CORPORATION

BY:

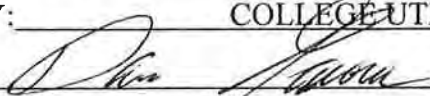

Dan Gavora

Title: President/CEO

RATE SCHEDULE NUMBER 5221 SINGLE RESIDENTIAL UNITS / METERED WASTEWATER SERVICE				
APPLICABLE TO:				
All single residential units with metered wastewater service.				
RATES:				
Customer fixed fee charges shall be the minimum monthly fee for customers receiving both water and wastewater service. Customer fixed fee charges and a meter fee shall be the minimum monthly fee for customers receiving only wastewater service.				
Usage charge shall be in addition to the minimum monthly fee and based upon consumption measured by the water meter during the period from September through April.				
For customers receiving both water and wastewater service, usage charge on consumption from May through August shall have a maximum, said maximum being the average consumption from September through April rounded up to the next 1,000 gallons. For new customers with no history, the maximum shall be 6,000 gallons.				
<u>Customer Fixed Fee</u>	<u>Minimum Monthly Fee</u>			
\$22.55	\$22.55			I
<u>Meter Size (Inches)</u>	<u>Customer Fixed Fee</u>	<u>Meter Charge</u>	<u>Minimum Monthly Fee (sewer only customer)</u>	
3/4"	\$22.55	\$17.65	\$40.20	I
1"	\$22.55	\$28.22	\$50.77	I
1 1/2"	\$22.55	\$56.34	\$78.89	I
Usage Charge Per 1,000 Gallons		\$18.01		I

PURSUANT TO: **U-24-030(1)/U-24-031(1)**

TARIFF ADVICE NO: 179-37EFFECTIVE: 9/27/2024

ISSUED BY: COLLEGE UTILITIES CORPORATION

BY: /s/ Oran Paul Title: President
Oran Paul

RATE SCHEDULE NUMBER 52212 DUPLEX RESIDENTIAL UNITS / METERED WASTEWATER SERVICE				
APPLICABLE TO:				
All duplex residential units with metered wastewater service.				
RATES:				
Customer fixed fee charges shall be the minimum monthly fee for customers receiving both water and wastewater service. Customer fixed fee charges and a meter fee shall be the minimum monthly fee for customers receiving only wastewater service.				
Usage charge shall be in addition to the minimum monthly fee and based upon consumption measured by the water meter during the period from September through April.				
For customers receiving both water and wastewater service, usage charge on consumption from May through August shall have a maximum, said maximum being the average consumption from September through April rounded up to the next 1,000 gallons. For new customers with no history, the maximum shall be 10,000 gallons.				
Customer Fixed Fee	Minimum Monthly Fee			
\$29.67	\$29.67			I
Meter Size (Inches)	Customer Fixed Fee	Meter Charge	Minimum Monthly Fee (sewer only customer)	
3/4"	\$29.67	\$17.65	\$47.32	I
1"	\$29.67	\$28.22	\$57.89	I
1 1/2"	\$29.67	\$56.34	\$86.01	I
Usage Charge Per 1,000 Gallons		\$17.97		I

PURSUANT TO: **U-24-030(1)/U-24-031(1)**

TARIFF ADVICE NO: 179-37EFFECTIVE: 9/27/2024

ISSUED BY: COLLEGE UTILITIES CORPORATION

BY: /s/ Oran PaulTitle: President
Oran Paul

RATE SCHEDULE NUMBER 5225 MULTIPLE RESIDENTIAL UNITS / METERED WASTEWATER SERVICE				
APPLICABLE TO:				
All multiple residential units with metered wastewater service.				
RATES:				
Customer fixed fee charges shall be the minimum monthly fee for customers receiving both water and wastewater service. Customer fixed fee charges and a meter fee shall be the minimum monthly fee for customers receiving only wastewater service.				
Usage charge shall be in addition to the minimum monthly fee and based upon consumption measured by the water meter.				
<u>Customer Fixed Fee</u>	<u>Minimum Monthly Fee</u>			
\$74.53	\$74.53			
				I
<u>Meter Size (Inches)</u>	<u>Customer Fixed Fee</u>	<u>Meter Charge</u>	<u>Minimum Monthly Fee (sewer only customer)</u>	
3/4"	\$74.53	\$17.65	\$92.18	I
1"	\$74.53	\$28.22	\$102.75	I
1 1/2"	\$74.53	\$56.34	\$130.87	I
2"	\$74.53	\$90.14	\$164.67	I
3"	\$74.53	\$169.06	\$243.59	I
Usage Charge Per 1,000 Gallons	\$18.80			I

PURSUANT TO: **U-24-030(1)/U-24-031(1)**

TARIFF ADVICE NO: 179-37EFFECTIVE: 9/27/2024

ISSUED BY: COLLEGE UTILITIES CORPORATION

BY: /s/ Oran PaulTitle: President

Oran Paul

9

9

President

10

10

Oran Paul

RATE SCHEDULE NUMBER 52116			
TRIPLEX RESIDENTIAL UNITS / UNMETERED WASTEWATER SERVICE			
APPLICABLE TO:			
All triplex residential units with unmetered wastewater service.			
RATES:			
Customer Fixed Fee	Customer Usage (1)	Total Monthly Fee	
\$74.53	\$370.23	\$444.76	I
	(1) Customer Usage	\$123.41 per unit per month.	I

PURSUANT TO: **U-24-030(1)/U-24-031(1)**

TARIFF ADVICE NO: 179-37EFFECTIVE: 9/27/2024

ISSUED BY: COLLEGE UTILITIES CORPORATION

BY: /s/ Oran PaulTitle: President

Oran Paul

RATE SCHEDULE NUMBER 5222 COMMERCIAL / METERED WASTEWATER SERVICE				
APPLICABLE TO:				
All commercial and educational buildings with metered wastewater service.				
RATES:				
Customer fixed fee charges shall be the minimum monthly fee for customers receiving both water and wastewater service. Customer fixed fee charges and a meter fee shall be the minimum monthly fee for customers receiving only wastewater service.				
Usage charge shall be in addition to the minimum monthly fee and based upon consumption measured by the water meter.				
<u>Customer Fixed Fee</u>	<u>Minimum Monthly Fee</u>			
\$95.51	\$95.51			
<u>Meter Size (Inches)</u>	<u>Customer Fixed Fee</u>	<u>Meter Charge</u>	<u>Minimum Monthly Fee (sewer only customer)</u>	
3/4"	\$95.51	\$23.17	\$118.68	I
1"	\$95.51	\$38.68	\$134.19	I
1 1/2"	\$95.51	\$77.10	\$172.61	I
2"	\$95.51	\$123.41	\$218.92	I
3"	\$95.51	\$231.55	\$327.06	I
4"	\$95.51	\$386.00	\$481.51	I
6"	\$95.51	\$771.75	\$867.26	I
8"	\$95.51	\$1,234.88	\$1,330.39	I
10"	\$95.51	\$1,775.79	\$1,871.30	I
Usage Charge Per 1,000 Gallons		\$18.80		

PURSUANT TO: **U-24-030(1)/U-24-031(1)**

TARIFF ADVICE NO: 179-37EFFECTIVE: 9/27/2024

ISSUED BY: COLLEGE UTILITIES CORPORATION

BY: /s/ Oran Paul Title: President
Oran Paul

RATE SCHEDULE NUMBER 5224 PUBLIC AUTHORITY METERED WASTEWATER SERVICE (UNIVERSITY OF ALASKA FAIRBANKS)			
APPLICABLE TO:			
University of Alaska Fairbanks campus that has a wholly owned wastewater collection system that interconnects to the CUC wastewater system at Geist Road.			
RATES:			
Customer fixed fee shall be the minimum monthly fee.			
Usage charge shall be in addition to the minimum monthly fee and based upon consumption measured by the CUC Geist Road wastewater flow meter.			
Customer Fixed Fee	Minimum Monthly Fee		
\$9,496.11	\$9,496.11		I
Usage Charge Per 1,000 Gallons	\$7.22		I

PURSUANT TO: U-24-030(1)/U-24-031(1)

TARIFF ADVICE NO: 179-37EFFECTIVE: 9/27/2024

ISSUED BY: COLLEGE UTILITIES CORPORATION

BY: /s/ Oran PaulTitle: President
Oran Paul

RATE SCHEDULE NUMBER 5250 INTERDEPARTMENTAL SALES / METERED WASTEWATER SERVICE				
APPLICABLE TO:				
CUC water department facilities with metered wastewater service.				
RATES:				
Customer fixed fee charges shall be the minimum monthly fee for customers receiving both water and wastewater service. Customer fixed fee charges and a meter fee shall be the minimum monthly fee for customers receiving only wastewater service.				
Usage charge shall be in addition to the minimum monthly fee and based upon consumption measured by the water meter.				
<u>Customer Fixed Fee</u>	<u>Minimum Monthly Fee</u>			
\$95.51	\$95.51			
<u>Meter Size (Inches)</u>	<u>Customer Fixed Fee</u>	<u>Meter Charge</u>	<u>Minimum Monthly Fee (sewer only customer)</u>	
3/4"	\$95.51	\$23.17	\$118.68	I
1"	\$95.51	\$38.68	\$134.19	I
1 1/2"	\$95.51	\$77.10	\$172.61	I
2"	\$95.51	\$123.41	\$218.92	I
3"	\$95.51	\$231.55	\$327.06	I
4"	\$95.51	\$386.00	\$481.51	I
6"	\$95.51	\$771.75	\$867.26	I
8"	\$95.51	\$1,234.88	\$1,330.39	I
Usage Charge Per 1,000 Gallons		\$18.80		

PURSUANT TO: **U-24-030(1)/U-24-031(1)**

TARIFF ADVICE NO: 179-37EFFECTIVE: 9/27/2024

ISSUED BY: COLLEGE UTILITIES CORPORATION

BY: /s/ Oran PaulTitle: President

Oran Paul

CANCELING

SHEET NO.

COLLEGE UTILITIES CORPORATION

RATE SCHEDULE

RECEIVED

OCT 27 2005

State of Alaska
Regulatory Commission of Alaska

RATE SCHEDULE NUMBER SCIAAC-1
COMBINED
CONTRIBUTION IN AID OF CONSTRUCTION (CIAC)
SERVICE AVAILABLE AS OF JANUARY 1, 1981

APPLICABLE TO:

Customers with lots which have service available directly from existing mains as of January 1, 1981, and are not paid or under contract as of that date.

NOTE: Minor main extensions may be made by the Utility under this CIAC rate.

Owners of residential properties containing a single one family residence may elect to limit their CIAC to a designated one-half acre area. The CIAC on the remaining property may thus be postponed until the remainder is developed.

RATES:

CIAC charge will be computed upon the square footage of the entire area being served, generally the smallest legally subdivided lot or lots on which all benefited improvements are located, said amount to be computed to the nearest cent. Hookup saddles will be included in CIAC.

<u>Effective Dates</u>	<u>Rate per square Foot</u>
6/4/82 - 12/31/82	\$.18
1/1/83 - 12/31/83	\$.205
1/1/84 - 12/31/84	\$.23
1/1/85 - 12/31/85	\$.255

Rate effective 6/4/82
TA24-37, Docket U-81-24, Order #4

PURSUANT TO:

TARIFF ADVICE NO: 89-37

EFFECTIVE: January 19, 2006

ISSUED BY: COLLEGE UTILITIES CORPORATION

BY:

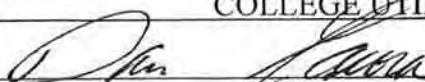

Dan Gavora

Title: President/CEO

RCA NO. 37

ORIGINAL

SHEET NO. 16

CANCELING

SHEET NO.

RECEIVED**OCT 27 2005**State of Alaska
Regulatory Commission of Alaska

COLLEGE UTILITIES CORPORATION

RATE SCHEDULE

RATE SCHEDULE NUMBER SCIAM-2

ONSITE

CONTRIBUTION IN AID OF CONSTRUCTION (CIAC)

SERVICE NOT AVAILABLE AS OF 1/1/81

APPLICABLE TO:

Customers in the service area with lots, which do not have service available directly from existing mains as of January 1, 1981, and are not paid or under contract as of that date. In order to serve the customer, the Utility will need to perform major expansion of its main lines.

Onsite CIAC portion limited to cost to construct an equivalent 10" diameter main. The oversizing cost shall be computed on the differential purchase price on pipe and insulation.

RATE:

Systems constructed subsequent to January 1, 1981, shall be assessed for the onsite portion, if applicable, on the basis of prorating to the benefited property 100% of the cost incurred by the Utility, including overhead and interest during construction.

Additionally, a charge for offsite CIAC at a rate of three cents (\$.03) per square foot of assessable area shall be charged prior to connection to the Utility main. (For pumping, interceptor and collection-trunk wastewater components.) See Rate Schedule SCIAM-3.

The cost of connection saddles shall be included in the offsite CIAC.

PURSUANT TO:

TARIFF ADVICE NO: 89-37

EFFECTIVE: January 19, 2006

ISSUED BY: COLLEGE UTILITIES CORPORATION

BY:

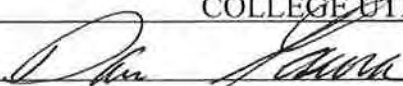

Dan Gavora

Title: President/CEO

RCA NO. 37

ORIGINAL

SHEET NO. 17

CANCELING

SHEET NO.

RECEIVED

OCT 27 2005

State of Alaska
Regulatory Commission of Alaska

COLLEGE UTILITIES CORPORATION

RATE SCHEDULE

RATE SCHEDULE NUMBER SCIA-3
OFFSITE
CONTRIBUTIONS IN AID OF CONSTRUCTION (CIAC)

APPLICABLE TO:

All customers requesting a new service connection except those which qualify under Rate Schedule SCIA-1 (Combined SCIA).

RATES:

Three cents (\$.03) per square foot of tract being served.

SPECIAL CONDITIONS

Owners of residential properties containing a single one family residence may elect to limit their offsite CIAC to a designated one-half acre. The Offsite CIAC on the remaining property may thus be postponed until the remainder is developed.

See Section 1.2 for definitions of Offsite, Onsite, and Contributions in Aid of Construction.

Rate effective 6/4/82

TA 24-37, Docket U-81-24, Order #4

PURSUANT TO:

TARIFF ADVICE NO: 89-37

EFFECTIVE: January 19, 2006

ISSUED BY: COLLEGE UTILITIES CORPORATION

BY:

Dan Gavora

Title: President/CEO

RCA NO. 37 1ST REVISION SHEET NO. 18

CANCELING

ORIGINAL SHEET NO. 18

RECEIVED

FEB 16 2006

State of Alaska
Regulatory Commission of Alaska

COLLEGE UTILITIES CORPORATION
SCHEDULE OF WASTEWATER DEPOSITS

THIS PAGE INTENTIONALLY LEFT BLANK

d

PURSUANT TO:

TARIFF ADVICE NO: 90-37

EFFECTIVE: March 2, 2006

ISSUED BY: COLLEGE UTILITIES CORPORATION

BY:



Daniel Britton

Title: Vice President

CANCELING

ORIGINAL

SHEET NO. 19

RECEIVED

FEB 16 2006

State of Alaska
Regulatory Commission of Alaska

COLLEGE UTILITIES CORPORATION

NON-RECURRING FEES

THIS PAGE INTENTIONALLY LEFT BLANK

d

PURSUANT TO:

TARIFF ADVICE NO: 90-37

EFFECTIVE: March 2, 2006

ISSUED BY: COLLEGE UTILITIES CORPORATION

BY:



Daniel Britton

Title: Vice President

RCA NO. 37

1st REVISION

SHEET NO. 20

CANCELING

ORIGINAL

SHEET NO. 20

RECEIVED

FEB 16 2006

State of Alaska
Regulatory Commission of Alaska

COLLEGE UTILITIES CORPORATION

NON-RECURRING FEES

THIS PAGE INTENTIONALLY LEFT BLANK

d

PURSUANT TO:

TARIFF ADVICE NO: 90-37

EFFECTIVE: March 2, 2006

ISSUED BY: COLLEGE UTILITIES CORPORATION

BY:



Daniel Britton

Title: Vice President

CANCELING

4th REVISION SHEET NO. 21

COLLEGE UTILITIES CORPORATION

COST OF ENERGY ADJUSTMENT

RECEIVED**AUG 13 2024**STATE OF ALASKA
REGULATORY COMMISSION OF ALASKA

COST OF ENERGY ADJUSTMENT CLAUSE

a. Applicability:

The categories of purchased power, purchased heat, purchased natural gas and transportation expense (limited to fuel used in utility-owned vehicles) are volatile and largely beyond the control of the utility. The cost of energy adjustment provides a mechanism to adjust rates for the changes in the cost of energy.

b. Cost of Energy Adjustment:

The Cost of Energy included in the base rate per 1000 gallons sold is \$1.76672. I

Invoices to customers will be increased to reflect the amounts by which the cost of energy per 1000 gallons sold exceeds the base rate and decreased to reflect the amount by which the cost of energy per 1000 gallons sold is less than the base rate in accordance with the procedure set forth in (d) from Sheet 22.

c. Cost of Energy Balance Account:

The utility shall maintain a Cost of Energy Balance Account commencing February, 2010. The Cost of Energy Balance Account will commence with a zero balance on February 1, 2010 with balances thereafter reflecting the sum of the debit and credit entries prescribed below:

1. A debit entry equal to the actual purchased power, purchased heat, purchased natural gas and transportation expense (limited to fuel used in utility-owned vehicles) during each month.
2. A credit entry equal to the number of gallons sold during the month multiplied by the cost of energy included in the base rate.
3. A credit entry equal to the number of gallons sold during the month multiplied by the cost of energy adjustment per 1000 gallons sold as computed in (d) from Sheet 22.
4. Any necessary correcting entries to adjust the cost of energy or the cost and volume of energy in (1) above, subject to subsequent review and approval by the Commission.

PURSUANT TO: **U-24-030(1)/U-24-031(1)**

TARIFF ADVICE NO: 179-37

EFFECTIVE: 9/27/2024

ISSUED BY: COLLEGE UTILITIES CORPORATION

BY: /s/ Oran Paul

Oran Paul

Title: President

d. Determination of Wastewater Cost of Energy Adjustment:					
CURRENT COST OF ENERGY PROJECTION:					
	GHU	CUC	USA	Total Cost Projection	
Purchased Power	\$ 1,586,950	\$ 129,052		\$ 1,716,003	
Purchased Heat	\$ 3,719	\$ 3,251		\$ 6,970	
Purchased Natural Gas	\$ 155,828	\$ 4,865		\$ 160,693	
Transportation	\$ 103,019	\$ 30,523	\$ 3,398	\$ 136,940	
Total Energy Cost (a)	\$ 1,849,516	\$ 167,692	\$ 3,398	\$ 2,020,605	R
CURRENT SALES VOLUMES PROJECTION:					
	GHU	CUC	Total Sales Projection		
Residential Metered	129,130,351	52,522,734	181,653,085		
Duplex Metered	39,980,524	7,879,524	47,860,048		
Multiple Residential	133,982,699	36,900,304	170,883,003		
Commercial	221,571,762	89,811,701	311,383,463		
Public Authority - FWW/UAF	387,939,450	63,975,000	451,914,450		
Industrial - Fish Hatchery	1,555,224	-	1,555,224		
Wholesale - Lakeview	5,461,082	-	5,461,082		
Septage Hauler	9,219,332	-	9,219,332		
Interdepartment Metered	933,191	196,065	1,129,256		
Total Sales Volume (b)	929,773,614	251,285,328	1,181,058,942		I
ENERGY ADJUSTMENT RATE CALCULATION:					
1. Total Projected Energy Cost			\$ 2,020,605		
2. Balancing Account Balance at 9/30/2024			\$ (174,795)		R
3. Total (1+2)			\$ 1,845,810		
4. Projected Total Sales Volume (in thousands)			1,181,059		
5. Projected Cost of Energy per 1000 gallons (3/4)			\$ 1.56284		
6. Base Cost of Energy per 1000 gallons			\$ 1.76672		
7. Cost of Energy Adjustment per 1000 gallons (5-6)			\$ (0.20388)		R

CANCELING

SHEET NO.

RECEIVED

JAN 26 2010

STATE OF ALASKA
REGULATORY COMMISSION OF ALASKA

COLLEGE UTILITIES CORPORATION

COST OF ENERGY ADJUSTMENT

e. Cost of Energy Filing Requirements and Supporting Documents: N

The utility shall submit each cost of energy adjustment request as a tariff filing within 45 days after the end of each quarter year. The filing shall include:

1. Copy of invoices supporting the purchased power, purchased heat, purchased natural gas and transportation expense (limited to fuel used in utility-owned vehicles);
2. Gallons sold by utility, by customer class, by month;
3. Fluctuation analysis and explanation for changing month-to-month costs by category;
4. The Cost of Energy calculation;
5. Documentation in support of projected costs and sales for the future period;
6. Calculation of monthly balances in the cost-of-energy balancing account; and
7. Revised tariff sheets.

Within 45 days after the last day of any month in which the absolute value of the cost-of-energy balancing account balance exceeds 10 percent of the utility's annual allowed energy adjustment costs, the utility shall submit a Cost of Energy tariff filing.

 N

PURSUANT TO:

TARIFF ADVICE NO: 97-37

EFFECTIVE: February 1, 2010

ISSUED BY: COLLEGE UTILITIES CORPORATION

BY: Oran Paul

Oran Paul

Title: C.O.O.

CANCELING

SHEET NO.

RECEIVED**JUN 03 2015**

COLLEGE UTILITIES CORPORATION

PLANT REPLACEMENT IMPROVEMENT SURCHARGE MECHANISM

STATE OF ALASKA
REGULATORY COMMISSION OF ALASKAPLANT REPLACEMENT AND IMPROVEMENT SURCHARGE MECHANISM
(PRISM)

N

a. Applicability:

To recover the reasonable and prudent fixed costs incurred to repair, improve, or replace certain non-revenue producing plant placed in service between general rate cases. The costs of extending facilities to serve new customers are not recoverable through the PRISM.

b. Eligible Property:

The PRISM-eligible property will consist of the following:

- Collection sewers, collecting mains, and service laterals, including sewer taps, curbstops, and lateral cleanouts, installed as in-kind replacements for customers.
- Collection mains and valves for gravity and pressure systems and related facilities such as manholes, grinder pumps, air and vacuum release chambers, cleanouts, main line flow meters, valve vaults, and lift stations installed as replacements or upgrades for existing facilities that remain in service beyond reasonable service life, are in prematurely deteriorated condition, or are required to be upgraded to meet quality-of-service standards or applicable law.
- Collection main extensions installed to implement solutions to wastewater problems that present a significant health or safety concern for customers currently receiving service from the utility.
- Collection main rehabilitation including inflow and infiltration projects.
- Unreimbursed costs related to highway relocation projects where the utility must relocate its facilities.
- Other capitalized costs related to plant described above.

c. Effective Date:

The PRISM rate will become effective for bills rendered on or after October 1, 2016.

Pursuant to U-15-089(19)/U-15-091(19)/U-15-092(19)

TARIFF ADVICE NO: 121-37

EFFECTIVE: June 16, 2016

ISSUED BY: COLLEGE UTILITIES CORPORATION

BY:



Oran Paul

Title: President

CANCELING

SHEET NO.

RECEIVED**JUN 08 2016**STATE OF ALASKA
REGULATORY COMMISSION OF ALASKA

COLLEGE UTILITIES CORPORATION

PLANT REPLACEMENT IMPROVEMENT SURCHARGE MECHANISM

d. Computation:

The initial charge in this tariff is 0.00%. The PRISM rate to become effective October 1, 2016, shall be calculated to recover the fixed costs of eligible plant additions that have not previously been reflected in the rate base calculation and will have been placed in service between January 1, 2015, and July 31, 2016. Thereafter, the PRISM will be updated semi-annually by tariff advice filing to reflect eligible plant placed in service during the six-month periods ending two months prior to the effective date of each PRISM update.

N

Effective Date
of Change

April 1

October 1

Date to which PRISM-eligible
Plant Additions reflected

January 31

July 31

The fixed costs of eligible PRISM projects will consist of depreciation, return, and taxes (State, Federal and local) plus any correction or adjustment requested and approved by the commission.

Depreciation: The depreciation expense shall be calculated by applying the annual accrual rates determined by the most recently approved or accepted depreciation study to the original cost of PRISM-eligible plant.

Return: The after tax return shall be calculated using the approved capital structure and weighted average cost of capital in the utility's most recent general rate case.

Taxes: The income taxes shall be calculated using the statutory State and Federal income tax rates. Property taxes shall be calculated using the local tax rates currently in effect.

The plant improvement surcharge rate will be expressed as a percentage, carried to two decimal places, that is applied to all classes of service as a percentage of each customer's billed revenue.

The percentage is calculated by dividing the total annual eligible fixed costs (divided by two) by the projected semi-annual revenue.

Pursuant to U-15-089(19)/U-15-091(19)/U-15-092(19) EFFECTIVE: June 16, 2016

ISSUED BY: COLLEGE UTILITIES CORPORATION

BY:

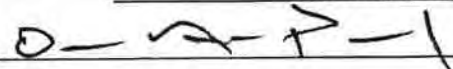

Oran Paul

Title: President

CANCELING

19th REVISION SHEET NO. 26**RECEIVED****AUG 21 2024**STATE OF ALASKA
REGULATORY COMMISSION OF ALASKA

COLLEGE UTILITIES CORPORATION

PLANT REPLACEMENT IMPROVEMENT SURCHARGE MECHANISM

d. Computation: (continued)

Formula: The formula for calculating the plant replacement surcharge percentage is as follows:

$$\text{PRISM} = \frac{((\text{EP} \times \text{WACC}) + \text{Dep} + \text{Taxes} + e)/2}{\text{PSAR}}$$

Where:

EP = the original cost of PRISM eligible plant net of accumulated depreciation. To the extent bonus depreciation is applicable to eligible plant, the Utility will make an adjustment to subtract related ADIT.

WACC = the weighted average cost of capital approved in the utility's most recent general rate case.

Dep = the depreciation expense related to PRISM eligible plant.

Taxes = the state and federal statutory tax rates applied to the equity return, and local property taxes applicable to the PRISM eligible plant.

e = the amount calculated under the annual reconciliation or any correction or adjustment of actual entries used in the calculation of the surcharge rate.

PSAR = the projected semi-annual revenues to be collected from customers.

PRISM WASTEWATER SURCHARGE RATE: The PRISM percentage is 2.35%

I

PURSUANT TO:

TARIFF ADVICE NO: 180-37

EFFECTIVE: 10/10/2024

ISSUED BY: COLLEGE UTILITIES CORPORATION

BY: /s/ Oran Paul

Oran Paul

Title: President

CANCELING

SHEET NO.

RECEIVED**JUN 08 2016**STATE OF ALASKA
REGULATORY COMMISSION OF ALASKA

COLLEGE UTILITIES CORPORATION

PLANT REPLACEMENT IMPROVEMENT SURCHARGE MECHANISM

e. Consumer Protections:

Surcharge Cap: The PRISM rate may not exceed 5.0 percent of the amount billed to customers under the otherwise applicable tariff rates.

Semiannual Reconciliation: The utility will reconcile all plant improvement surcharge revenue to eligible fixed costs on a semiannual basis. Any over or under collection will be included as an eligible fixed cost reduction or increase in the next PRISM rate update following the reconciliation.

Cap reset: The PRISM rate must be reset to zero at the effective date of revised base rates set in a general rate case that incorporates the capital costs previously recovered through the plant improvement surcharge. The surcharge rate may also be reset to zero or another reduced rate that the commission establishes by order, if the commission, based on annual report data or otherwise, finds that the utility's earned rate of return, including surcharge revenues, exceeds the rate of return used to calculate the surcharge rate.

Customer Notice: The utility will notify customers by bill insert before filing periodic revisions of a surcharge rate.

Long-term Infrastructure Improvement Plan: The utility will file a long-term infrastructure improvement plan no less often than every five years. The original plan is included with the initial tariff filing. The updated plan requirements, as described in 3 AAC 52.815(c), will be filed no later than March 31.

Asset Optimization Plan: Within one year after filing the initial long-term infrastructure improvement plan, and annually thereafter by March 31, the utility shall file an asset optimization plan as described in 3 AAC 52.815(d).

Pursuant to U-15-089(19)/U-15-091(19)/U-15-092(19)

EFFECTIVE:

June 16, 2016

ISSUED BY: COLLEGE UTILITIES CORPORATION

BY:



Oran Paul

Title: President